

SURVEY & REMONUMENTATION

MAR 03 1998

KENT COUNTY REMONUMENTATION

LAND CORNER RECORDATION CERTIFICATE
Filing Requirement of Act 74, Mich. P.A. 1970

SECTION

For corners in
KENT COUNTY
(County)

Located In:	Corner Code #
T 5N R 9W	K-11
T R	
T R	
T R	
S T R	
S T R	
S T R	
S T R	

1. Public Land Survey

2. Property Controlling in Section

3. Miscellaneous Property in Sec.

4. Lot No. _____, Recorded Plat _____
5. Private Claims _____

STATE OF MICHIGAN
COUNTY OF KENT
RECEIVED FOR RECORD
97 APR 29 AM 8:20
REG. OF DEEDS
Lucy Spink

9778

Register of Deeds Stamp & File Number

	A	B	C	D	E	F	G	H	I	J	K	L	M
1													
2	6		5		4		3		2				
3													
4	7		8		9		10		11		12		
5													
6	10		17		16		15		14		13		
7													
8	19		20		21		22		23		24		
9													
10	30		29		28		27		26		25		
11													
12	31		32		33		34		35		36		
13													

I, Kirk Breitels, in a field survey on Feb. 5, 1997 do hereby state that under requirements of P.A. 74, Michigan P.A. of 1970, the corner points mentioned in lines 1 and 2 above were in conformance with regulations and rules therefore as required in the current manual of survey instructions of the United States Department of the Interior, Bureau of Land Management or by a decree of a Court of Law and/or that the corner points mentioned in lines 3, 4 and 5 above were in conformance with the rules of the Michigan Board of Land Surveyors or by a Decree of a Court of Law; established, re-established, monumented, recovered, found as expressed below:

NOTE: Not more than 2 corners, all in the same town and range, may be recorded on this certificate.

A. Description of original monument and accessories and/or subsequent restoration:

Date	Surveyor	Monument
1830	GLO	Mullett Set Post Monument
1944	Kent Co. Wit.	VanKooten Solid Iron
1977	LCRC #1132	Bueche Set Kent County Monument
1981	LCRC #2576	Byl Kent County Monument
1994	LCRC #6992	

The position of this corner was previously approved by the Kent County Remonumentation Peer Group, monumented by John C. Bueche on 12/13/81 and was recorded per LCRC #2576

B. Description of corner evidence found and/or method applied in restoring or reestablishing corner:

K-11 Found standard Kent Co. Mon. (Harrison) per witnesses from above LCRC as set by John C. Bueche in place of the 1" Solid Iron in Conc. Mon. he found. Said Solid Iron in Conc. Mon. checks with Kent Co. Wit. and LCRC #1132.

Monument	LCRC #2576	LCRC #6992
Nail & tag 44" Maple	N60°E 51.63'	Nail & tag 48" stump N60°E 51.56'
Nail & tag 38" Maple	N40°E 32.16'	Nail & tag 48" Maple N40°E 32.13'
NE cor. conc. hdwll.	N70°W 51.08'	NE cor. conc. hdwll. N70°W 51.04'
SE cor. conc. hdwll.	S75°W 50.97'	SE cor. conc. hdwll. S75°W 50.97'
S. face of RR rail	N00°E 29.57'	S. face of RR rail N00°E 29.57'

The selected location is accepted by me and is generally accepted by professional surveyors as the best available evidence of the position of the original corner.

C. Description of monument for corner and accessories established to perpetuate locating the position of the corner:

Monument	LCRC #2576	LCRC #6992
K-11 Standard Kent County Monument		
Nail & KC Remon. tag SE side 48" stump	N60°E 51.56'	
Nail & KC Remon. tag E. side 48" Maple	N40°E 32.13'	
NE corner concrete headwall	N70°W 51.04'	
SE corner concrete headwall	S75°W 50.97'	
South face of RR rail fence post	N00°E 29.57'	
Nail & KC Remon. tag W. side P. Pole	S15°E 34.44'	
On C/L blacktop E-W and on fence line to North		

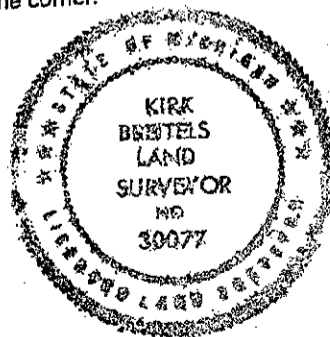

Signed by *Kirk Breitels*
Surveyor's Michigan License No. 30077
P.A. 345 1990 KENT COUNTY

Date 3/27/97

PEER APPROVED 3/27/97
CHAIRMAN *Harry Hubert*