

**SURVEY & REMONUMENTATION**  
 \$7.00  
 \$2.00

FEB 14 1997

COMMISSION

**LAND CORNER RECORDATION CERTIFICATE**  
**Filing Requirement of Act 74, Mich. P.A. 1970**  
**KENT COUNTY REMONUMENTATION**

For corners in

_____ Kent _____ (County)	Located in: Caledonia Township	Corner Code #
1. Public Land Survey	T <u>5N</u> R <u>10W</u>	<u>A-13</u>
	T _____ R _____	_____
	T _____ R _____	_____
	T _____ R _____	_____
2. Property Controlling in Section	S _____ T _____ R _____	_____
	S _____ T _____ R _____	_____
3. Miscellaneous Property in Sec.	S _____ T _____ R _____	_____
	S _____ T _____ R _____	_____

STATE OF MICHIGAN  
 COUNTY OF KENT  
 RECEIVED FOR RECORD  
 96 NOV -8 AM 9:16  
 REG. OF DEEDS  
*Lucy St. Paul*

**9442**

Register of Deeds Stamp & File Number

4. Lot No. \_\_\_\_\_, Recorded Plat \_\_\_\_\_  
 5. Private Claims \_\_\_\_\_

I, Randy Kolehouse, in a field survey on January 24 19 96, do hereby certify that under requirements of P.A. 74 Michigan P.A. of 1970, the corner points mentioned in lines 1 and 2 above were in conformance with regulations and rules therefore as required in the current manual of survey instructions of the United States Department of the Interior, Bureau of Land Management or by a decree of a Court of Law and/or that the corner points mentioned in lines 3, 4 and 5 above were in conformance with the rules of the Michigan Board of Land Surveyors or by a Decree of a Court of Law; established, re-established, monumented, re-monumented, recovered, found as expressed below:

	A	B	C	D	E	F	G	H	I	J	K	L	M
2	6		5		4		3		2		1		
3													
4	7		8		9		10		11		12		
5													
6	18		17		16		15		14		13		
7													
8	19		20		21		22		23		24		
9													
10	30		29		28		27		26		25		
11													
12	31		32		33		34		35		36		
13													

**NOTE: Not more than 4 corners, all in the same town and range, may be recorded on this certificate.**

A. Description of original monument and accessories and/or subsequent restoration:

A-13	1817	G.L.O. Notes	L. Lyon	Set Post	P.A. 345 1990 KENT COUNTY
	1974	L.C.R.C. #639	Exxel Engineering	RR Spike	PEER APPROVED 10/24/96
	1976	L.C.R.C. #3445	Glenn Fauser	RR Spike	CHAIRMAN <i>Harry Rubere</i>
	1983	L.C.R.C. #3211	Williams & Works	Fnd. 80d Nail / Set K.C. Monument	
	1991	L.C.R.C. #5932	William Byl	K.C. Monument	

Note: This corner is common with A-1, T4N, R10W; M-1, T4N, R11W; and M-13, T5N, R11W.

This corner was originally approved by the Kent County Remonumentation Peer Group and monumented by Williams & Works on 3/29/83 and was recorded per L.C.R.C. #3211.

B. Description of corner evidence found and/or method applied in restoring or reestablishing corner:

A-13 Found a Standard Kent County Monument at the C/L intersection of Patterson Avenue (bit.) running North and South and 108th Street (bit.) running East and (gravel) running West per L.C.R.C.'s #3211 and #5932 as set by Williams & Works in place of a 80d nail in pavement they found that checked L.C.R.C. #639.

L.C.R.C. #3211	L.C.R.C. #3445	L.C.R.C. #5932
Nail & KC. Remon. tag oin SW side of Power Pole S 35° E 61.59' (m. 61.55')	Pwr pole N 14° E 114.20' Pwr pole S 42° E 61.55'	Nail & KC Remon. tag SW side Power Pole S 35° E 61.55'
Nail & KC. Remon. tag in W side of Power Pole N 15° E 114.26' (m. 114.20')		Nail & KC Remon. tag W side Power Pole N 15° E 114.19'

The selected location is accepted by me and is generally accepted by professional surveyors as the best available evidence of the position of the original corner.

C. Description of monument for corner and accessories established to perpetuate locating the position of the corner:

A-13 Standard Kent County Monument  
 SW cor. concrete pad to Util. riser S 45° E 51.33'  
 Nail & K.C. remon. tag on N side P. pole S 75° W 197.70'  
 Nail & K.C. remon. tag on W side P. pole N 15° E 114.20'  
 Nail & K.C. remon. tag on SW side P. pole S 35° E 61.55'

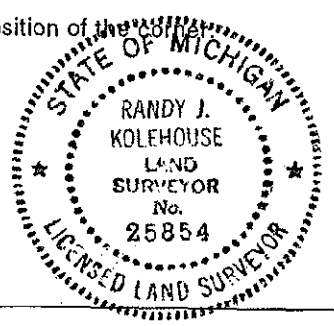

Signed by *Randy J. Kolehouse* Date 10/25/96  
 EARTH TECH

Surveyor's Michigan License No. 25854