

\$7.00
\$2.00

SURVEY &
REMONUMENTATION

KENT COUNTY REMONUMENTATION

SEP 18 1995

LAND CORNER RECORDATION CERTIFICATE

Filing Requirement of Act 74, Mich. P.A. 1970

COMMISSION

For corners in
KENT COUNTY
(County)

Located In:

Corner Code #

| | | | | | |
|---|---|-----------|---|------------|------------|
| 1. Public Land Survey | T | <u>5N</u> | R | <u>10W</u> | <u>B-2</u> |
| | T | _____ | R | _____ | _____ |
| | T | _____ | R | _____ | _____ |
| | T | _____ | R | _____ | _____ |
| 2. Property Controlling in Section | S | _____ | T | _____ | _____ |
| | S | _____ | T | _____ | _____ |
| 3. Miscellaneous Property in Section | S | _____ | T | _____ | _____ |
| | S | _____ | T | _____ | _____ |

STATE OF MICHIGAN
COUNTY OF KENT
RECEIVED FOR RECORD

95 JUL 11 PM 1:53

REG. OF DEEDS
8530

Register of Deeds Stamp & File Number

4. Lot No. _____, Recorded Plat _____
5. Private Claims _____

| A | B | C | D | E | F | G | H | I | J | K | L | M |
|----|----|----|----|----|----|----|---|---|---|---|---|---|
| 2 | 6 | 5 | 4 | 3 | 2 | 1 | | | | | | |
| 3 | | | | | | | | | | | | |
| 4 | 7 | 8 | 9 | 10 | 11 | 12 | | | | | | |
| 5 | | | | | | | | | | | | |
| 6 | 18 | 17 | 16 | 15 | 14 | 13 | | | | | | |
| 7 | | | | | | | | | | | | |
| 8 | 19 | 20 | 21 | 22 | 23 | 24 | | | | | | |
| 9 | | | | | | | | | | | | |
| 10 | 30 | 29 | 28 | 27 | 26 | 25 | | | | | | |
| 11 | | | | | | | | | | | | |
| 12 | 31 | 32 | 33 | 34 | 35 | 36 | | | | | | |
| 13 | | | | | | | | | | | | |

I, Kirk Breitels, in a field survey on June 30, 1995

do hereby certify that under requirements of P.A. 74, Michigan P.A. of 1970, the corner points mentioned in lines 1 and 2 above were in conformance with regulations and rules therefore as required in the current manual of survey instructions of the United States Department of the Interior, Bureau of Land Management or by a decree of a Court of Law and/or that the corner points mentioned in lines 3, 4 and 5 above were in conformance with the rules of the Michigan Board of Professional Surveyors or by a Decree of a Court of Law; established, re-established, monumented, re-monumented, recovered, found as expressed below:

NOTE: Not more than 4 corners, all in the same town and range, may be recorded on this certificate.

A. Description of original monument and accessories and/or subsequent restoration:

| | | | | |
|-----|---------|------------------|--------|-------------------------------------|
| B-2 | 1830 | GLO | | Not Set |
| | | Kent Co. Wit. | | Iron |
| | 1948-50 | Williams & Works | | Set Point |
| | 1954-73 | Williams & Works | | Set & Used Iron at previous "point" |
| | 1973 | LCRC #491 | Spicer | "T" Iron |
| | 1993 | LCRC #6756 | Roon | "T" Iron |

P.A. 345 1990 KENT COUNTY
PEER APPROVED 6/22/95
CHAIRMAN [Signature]

B. Description of corner evidence found and/or method applied in restoring or reestablishing corner:

B-2 Found "T" Iron per LCRC #491 & #6756. Said "T" Iron is 0.3' W & 6.3' N. of true "X" of 1/4 lines. Said "T" Iron has been used in many surveys by various surveyors.

| LCRC #491 | | | LCRC #6756 | | |
|-----------|-------|--------|-------------------------|-------|--------|
| 8" Oak | N60°E | 8.90' | Nail in 22" Beech | S55°W | 21.55' |
| 20" Beech | S45°W | 21.82' | Nail in 18" Ash | N70°E | 8.95' |
| 18" Beech | S05°E | 50.88' | Nail & tag in 6" Elm | S70°E | 9.89' |
| 1" Iron | East | 6.8' | Nail & tag in 16" Apple | N60°W | 6.98' |
| 1" Iron | South | 7.1' | 1" Iron | South | 7.1' |
| | | | 1" Iron | East | 6.8' |

The "T" Iron is accepted by me and is generally accepted by professional surveyors as the best available evidence of the position of the corner.

C. Description of monument for corner and accessories established to perpetuate locating the position of the corner:

- B-2 Set Standard Kent County Monument in place of "T" Iron.
- Set Nail & KC Remon. tag S. side 22" Oak N70°E 8.93'
 - Set Nail & KC Remon. tag S. side 10" Oak S70°E 9.84'
 - Fd. Nail & MDOT tag SW side 16" Apple N60°W 7.06'
 - Set Nail & KC Remon. tag W. side 10" Oak S25°E 19.62'
 - Set Nail & KC Remon. tag NW side 27" Beech S45°W 21.64'
 - Iron Pipe - East 6.79'
 - Solid Iron - South 7.10'

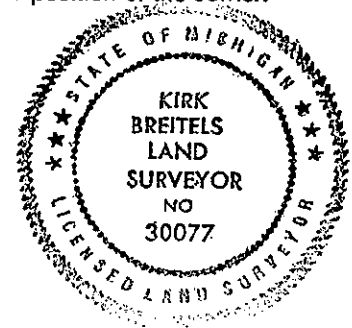

Signed by [Signature]

Date 7/6/95

Surveyor's Michigan License No. 30077