

SURVEY & REMONUMENTATION

FEB 14 1997

KENT COUNTY REMONUMENTATION

COMMISSION

LAND CORNER RECORDATION CERTIFICATE
Filing Requirement of Act 74, Mich. P.A. 1970

STATE OF MICHIGAN
COUNTY OF KENT
RECEIVED FOR RECORD
96 MAR 20 AM 8:48
REG. OF DEEDS
Lucy Bond

For corners in
KENT COUNTY

Located In:	Corner Code #
T 5N R 10W	E-1
T R	
T R	
T R	
T R	
S T R	
S T R	
S T R	
S T R	

9013

Register of Deeds Stamp & File Number

1. Public Land Survey

2. Property Controlling in Section

3. Miscellaneous Property in Sec.

4. Lot No. _____, Recorded Plat _____

5. Private Claims _____

I, Kirk Breitels, in a field survey on Feb. 14, 1996 do hereby state that under requirements of P.A. 74, Michigan P.A. of 1970, the corner points mentioned in lines 1 and 2 above were in conformance with regulations and rules therefore as required in the current manual of survey instructions of the United States Department of the Interior, Bureau of Land Management or by a decree of a Court of Law and/or that the corner points mentioned in lines 3, 4 and 5 above were in conformance with the rules of the Michigan Board of Land Surveyors or by a Decree of a Court of Law; established, re-established, monumented, recovered, found as expressed below:

NOTE: Not more than 2 corners, all in the same town and range, may be recorded on this certificate.

	A	B	C	D	E	F	G	H	I	J	K	L	M
1													
2	6			5		4		3		2		1	
3													
4	7			8		9		10		11		12	
5													
6	18			17		16		15		14		13	
7													
8	19			20		21		22		23		24	
9													
10	30			29		28		27		26		25	
11													
12	31			32		33		34		35		36	
13													

A. Description of original monument and accessories and/or subsequent restoration:

E-1	1830	GLO	Mullett	Set Post
		Kent Co. Wit.		3/4" Iron
	1977	LCRC #1085	VanKooten	Iron
	1984	LCRC #3820	Chettleburgh	Set Kent County Monument
	1994	LCRC #7078	Bueche	Kent County Monument

P.A. 345 1990 KENT COUNTY

PEER APPROVED 3/7/96

CHAIRMAN *Thomas Bueche*

The position of this corner was previously approved by the Kent County Remonumentation Peer Group, monumented by Thomas Chettleburgh on 4/30/84 and was recorded per LCRC #3820

B. Description of corner evidence found and/or method applied in restoring or reestablishing corner:

E-1 Found standard Kent Co. Mon. (Harrison) per witnesses from above LCRC as set by Thomas Chettleburgh on Twp. Line in place of the Iron Pipe he found. Said Iron Pipe checks with Kent Co. Wit. and LCRC #1085.

LCRC #3820	LCRC #7078
Nail 7" Twin Maple	N12°E 25.59'
Nail 28" W. Cherry	N76°E 111.12'
Nail 36" Maple	S69°E 82.76'
Nail 8" Elm	S15°W 31.50'
KC Mon. (E-13, 6-10) East	52.89'

The selected location is accepted by me and is generally accepted by professional surveyors as the best available evidence of the position of the original corner.

C. Description of monument for corner and accessories established to perpetuate locating the position of the corner:

E-1 Standard Kent County Monument			
Nail & KC Remon. tag SE side dbl. 10" Maple	N12°E	25.59'	
Nail & KC Remon. tag SW side 30" W. Cherry	N76°E	111.12'	
Nail & KC Remon. tag SW side 38" Maple	S69°E	82.76'	
Nail & KC Remon. tag W. side 10" Elm	S15°W	31.50'	
Kent Co. Mon. (E-13, T6N, R10W)	East	52.89'	
On C/L E-W bit road			

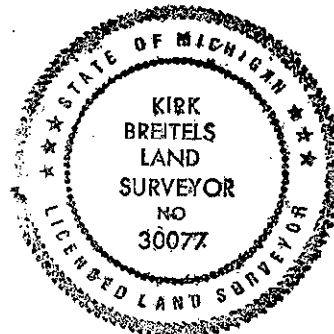

Signed by *Kirk Breitels*

Date 3/1/96

Surveyor's Michigan License No. 30077