

FEB 14 1997

COMMISSION

KENT COUNTY REMONUMENTATION

LAND CORNER RECORDATION CERTIFICATE
Filing Requirement of Act 74, Mich. P.A. 1970

REG. OF DEEDS

Handwritten signature

96 MAR 20 AM 8:48

STATE OF MICHIGAN
COUNTY OF KENT
RECEIVED FOR RECORD

For corners in
KENT COUNTY

Located in:

Corner Code #

1. Public Land Survey	T	5N	R	10W	F-1
	T		R		
	T		R		
	T		R		
2. Property Controlling in Section	S		T	R	
	S		T	R	
3. Miscellaneous Property in Sec.	S		T	R	
	S		T	R	

9014

Register of Deeds Stamp & File Number

4. Lot No. _____, Recorded Plat _____
5. Private Claims _____

I, Kirk Breitels, in a field survey on Feb. 20, 1996 do hereby state that under requirements of P.A. 74, Michigan P.A. of 1970, the corner points mentioned in lines 1 and 2 above were in conformance with regulations and rules therefore as required in the current manual of survey instructions of the United States Department of the Interior, Bureau of Land Management or by a decree of a Court of Law and /or that the corner points mentioned in lines 3, 4 and 5 above were in conformance with the rules of the Michigan Board of Land Surveyors or by a Decree of a Court of Law; established, re-established, monumented, recovered, found as expressed below:

NOTE: Not more than 2 corners, all in the same town and range, may be recorded on this certificate.

A	B	C	D	E	F	G	H	I	J	K	L	M
1												
2	6		5		4		3		2		1	
3												
4	7		8		9		10		11		12	
5												
6	10		17		16		15		14		13	
7												
8	19		20		21		22		23		24	
9												
10	30		29		28		27		26		25	
11												
12	31		32		33		34		35		36	
13												

A. Description of original monument and accessories and/or subsequent restoration:

F-1	1830	GLO	Mullett	Not Set
	1964	Kent Co. Wit.		1" Iron
	1973	LCRC #498	Spicer	1" Iron
	1984	LCRC #3821	Chettleburgh	Set Kent County Monument
	1994	LCRC #7079	Bueche	Kent County Monument

P.A. 345 1990 KENT COUNTY
PEER APPROVED 3/7/96
CHAIRMAN *Handwritten signature*

The position of this corner was previously approved by the Kent County Remonumentation Peer Group, monumented by Thomas Chettleburgh on 4/30/84 and was recorded per LCRC #3821

B. Description of corner evidence found and/or method applied in restoring or reestablishing corner:
F-1 Found standard Kent Co. Mon. (Harrison) per witnesses from above LCRC as set by Thomas Chettleburgh on Twp. Line in place of the Iron Pipe he found. Said Iron Pipe checks with Kent Co. Wit. and LCRC #498.

<u>LCRC #3821</u>	Nail in P. Pole	S33°E 65.93'	same witnesses as LCRC #3821
	Nail in 13" Hickory	S05°E 36.01'	
	Nail in 26" Hickory	S50°W 41.32'	
	Nail in P. Pole	N10°W 33.26'	
	KC Mon. (F-13, 6-10) East	73.06'	

The selected location is accepted by me and is generally accepted by professional surveyors as the best available evidence of the position of the corner.

C. Description of monument for corner and accessories established to perpetuate locating the position of the corner:

F-1 Standard Kent County Monument			
Nail & KC Remon. tag SW side P. Pole	S33°E	65.97'	
Nail & KC Remon. tag W. side 16" Hickory	S05°E	36.01'	
Nail & KC Remon. tag NW side 30" Hickory	S50°W	41.36'	
Nail & KC Remon. tag W. side P. Pole	N10°W	33.38'	
Kent Co. Mon. (F-13, T6N, R10)	East	73.15'	

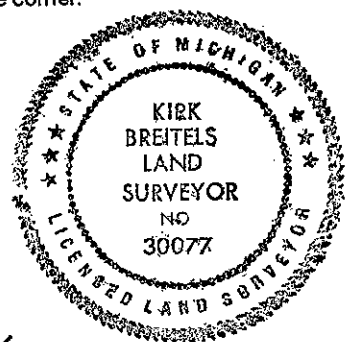

Signed by *Kirk Breitels*
Surveyor's Michigan License No. 30077

Date 3/1/96