

SURVEY & REMONUMENTATION

KENT COUNTY REMONUMENTATION

FEB 14 1997

LAND CORNER RECORDATION CERTIFICATE
Filing Requirement of Act 74, Mich. P.A. 1970

COMMISSION

For corners in
KENT COUNTY

Located In:	Corner Code #
T 5N R 10W	K-1
T R	
T R	
T R	
S T R	
S T R	
S T R	
S T R	

STATE OF MICHIGAN
COUNTY OF KENT
RECEIVED FOR RECORD
96 MAR 20 AM 8:48
REG. OF DEEDS
W. J. Bond
9017
Register of Deeds Stamp & File Number

1. Public Land Survey

2. Property Controlling In Section

3. Miscellaneous Property in Sec.

4. Lot No. _____, Recorded Plat _____

5. Private Claims _____

I, Kirk Breitels, in a field survey on Feb. 8, 1996 do hereby state that under requirements of P.A. 74, Michigan P.A. of 1970, the corner points mentioned in lines 1 and 2 above were in conformance with regulations and rules therefore as required in the current manual of survey instructions of the United States Department of the Interior, Bureau of Land Management or by a decree of a Court of Law and /or that the corner points mentioned in lines 3, 4 and 5 above were in conformance with the rules of the Michigan Board of Land Surveyors or by a Decree of a Court of Law; established, re-established, monumented, recovered, found as expressed below:

NOTE: Not more than 2 corners, all in the same town and range, may be recorded on this certificate.

A	B	C	D	E	F	G	H	I	J	K	L	M
1												
2	6	5	4	3	2	1						
3												
4	7	8	9	10	11	12						
5												
6	18	17	16	15	14	13						
7												
8	19	20	21	22	23	24						
9												
10	30	29	28	27	26	25						
11												
12	31	32	33	34	35	36						
13												

A. Description of original monument and accessories and/or subsequent restoration:

K-1	1830	GLO	Mullett	Set Post
	1973	LCRC #487	Spicer	3/4" Iron
	1984	LCRC #3824	Chettleburgh	Set Kent County Monument
	1991	LCRC #6050	Unema	Kent County Monument

P.A. 345 1990 KENT COUNTY

PEER APPROVED 3/7/96

CHAIRMAN *Harry Huber*

The position of this corner was previously approved by the Kent County Remonumentation Peer Group, monumented by Thomas Chettleburgh on 4/30/84 and was recorded per LCRC #3824

B. Description of corner evidence found and/or method applied in restoring or reestablishing corner:

K-1 Found standard Kent Co. Mon. (Harrison) per witnesses from above LCRC as set by Thomas Chettleburgh on Twp. Line in place of the PK Nail over a 3/8" Iron Pipe he found. Both PK Nail & Iron Pipe check with LCRC #487.

LCRC #3824

- Nail in 35" Maple N15°E 31.54' Nail in 14" Elm S58°W 57.14'
- Nail in 31" Maple N61°E 62.55' Kent Co. Mon. East 30.41'
- Nail in 20" Maple S70°E 74.53'
- Nail in 23" Maple N63°W 82.20'
- Nail in 29" Oak S16°W 18.87'

LCRC #6050

Witnesses same ± as LCRC #3824

The selected location is accepted by me and is generally accepted by professional surveyors as the best available evidence of the position of the original corner.

C. Description of monument for corner and accessories established to perpetuate locating the position of the corner.

K-1 Standard Kent County Monument

Nail & KC Remon. tag S. side	28"	Oak	N60°W	82.28'
Nail & KC Remon. tag NW side	36"	Maple	N62°E	62.56'
Nail & KC Remon. tag W. side	38"	Maple	N17°E	31.55'
Nail & KC Remon. tag NW side	32"	Oak	S16°W	18.89'
Nail & KC Remon. tag NW side	18"	Elm	S58°W	57.24'
Kent Co. Mon. (K-13, T6N, R10W)			East	30.42'
C/L E-W blacktop road is South	4.6'±			

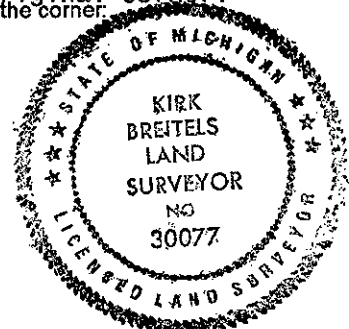

Signed by *Kirk Breitels*

Date 3/1/96

Surveyor's Michigan License No. 30077