

**SURVEY & MONUMENTATION**

\$7.00  
\$2.00

JAN 23 1996

**LAND CORNER RECORDATION CERTIFICATE**  
Filing Requirement of Act 74, Mich. P.A. 1970  
KENT COUNTY REMONUMENTATION

For corners in

**COMMISSION**

STATE OF MICHIGAN  
COUNTY OF KENT  
RECEIVED FOR RECORD  
95 DEC 20 PM 2:20  
REG. OF DEEDS  
*Lucy Stand*

Kent (County)	Located in:	Corner Code #
1. Public Land Survey	T <u>5N</u> R <u>11W</u>	<u>B-2</u>
	T _____ R _____	_____
	T _____ R _____	_____
	T _____ R _____	_____
2. Property Controlling in Section	S _____ T _____ R _____	_____
	S _____ T _____ R _____	_____
3. Miscellaneous Property in Sec.	S _____ T _____ R _____	_____
	S _____ T _____ R _____	_____

8899

Register of Deeds Stamp & File Number

4. Lot No. \_\_\_\_\_, Recorded Plat \_\_\_\_\_  
5. Private Claims \_\_\_\_\_

	A	B	C	D	E	F	G	H	I	J	K	L	M
2	6		5		4		3		2		1		
3													
4	7		8		9		10		11		12		
5													
6	18		17		16		15		14		13		
7													
8	19		20		21		22		23		24		
9													
10	30		29		28		27		26		25		
11													
12	31		32		33		34		35		36		
13													

I, Randy Kolehouse, in a field survey on May 13 19 95, do hereby certify that under requirements of P.A. 74 Michigan P.A. of 1970, the corner points mentioned in lines 1 and 2 above were in conformance with regulations and rules therefore as required in the current manual of survey instructions of the United States Department of the interior, Bureau of Land Management or by a decree of a Court of Law and/or that the corner points mentioned in lines 3, 4 and 5 above were in conformance with the rules of the Michigan Board of Land Surveyors or by a Decree of a Court of Law; established, re-established, monumented, re-monumented, recovered, found as expressed below:

**NOTE: Not more than 4 corners, all in the same town and range, may be recorded on this certificate.**

A. Description of original monument and accessories and/or subsequent restoration:

B-2 This corner was not originally set by the G.L.O.

1901-1973	Survey Notes	Williams & Works	Set at Int. of Fence Lines
1973	L.C.R.C. #586	Williams & Works	Found 1" Iron by Wit. Map
1976	L.C.R.C. #866	McCloskey	Iron
1977	L.C.R.C. #1645	McCloskey	Found 1 1/4" Iron Pipe by Old Witnesses

B. Description of corner evidence found and/or method applied in restoring or reestablishing corner:

B-2 Found concrete monument per Williams & Works L.C.R.C. #586 to be 1.6' West and 3.2' South of true Center of Section. This monument was also used by Exxel Engineering for Center of Section and can be traced back to 1909 in Williams & Works Survey Notes. Accepted concrete monument as Center of Section.

L.C.R.C. #586

12" Walnut S85°E 57.00'

P.A. 345 1990 KENT COUNTY  
PEER APPROVED 10/26/95  
CHAIRMAN Harry J. Huber

C. Description of monument for corner and accessories established to perpetuate locating the position of the corner:

B-2 Placed Standard Plastic K.C. Cap on Found Concrete Monument (Plat Corner).

- Nail w/cap 14" Cherry NNE 78.66'
- Nail in S side 12" Quad. Walnut E 57.04'
- Form Nail in S side 24" Ash West 91.28'
- 50" stump North 114.5'

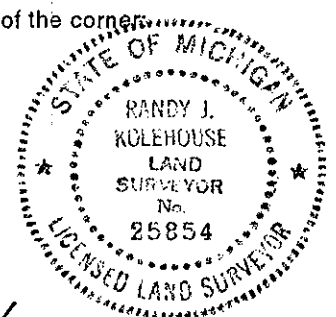

Signed by Randy J. Kolehouse Date 12/22/95  
EARTH TECH

Surveyor's Michigan License No. 25854