

\$7.00
\$2.00

KENT COUNTY
REMONUMENTATION

JAN 23 1996
COMMISSION

LAND CORNER RECORDATION CERTIFICATE
Filing Requirement of Act 74, Mich. P.A. 1970
KENT COUNTY REMONUMENTATION

For corners in Kent (County) Located in: Corner Code #

1. Public Land Survey	T <u>5N</u> R <u>11W</u>	<u>J-10</u>
	T _____ R _____	_____
	T _____ R _____	_____
	T _____ R _____	_____
2. Property Controlling in Section	S _____ T _____ R _____	_____
	S _____ T _____ R _____	_____
3. Miscellaneous Property in Sec.	S _____ T _____ R _____	_____
	S _____ T _____ R _____	_____

4. Lot No. _____, Recorded Plat _____

5. Private Claims _____

STATE OF MICHIGAN
COUNTY OF KENT
RECEIVED FOR RECORD

95 DEC 28 PM 2:22

REG. OF DEEDS
Lucy Bond
8919

Register of Deeds Stamp & File Number

I, Randy Kolehouse, in a field survey on October 6 19 95, do hereby certify that under requirements of P.A. 74 Michigan P.A. of 1970, the corner points mentioned in lines 1 and 2 above were in conformance with regulations and rules therefore as required in the current manual of survey instructions of the United States Department of the interior, Bureau of Land Management or by a decree of a Court of Law and/or that the corner points mentioned in lines 3, 4 and 5 above were in conformance with the rules of the Michigan Board of Land Surveyors or by a Decree of a Court of Law; established, re-established, monumented, re-monumented, recovered, found as expressed below:

A	B	C	D	E	F	G	H	I	J	K	L	M
2	6	5	4	3	2	1						
3												
4	7	8	9	10	11	12						
5												
6	16	17	16	15	14	13						
7												
8	19	20	21	22	23	24						
9												
10	30	29	28	27	26	25						
11												
12	31	32	33	34	35	36						
13												

NOTE: Not more than 4 corners, all in the same town and range, may be recorded on this certificate.

A. Description of original monument and accessories and/or subsequent restoration:

J-10 This corner was not originally set by the G.L.O.

1991 Survey Records Exxel Engineering Used Calc. Center

No other information on record.

P.A. 345 1990 KENT COUNTY
PEER APPROVED 10/26/95
CHAIRMAN *Randy Kolehouse*

B. Description of corner evidence found and/or method applied in restoring or reestablishing corner:

J-10 Calculated the intersection of 1/4 corners and find it to check the calculated position shown by Exxel Engineering notes within 0.20'. Set Kent County Monument at intersection of 1/4 lines.

C. Description of monument for corner and accessories established to perpetuate locating the position of the corner:

J-10 Set a Standard 4" x 30" Kent County Monument.

- Nail & K.C. remon. tag in W side 28" Cherry N 06° E 54.02'
- Nail & K.C. remon. tag in E side 28" Cherry South 37.28'
- Nail & K.C. remon. tag in NW side 10" Walnut S 46° W 17.38'
- Nail & K.C. remon. tag in NE side 14" Cherry N 40° W 33.91'
- Nail & K.C. remon. tag in E side Trip. 10" Maple N 16° W 26.47'

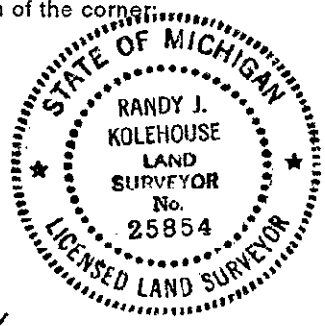

Signed by *Randy J. Kolehouse* Date 12/22/95
EARTH TECH

Surveyor's Michigan License No. 25854