

**SURVEY & REMONUMENTATION**

FEB 14 1997

COMMISSION

KENT COUNTY REMONUMENTATION

**LAND CORNER RECORDATION CERTIFICATE**  
Filing Requirement of Act 74, Mich. P.A. 1970

For corners in  
**KENT COUNTY**  
(County)

Located In:	Corner Code #
T 6N R 10W	M 3
T 6N R 9W	A-3
T R	
T R	
S T R	
S T R	
S T R	
S T R	

- Public Land Survey
- Property Controlling in Section
- Miscellaneous Property in Sec.

STATE OF MICHIGAN  
COUNTY OF KENT  
RECEIVED FOR RECORD  
96 MAR 20 AM 8:47  
REG. OF DEEDS  
*Lucy Grand*

**9002**  
Register of Deeds Stamp & File Number

- Lot No. \_\_\_\_\_, Recorded Plat \_\_\_\_\_
- Private Claims \_\_\_\_\_

I, Kirk Breitels, in a field survey on Feb. 22, 1996 do hereby state that under requirements of P.A. 74, Michigan P.A. of 1970, the corner points mentioned in lines 1 and 2 above were in conformance with regulations and rules therefore as required in the current manual of survey instructions of the United States Department of the Interior, Bureau of Land Management or by a decree of a Court of Law and/or that the corner points mentioned in lines 3, 4 and 5 above were in conformance with the rules of the Michigan Board of Land Surveyors or by a Decree of a Court of Law; established, re-established, monumented, recovered, found as expressed below:

	A	B	C	D	E	F	G	H	I	J	K	L	M
1													
2	6		5		4		3		2		1		
3													
4	7		8		9		10		11		12		
5													
6	18		17		16		15		14		13		
7													
8	19		20		21		22		23		24		
9													
10	30		29		28		27		26		25		
11													
12	31		32		33		34		35		36		
13													

NOTE: Not more than 2 corners, all in the same town and range, may be recorded on this certificate.

A. Description of original monument and accessories and/or subsequent restoration:

M-3	1831	GLO	Mullett	Set Post
	1971	LCRC #46	Chambers	Iron
	1977	LCRC #1015	McCombs	"T" Iron
	1981	LCRC #1604	Merdzinski	Set Kent County Monument
	1991	LCRC #6060	Unema	Kent County Monument

P.A. 345 1990 KENT COUNTY  
PEER APPROVED 3/7/96  
CHAIRMAN *Harry Huber*

The position of this corner was previously approved by the Kent County Remonumentation Peer Group, monumented by John A. Merdzinski on 1/27/81 and was recorded per LCRC #1604

B. Description of corner evidence found and/or method applied in restoring or reestablishing corner:

M-3 Found standard Kent Co. Mon. (Harrison) per witnesses from above LCRC as set by John A. Merdzinski in place of the "T" Iron he found. Said "T" Iron checks with LCRC's #46 and #1015.

LCRC #1604 (Nail/tag in trees)	LCRC #6060
32" Oak North 94.53' 18" Oak N20°W 139.77'	Nail/tag 34" Oak N04°E 94.46'
Face wood fence post South 6.09'	Nail/tag 24" Oak N19°W 152.14'
SE cor. gar. fnd. N50°W 271.10'	Nail/tag 8" Locust East 23.48'
NE cor. hse. fnd. S70°W 229.73'	Nail/tag 6" Tri. Locust S19°W 45.44'
NE cor. gar. fnd. S15°W 237.97'	E. edge B.T. drive West 22.3'

The selected location is accepted by me and is generally accepted by professional surveyors as the best available evidence of the position of the original corner.

C. Description of monument for corner and accessories established to perpetuate locating the position of the corner:

M-3 Standard Kent County Monument	N04°E	94.41'
Nail & KC Remon. tag E. side 36" Oak	N19°W	152.14'
Nail & KC Remon. tag E. side 26" Oak	East	23.50'
Nail & KC Remon. tag S. side 10" Locust	S19°W	45.41'
Nail & KC Remon. tag E. side 8" Tri. Locust	N50°W	270.96'
SE corner garage foundation (EDM Meas.)	S70°W	229.55'
NE corner house foundation (EDM Meas.)	S15°W	237.77'
NE corner garage foundation (EDM Meas.)	West	22.3'
E. edge blacktop drive to Hse. #9590		
C/L Fulton St. - North 140'±		

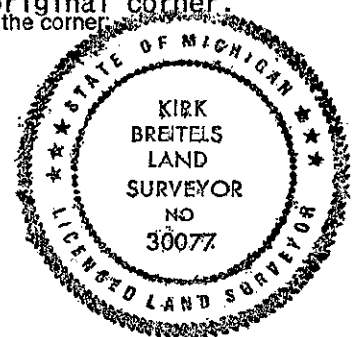

Signed by Kirk Breitels  
Surveyor's Michigan License No. 30077

Date 3/1/96