

SURVEY & REMONUMENTATION

MAR 03 1998

KENT COUNTY REMONUMENTATION

SECTION

LAND CORNER RECORDATION CERTIFICATE
Filing Requirement of Act 74, Mich. P.A. 1970

For corners in

KENT COUNTY

(County)

Located In:

Corner Code #

- | | | |
|------------------------------------|--|-------|
| 1. Public Land Survey | T <u>6N</u> R <u>9W</u> | D-13 |
| | T <u> </u> R <u> </u> | _____ |
| | T <u> </u> R <u> </u> | _____ |
| | T <u> </u> R <u> </u> | _____ |
| 2. Property Controlling in Section | S <u> </u> T <u> </u> R <u> </u> | _____ |
| | S <u> </u> T <u> </u> R <u> </u> | _____ |
| 3. Miscellaneous Property in Sec. | S <u> </u> T <u> </u> R <u> </u> | _____ |
| | S <u> </u> T <u> </u> R <u> </u> | _____ |

STATE OF MICHIGAN
COUNTY OF KENT
RECEIVED FOR RECORD
97 APR 29 AM 8:21
REG. OF DEEDS
Lucy J. Bond

9816

Register of Deeds Stamp & File Number

4. Lot No. _____, Recorded Plat _____
5. Private Claims _____

I, Kirk Breitels, in a field survey on Jan. 21, 1997 do hereby state that under requirements of P.A. 74, Michigan P.A. of 1970, the corner points mentioned in lines 1 and 2 above were in conformance with regulations and rules therefore as required in the current manual of survey instructions of the United States Department of the Interior, Bureau of Land Management or by a decree of a Court of Law and/or that the corner points mentioned in lines 3, 4 and 5 above were in conformance with the rules of the Michigan Board of Land Surveyors or by a Decree of a Court of Law; established, re-established, monumented, recovered, found as expressed below:

| | | | | | | | | | | | | |
|----|----|----|----|----|----|----|---|---|---|---|---|---|
| A | B | C | D | E | F | G | H | I | J | K | L | M |
| 1 | | | | | | | | | | | | |
| 2 | 6 | 5 | 4 | 3 | 2 | 1 | | | | | | |
| 3 | | | | | | | | | | | | |
| 4 | 7 | 8 | 9 | 10 | 11 | 12 | | | | | | |
| 5 | | | | | | | | | | | | |
| 6 | 18 | 17 | 16 | 15 | 14 | 13 | | | | | | |
| 7 | | | | | | | | | | | | |
| 8 | 19 | 20 | 21 | 22 | 23 | 24 | | | | | | |
| 9 | | | | | | | | | | | | |
| 10 | 30 | 29 | 28 | 27 | 26 | 25 | | | | | | |
| 11 | | | | | | | | | | | | |
| 12 | 31 | 32 | 33 | 34 | 35 | 36 | | | | | | |
| 13 | | | | | | | | | | | | |

NOTE: Not more than 2 corners, all in the same town and range, may be recorded on this certificate.

A. Description of original monument and accessories and/or subsequent restoration:

D-13 1830 GLO Mullett Set Post
1996 LCRC #9598 Jonker Set Kent County Monument

The position of this corner was previously approved by the Kent County Remonumentation Peer Group, monumented by Robert J. Jonker on 12-6-96 and was recorded per LCRC #9598

B. Description of corner evidence found and/or method applied in restoring or reestablishing corner:

D-13 Found standard Kent Co. Mon. (Harrison) per witnesses from above LCRC as set by Robert J. Jonker in place of the "T" Iron he found.

LCRC #9598

Nail & KC Remon. tag E. side 20" Walnut N33°W 28.80'
Nail & KC Remon. tag W. side 18" Cherry S00°E 30.39'
Nail & KC Remon. tag NW side 15" Maple N48°W 31.52'
Nail & KC Remon. tag SE side 24" Maple S73°E 100.09'
Bowne Twp. corner East 80.08'

The selected location is accepted by me and is generally accepted by professional surveyors as the best available evidence of the position of the original corner.

C. Description of monument for corner and accessories established to perpetuate locating the position of the corner:

D-13 Standard Kent County Monument

Nail & KC Remon. tag E. side 22" Walnut N33°W 28.80'
Nail & KC Remon. tag W. side 18" Cherry S00°E 30.34'
Nail & KC Remon. tag NW side 18" Maple N48°E 31.52'
Nail & KC Remon. tag NE side 26" Maple S73°E 100.09'
D-1, Bowne Twp. corner (Kent Co. Mon.) East 80.00'

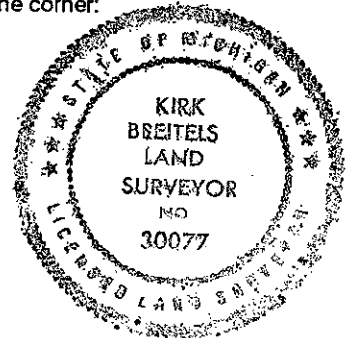

Signed by *Kirk Breitels*
Surveyor's Michigan License No. 30077

Date 3/27/97

P.A. 345 1990 KENT COUNTY

PEER APPROVED 3/27/97

CHAIRMAN *Harry Huber*

FORM APPROVED BY MICHIGAN STATE BOARD OF PROFESSIONAL SURVEYORS, JAN. 28, 1971
REVISED MAY 14, 1975
REVISED JAN., 1983
REVISED OCT., 1995