

**SURVEY &  
REMONUMENTATION**

MAR 03 1998

**SECTION KENT COUNTY REMONUMENTATION**

**LAND CORNER RECORDATION CERTIFICATE  
Filing Requirement of Act 74, Mich. P.A. 1970**

For corners in

KENT COUNTY

(County)

Located In:

Corner Code #

1. Public Land Survey	T <u>6</u> N	R <u>9</u> W	E-12
	T <u>   </u>	R <u>   </u>	<u>   </u>
	T <u>   </u>	R <u>   </u>	<u>   </u>
	T <u>   </u>	R <u>   </u>	<u>   </u>
2. Property Controlling in Section	S <u>   </u>	T <u>   </u>	R <u>   </u>
	S <u>   </u>	T <u>   </u>	R <u>   </u>
3. Miscellaneous Property in Sec.	S <u>   </u>	T <u>   </u>	R <u>   </u>
	S <u>   </u>	T <u>   </u>	R <u>   </u>

REG. OF DEEDS

*David J. Bond*

97 JUN -3 AM 8:11

STATE OF MICHIGAN  
COUNTY OF KENT  
RECEIVED FOR RECORD

9992

Register of Deeds Stamp & File Number

4. Lot No. \_\_\_\_\_, Recorded Plat \_\_\_\_\_  
5. Private Claims \_\_\_\_\_

I, Kirk Breitels, in a field survey on Apr. 24, 1997 do hereby state that under requirements of P.A. 74, Michigan P.A. of 1970, the corner points mentioned in lines 1 and 2 above were in conformance with regulations and rules therefore as required in the current manual of survey instructions of the United States Department of the Interior, Bureau of Land Management or by a decree of a Court of Law and /or that the corner points mentioned in lines 3, 4 and 5 above were in conformance with the rules of the Michigan Board of Land Surveyors or by a Decree of a Court of Law; established, re-established, monumented, recovered, found as expressed below:

NOTE: Not more than 2 corners, all in the same town and range, may be recorded on this certificate.

A	B	C	D	E	F	G	H	I	J	K	L	M
1												
2	6	5	4	3	2	1						
3												
4	7	8	9	10	11	12						
5												
6	10	17	16	15	14	13						
7												
8	19	20	21	22	23	24						
9												
10	30	29	28	27	26	25						
11												
12	31	32	33	34	35	36						
13												

A. Description of original monument and accessories and/or subsequent restoration:

E-12	1830	GLO	Mullett	Set Post
	1944	Kent Co. Wit.		1" Iron
	1983	LCRC #3661	Bonnema	Set Re-rod over Iron
	1984	LCRC #4065	Jonker	Set Kent County Monument
	1995	LCRC #8201	Breitels	Kent County Monument

The position of this corner was previously approved by the Kent County Remonumentation Peer Group, monumented by Robert J. Jonker on 2/10/84 and was recorded per LCRC #4065

B. Description of corner evidence found and/or method applied in restoring or reestablishing corner:

E-12 Found standard Kent Co. Mon. (Harrison) per witnesses from above LCRC as set by Robert J. Jonker in place of the Capped Re-rod (Exxel) he found. Said Re-rod checks with Kent Co. Wit. and LCRC #3661.

LCRC #4065

LCRC #8201

Remon. tag 12" Sassafras	S38°W	29.27'	Nail & tag 12" Sassafras	S38°W	29.27'
Remon. tag 12" Hickory	S39°E	47.38'	Nail & tag 14" Maple	S83°E	50.30'
Remon. tag 14" Maple	S83°E	50.30'	Nail & tag 16" Hickory	N63°E	69.95'
Remon. tag 16" Hickory	N63°E	69.95'	Nail & tag 22" Oak	N85°W	7.49'
Remon. tag 8" Oak	N59°W	47.03'	Nail & tag 12" Oak	S25°E	47.30'
			Capped Re-rod	S90°E	32.93'

The selected location is accepted by me and is generally accepted by professional surveyors as the best available evidence of the position of the original corner.

C. Description of monument for corner and accessories established to perpetuate locating the position of the corner:

E-12 Standard Kent County Monument

Nail & KC Remon. tag E. side 14"	Sassafras	S38°W	29.27'
Nail & KC Remon. tag N. side 16"	Maple	S83°E	50.46'
Nail & KC Remon. tag SE side 18"	Hickory	N63°E	69.67'
Nail & KC Remon. tag S. side 24"	Oak	N85°W	7.49'
Nail & KC Remon. tag SW side 14"	Poplar	S25°E	47.30'
Exxel Eng. Co. Capped Iron		S90°E	33.04'
C/L N-S gravel road is East 6' ±			

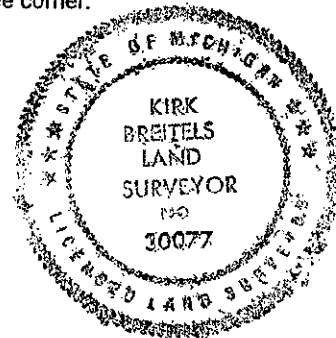

Signed by *Kirk Breitels*  
Surveyor's Michigan License No. 30077

Date 5/22/97

P.A. 345 1990 KENT COUNTY

PEER APPROVED 5/22/97  
CHAIRMAN *Harry Hupner*