

SURVEY & REMONUMENTATION

MAR 03 1998

KENT COUNTY REMONUMENTATION

SECTION

LAND CORNER RECORDATION CERTIFICATE
Filing Requirement of Act 74, Mich. P.A. 1970

For corners in
KENT COUNTY

Located In: Corner Code #

(County)	Located In:	Corner Code #
1. Public Land Survey	T 6N R 9W	F-4
	T R	
	T R	
	T R	
	T R	
2. Property Controlling in Section	S T R	
	S T R	
3. Miscellaneous Property in Sec.	S T R	
	S T R	

STATE OF MICHIGAN
COUNTY OF KENT
RECEIVED FOR RECORD

97 OCT 14 AM 10:00

REG. OF DEEDS

Eric J. Bond

10038

Register of Deeds Stamp & File Number

4. Lot No. _____, Recorded Plat _____
5. Private Claims _____

I, Kirk Breitels, in a field survey on June 17 97, 19__ do hereby state that under requirements of P.A. 74, Michigan P.A. of 1970, the corner points mentioned in lines 1 and 2 above were in conformance with regulations and rules therefore as required in the current manual of survey instructions of the United States Department of the Interior, Bureau of Land Management or by a decree of a Court of Law and /or that the corner points mentioned in lines 3, 4 and 5 above were in conformance with the rules of the Michigan Board of Land Surveyors or by a Decree of a Court of Law; established, re-established, monumented, recovered, found as expressed below:

NOTE: Not more than 2 corners, all in the same town and range, may be recorded on this certificate.

	A	B	C	D	E	F	G	H	I	J	K	L	M
1													
2	6		5		4		3		2		1		
3													
4	7		8		9		10		11		12		
5													
6	18		17		16		15		14		13		
7													
8	19		20		21		22		23		24		
9													
10	30		29		28		27		26		25		
11													
12	31		32		33		34		35		36		
13													

A. Description of original monument and accessories and/or subsequent restoration:

- F-4 1830---GLO---Not Set
- 1938---Williams & Works---"Point" dbl. dist. N. from 1/8 line fence & S 1/4 cor.
- 1955---Williams & Works---Set Iron dbl. dist. N. from 1/8 line fence & S 1/4 cor.
Tw. B" Oak S 6.8' 12" Poplar ESE 29.2' 12" Poplar NE 30.6'
- 1975---LCRC #830---Spicer---2" Iron 4' high
14" Poplar S40°E 30.00' 16" Oak S00°W 7.65' 10" Poplar N90°W 32.35'
- Kent Co. Wits.---same as LCRC #830

B. Description of corner evidence found and/or method applied in restoring or reestablishing corner:

- F-4 Found 1/2" Iron Pipe inside 2" Iron Pipe - remains of 4' tall Iron Pipe laying on ground - per the following remaining witnesses:
Nail in 20" Poplar S70°E 29.86'
Nail in 24" Oak S10°W 7.50' These tree also have "blazes" in face
Nail in 12" Stump N90°W 32.31' that fit ± witnesses for 1953 tree size.

The 1/2" Iron Pipe is 12.2' E. and 26.7' N' from intersection of 1/4 lines.

The 1/2" Iron Pipe inside the 2" Iron Pipe is accepted by me and is generally accepted by professional surveyors as the best available evidence of the position of the corner.

C. Description of monument for corner and accessories established to perpetuate locating the position of the corner:

- F-4 Set Standard Kent Co. Monument (Harrison) in place of the 1/2" Iron Pipe inside the 2" Iron Pipe.
Dbl. Head Nail NE side 20" Poplar S70°E 29.86'
Dbl. Head Nail W. side 24" Oak S10°W 7.50'
Dbl. Head Nail S. side 12" Stump N90°W 32.31'
Nail & KC Remon. tag S. side 18" Oak N85°W 23.36'
Dbl. Head Nail W. side 20" Oak N00°E 28.32'

Signed by *Kirk Breitels*
Surveyor's Michigan License No. 30077

Date 8/28/97

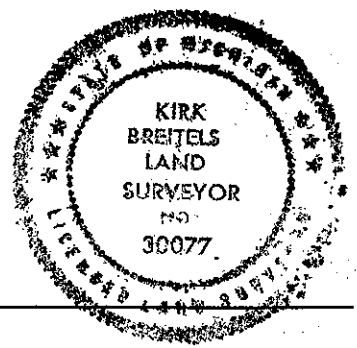

P.A. 345 1990 KENT COUNTY

PEER APPROVED 7/24/97

CHAIRMAN *Frank Huber*