

SURVEY & REMONUMENTATION

MAR 03 1998

SECTION

KENT COUNTY REMONUMENTATION

LAND CORNER RECORDATION CERTIFICATE  
Filing Requirement of Act 74, Mich. P.A. 1970

For corners in  
KENT COUNTY

(County)

Located In:

Corner Code #

1. Public Land Survey

T 6N R 9W F-6

T R

T R

T R

2. Property Controlling in Section

S T R

3. Miscellaneous

S T R

Property in Sec.

S T R

4. Lot No. \_\_\_\_\_, Recorded Plat \_\_\_\_\_

5. Private Claims \_\_\_\_\_

STATE OF MICHIGAN  
COUNTY OF KENT  
RECEIVED FOR RECORD  
97 OCT 14 AM 10:01  
REG. OF DEEDS  
*Lucy Bond*

10039

Register of Deeds Stamp & File Number

	A	B	C	D	E	F	G	H	I	J	K	L	M
1													
2	6		5		4		3		2		1		
3													
4	7		8		9		10		11		12		
5													
6	16		17		16		15		14		13		
7													
8	19		20		21		22		23		24		
9													
10	30		29		28		27		26		25		
11													
12	31		32		33		34		35		36		
13													

I, Kirk Breitels, in a field survey on July 2, 1997 do hereby state that under requirements of P.A. 74, Michigan P.A. of 1970, the corner points mentioned in lines 1 and 2 above were in conformance with regulations and rules therefore as required in the current manual of survey instructions of the United States Department of the Interior, Bureau of Land Management or by a decree of a Court of Law and/or that the corner points mentioned in lines 3, 4 and 5 above were in conformance with the rules of the Michigan Board of Land Surveyors or by a Decree of a Court of Law, established, re-established, monumented, recovered, found as expressed below:

NOTE: Not more than 2 corners, all in the same town and range, may be recorded on this certificate.

A. Description of original monument and accessories and/or subsequent restoration:

- F-6 1830---GLD---Not Set
- 1971---LCRC #3258---Hay---Set 3/4" Iron at intersection 1/4 lines  
12" Oak ENE 39.25' 14" Oak W 35.60' 16" Oak SE 15.20'  
12" Oak SSE 34.75' 13" Oak NW 47.90'
- 1987---Williams & Works---Fd. & accepted 3/4" Iron
- 1994---Survey---Roosien---3/4" Iron per LCRC #3258

B. Description of corner evidence found and/or method applied in restoring or reestablishing corner:

- F-6 Found PK Nail in asphalt pavement - fairly new road - per witnesses:  
Fd. Nail in 18" Oak W 35.58' Fd. Capped Iron - Roosien W 33.06'  
Fd. Nail in 24" Oak SE 15.20'  
Fd. Nail in 20" Oak SSE 33.77'

The PK Nail is 4.5' E. and 3.3' N. of intersection of 1/4 lines and agrees with measurements of others.

The PK Nail is accepted by me and is generally accepted by professional surveyors as the best available evidence of the position of the corner.

C. Description of monument for corner and accessories established to perpetuate locating the position of the corner:

- F-6 Set Standard Kent Co. Monument (Harrison) in place of the PK Nail
- Nail & KC Remon. tag NW side 12" Oak S50°W 56.29'
- Nail & KC Remon. tag E. side 12" Oak N30°W 68.94'
- Nail & KC Remon. tag S. side 18" Oak N85°W 35.58'
- Nail & KC Remon. tag SW side 24" Oak S55°E 15.20'
- Nail & KC Remon. tag W. side 20" Oak S10°E 33.77'
- Capped Rerod (Roosien) West 33.06'
- C/L N-S Asph. Rd. is West 8'±

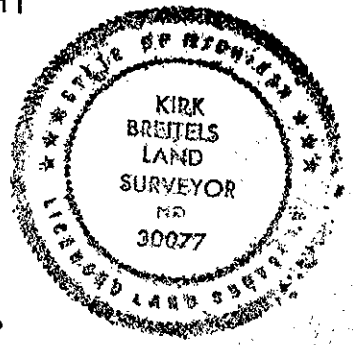

Signed by

*Kirk Breitels*

Surveyor's Michigan License No. 30077

Date 8/28/97

P.A. 345 1990 KENT COUNTY

PEER APPROVED 7/24/97

CHAIRMAN *[Signature]*

FORM APPROVED BY MICHIGAN STATE BOARD OF PROFESSIONAL SURVEYORS, JAN. 26, 1971

REVISED MAY 14, 1975

REVISED JAN., 1983

REVISED OCT., 1985