

SURVEY & REMONUMENTATION

MAR 03 1998

KENT COUNTY REMONUMENTATION

SECTION

LAND CORNER RECORDATION CERTIFICATE
Filing Requirement of Act 74, Mich. P.A. 1970

For corners in

KENT COUNTY (County)	Located in:	Corner Code #
1. Public Land Survey	T <u>6N</u> R <u>9W</u>	<u>G-2</u>
	T _____ R _____	_____
	T _____ R _____	_____
	T _____ R _____	_____
2. Property Controlling in Section	S _____ T _____ R _____	_____
	S _____ T _____ R _____	_____
3. Miscellaneous Property in Sec.	S _____ T _____ R _____	_____
	S _____ T _____ R _____	_____

STATE OF MICHIGAN
COUNTY OF KENT
RECEIVED FOR RECORD
97 APR 29 AM 8:22
REG. OF DEEDS
Lucy Spauld

9836

Register of Deeds Stamp & File Number

4. Lot No. _____, Recorded Plat _____
5. Private Claims _____

	A	B	C	D	E	F	G	H	I	J	K	L	M
1													
2	6		5		4		3		2		1		
3													
4	7		8		9		10		11		12		
5													
6	18		17		16		15		14		13		
7													
8	19		20		21		22		23		24		
9													
10	30		29		28		27		26		25		
11													
12	31		32		33		34		35		36		
13													

I, Kirk Breitels, in a field survey on Jan. 10, 1997 do hereby state that under requirements of P.A. 74, Michigan P.A. of 1970, the corner points mentioned in lines 1 and 2 above were in conformance with regulations and rules therefore as required in the current manual of survey instructions of the United States Department of the Interior, Bureau of Land Management or by a decree of a Court of Law and/or that the corner points mentioned in lines 3, 4 and 5 above were in conformance with the rules of the Michigan Board of Land Surveyors or by a Decree of a Court of Law; established, re-established, monumented, recovered, found as expressed below:

NOTE: Not more than 2 corners, all in the same town and range, may be recorded on this certificate.

A. Description of original monument and accessories and/or subsequent restoration:

G-2	1830	GLO	Mullett	Set Post
	1939	Kent Co. Wit.		1" Iron
	1974	LCRC #646	VanKooten	"T" Iron
	1984	LCRC #3885	Bonnema	1/2" Iron in mon. box
	1988	LCRC #4912	Marschall	Set Kent County Monument
	1995	LCRC #8209	Breitels	Kent County Monument

The position of this corner was previously approved by the Kent County Remonumentation Peer Group, monumented by Chris Marschall on 11/3/88 and was recorded per LCRC #4912.

B. Description of corner evidence found and/or method applied in restoring or reestablishing corner:

G-2 Found standard Kent Co. Mon. (Harrison) per witnesses from above LCRC as set by Chris Marschall over top of the 1/2 Iron Pipe he found inside a mon. box. Said Iron Pipe checks with LCRC #3885 and previous survey data.

LCRC #4912				LCRC #8209			
Nail & tag Power Pole	N50°W	33.87'		Nail & tag PP	N50°W	33.94'	
Nail & tag 8" Oak	S41°W	107.01'		Nail & tag 8" Hickory	S82°W	83.28'	
Nail & tag 6" Hickory	S82°W	83.28'		Nail & tag Tri. 16" Oak	S72°E	182.05'	
Nail & tag Tri. 14" Oak	S72°E	181.98'		Nail & tag P. Pole	S50°W	58.13'	
				Nail & tag P. Pole	S55°E	74.35'	
				C/L top of fire hydrant	N60°E	57.29'	

The selected location is accepted by me and is generally accepted by professional surveyors as the best available evidence of the position of the original corner.

C. Description of monument for corner and accessories established to perpetuate locating the position of the corner:

G-2 Standard Kent County Monument in Mon. Box					
Nail & KC Remon. tag SW side Power Pole	N50°W	33.94'			
Nail & KC Remon. tag S. side 8" Hickory	S82°W	83.28'			
Nail & KC Remon. tag N. side Tri. 16" Oak	S72°E	182.05'			
Nail & KC Remon. tag SE side Power Pole	S50°W	58.13'			
Nail & KC Remon. tag SW side Power Pole	S55°E	74.35'			
C/L top of fire hydrant	N60°E	57.29'			

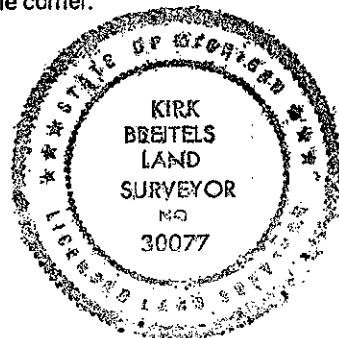

Signed by Kirk Breitels

Date 3/27/97

Surveyor's Michigan License No. 30077

P.A. 345 1990 KENT COUNTY

PEER APPROVED 3/27/97

CHAIRMAN Harry Dubess

FORM APPROVED BY MICHIGAN STATE BOARD OF PROFESSIONAL SURVEYORS, JAN. 28, 1971
REVISED MAY 14, 1975
REVISED JAN., 1983
REVISED OCT., 1985