

SURVEY & REMONUMENTATION

MAR 03 1998

SECTION

KENT COUNTY REMONUMENTATION

LAND CORNER RECORDATION CERTIFICATE
Filing Requirement of Act 74, Mich. P.A. 1970

For corners in
KENT COUNTY

(County)

Located In:

Corner Code #

- | | | |
|------------------------------------|-------------------------|-------|
| 1. Public Land Survey | T <u>6N</u> R <u>9W</u> | H-2 |
| | T _____ R _____ | _____ |
| | T _____ R _____ | _____ |
| | T _____ R _____ | _____ |
| 2. Property Controlling in Section | S _____ T _____ R _____ | _____ |
| | S _____ T _____ R _____ | _____ |
| 3. Miscellaneous Property in Sec. | S _____ T _____ R _____ | _____ |
| | S _____ T _____ R _____ | _____ |

STATE OF MICHIGAN
COUNTY OF KENT
RECEIVED FOR RECORD
97 OCT 14 AM 10: 01
REG. OF DEEDS
Luis J. Bond

10041

Register of Deeds Stamp & File Number

4. Lot No. _____, Recorded Plat _____
5. Private Claims _____

I, Kirk Breitels, in a field survey on June 17, 1997 do hereby state that under requirements of P.A. 74, Michigan P.A. of 1970, the corner points mentioned in lines 1 and 2 above were in conformance with regulations and rules therefore as required in the current manual of survey instructions of the United States Department of the Interior, Bureau of Land Management or by a decree of a Court of Law and /or that the corner points mentioned in lines 3, 4 and 5 above were in conformance with the rules of the Michigan Board of Land Surveyors or by a Decree of a Court of Law; established, re-established, monumented, recovered, found as expressed below:

NOTE: Not more than 2 corners, all in the same town and range, may be recorded on this certificate.

	A	B	C	D	E	F	G	H	I	J	K	L	M
1													
2	6		5		4			3		2		1	
3													
4	7		8		9			10		11		12	
5													
6	18		17		16			15		14		13	
7													
8	19		20		21			22		23		24	
9													
10	30		29		28			27		26		25	
11													
12	31		32		33			34		35		36	
13													

A. Description of original monument and accessories and/or subsequent restoration:

- H-2 1830---GLO---Not Set
Kent Co. Wits.---Iron
Iron South 33' Elm NNW 20.94'
1973---LCRC #486---Spicer---"T" Iron on top of 1 1/2" Iron
CP Pole S05°E 38.35' MBT Pole S75°W 84.00'
14" Oak N35°W 38.40' C/L road South 9'±
1974---LCRC #657---Spicer---"T" Iron
Angle Iron North 33.00' Iron South 33.00' N. line pvmnt. S 0.8'
CP Pole S05°E 38.30' MBT Pole S78°W 84.00'
1987---LCRC #4520---Herrema---"T" Iron
P. Pole South 38.35' 8" Box Elder SE 75.52' 12" Elm WSW 86.65'
8" Elm WNW 23.58' PK in C/L road South 11.09'

B. Description of corner evidence found and/or method applied in restoring or reestablishing corner:

- H-2 Found "T" Iron inside Iron Pipe (24" down) per the following witnesses:
Angle Iron North 32.70' C/L 10" Elm WNW 23.6'
PK in P. Pole South 38.43' PK in C/L road South 11.15'

"T" Iron inside the Iron Pipe is 0.1' S. & 1.6' E. from intersection of 1/4 lines and agrees with measurements of others.

The "T" Iron inside the Iron Pipe is accepted by me and is generally accepted by professional surveyors as the best available evidence of the position of the corner.

C. Description of monument for corner and accessories established to perpetuate locating the position of the corner:

- H-2 Set Standard Kent Co. Monument (Harrison) in place of the "T" Iron (left Iron Pipe)
PK Nail in E. side P. Pole S05°W 38.43'
Nail & KC Remon. tag S. side 10" Elm N65°W 23.58'
C/L top fire hydrant S65°E 105.00'
Nail & KC Remon. tag W. side 12" Elm N35°E 18.75'
PK Nail in C/L E-W asph. rd. ± South 11.15'

CAUTION:
If this monument needs to be replaced in the future:
UNDERGROUND UTILITY LINES
NEARBY - 24" D.

Signed by *Kirk Breitels*
Surveyor's Michigan License No. 30077

Date 8/28/97

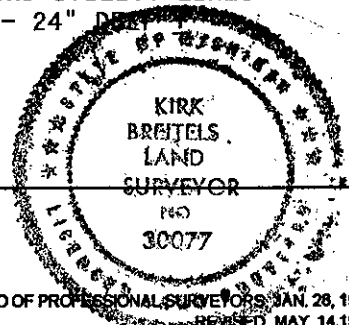

P.A. 345 1990 KENT COUNTY
PEER APPROVED 7/24/97
CHAIRMAN *Harvey K. ...*