

SURVEY & REMONUMENTATION

MAR 03 1998

72

SECTION

KENT COUNTY REMONUMENTATION

LAND CORNER RECORDATION CERTIFICATE
Filing Requirement of Act 74, Mich. P.A. 1970

For corners in
KENT COUNTY
(County)

Located In: Corner Code #

1. Public Land Survey	T 6N R 9W	I-6
	T R	
	T R	
	T R	
2. Property Controlling in Section	S T R	
	S T R	
3. Miscellaneous Property in Sec.	S T R	
	S T R	

STATE OF MICHIGAN
COUNTY OF KENT
RECEIVED FOR RECORD
97 APR 29 AM 8:23
REG. OF DEEDS
Luc S. Bond
9857

Register of Deeds Stamp & File Number

4. Lot No. _____, Recorded Plat _____
5. Private Claims _____

I, Kirk Breitels, in a field survey on Jan. 17, 1997 do hereby state that under requirements of P.A. 74, Michigan P.A. of 1970, the corner points mentioned in lines 1 and 2 above were in conformance with regulations and rules therefore as required in the current manual of survey instructions of the United States Department of the Interior, Bureau of Land Management or by a decree of a Court of Law and/or that the corner points mentioned in lines 3, 4 and 5 above were in conformance with the rules of the Michigan Board of Land Surveyors or by a Decree of a Court of Law; established, re-established, monumented, recovered, found as expressed below:

NOTE: Not more than 2 corners, all in the same town and range, may be recorded on this certificate.

A	B	C	D	E	F	G	H	I	J	K	L	M
1												
2	6	5	4	3	2	1						
3												
4	7	8	9	10	11	12						
5												
6	18	17	16	15	14	13						
7												
8	19	20	21	22	23	24						
9												
10	30	29	28	27	26	25						
11												
12	31	32	33	34	35	36						
13												

A. Description of original monument and accessories and/or subsequent restoration:

I-6	1830	GLO	Mullett	Set Post
	1968	Kent Co. Wit.		Monument
	1972	LCRC #158	Bonnema	Concrete Monument
	1981	LCRC #2225	Jonker	Set Kent County Monument
	1990	LCRC #5477	Starr	Kent County Monument

The position of this corner was previously approved by the Kent County Remonumentation Peer Group, monumented by Robert J. Jonker on 10-30-81 and was recorded per LCRC #2225.

B. Description of corner evidence found and/or method applied in restoring or reestablishing corner:

I-6 Found standard Kent Co. Mon. (Harrison) per witnesses from above LCRC as set by Robert J. Jonker in place of the Concrete Monument he found. Said Concrete Monument checks with Kent Co. Wit. and LCRC #158.

LCRC #2225	Reмон. tag 28" Oak S18°W 27.69'	LCRC #5477	Nail & tag 28" Oak S18°W 27.64'
	Reмон. tag 16" Oak N86°W 53.53'		Nail & tag 16" Oak N86°W 53.51'
	Reмон. tag 32" Oak N04°W 44.90'		Nail & tag 32" Oak N04°W 44.88'
	Reмон. tag P. Pole N52°W 54.4'		Nail & tag P. Pole N52°W 54.42'
	NW cor. gar. fnd. S54°E 83.10'		NW cor. gar. fnd. S54°E 83.10'

The selected location is accepted by me and is generally accepted by professional surveyors as the best available evidence of the position of the original corner.

C. Description of monument for corner and accessories established to perpetuate locating the position of the corner:

I-6	Standard Kent County Monument
	Nail & KC Remon. tag NW side 32" Oak S18°W 27.64'
	Nail & KC Remon. tag S. side 22" Oak N86°W 53.51'
	Nail & KC Remon. tag E. side 36" Oak N04°W 44.88'
	Nail & KC Remon. tag SW side P. Pole N52°W 54.42'
	NW corner garage foundation S54°E 83.10'
	C/L N-S grav. rd. is West 19'±
	On tree row to West and on hedge row to East

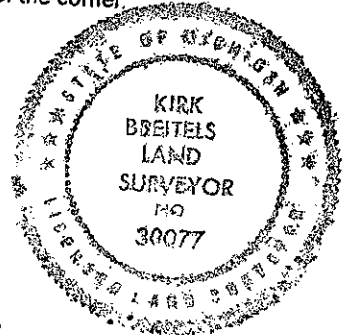

Signed by Kirk Breitels

Surveyor's Michigan License No. 30077

Date 3/27/97

P.A. 345 1990 KENT COUNTY

PEER APPROVED 3/27/97

CHAIRMAN [Signature]

FORM APPROVED BY MICHIGAN STATE BOARD OF PROFESSIONAL SURVEYORS, JAN. 28, 1971

REVISED MAY 14, 1975
REVISED JAN., 1983
REVISED OCT., 1985