

**SURVEY & REMONUMENTATION**

**MAR 03 1998**

**KENT COUNTY REMONUMENTATION**

**LAND CORNER RECORDATION CERTIFICATE**  
Filing Requirement of Act 74, Mich. P.A. 1970

STATE OF MICHIGAN  
COUNTY OF KENT  
RECEIVED FOR RECORD  
97 OCT 14 AM 10:01  
REG. OF DEEDS  
*Lucy [Signature]*

For corners in **SECTION**

**KENT COUNTY**

(County)

Located In:

Corner Code #

1. Public Land Survey

T 6N	R 9W	L-2
T	R	
T	R	
T	R	
T	R	
S	T	R
S	T	R
S	T	R
S	T	R

2. Property Controlling in Section

3. Miscellaneous Property in Sec.

4. Lot No. \_\_\_\_\_, Recorded Plat \_\_\_\_\_

5. Private Claims \_\_\_\_\_

**10044**

Register of Deeds Stamp & File Number

	A	B	C	D	E	F	G	H	I	J	K	L	M
1													
2	6		5		4		3		2			1	
3													
4	7		8		9		10		11		12		
5													
6	18		17		16		15		14		13		
7													
8	19		20		21		22		23		24		
9													
10	30		29		28		27		26		25		
11													
12	31		32		33		34		35		36		
13													

I, Kirk Breitels, in a field survey on June 17, 1997 do hereby state that under requirements of P.A. 74, Michigan P.A. of 1970, the corner points mentioned in lines 1 and 2 above were in conformance with regulations and rules therefore as required in the current manual of survey instructions of the United States Department of the Interior, Bureau of Land Management or by a decree of a Court of Law and for that the corner points mentioned in lines 3, 4 and 5 above were in conformance with the rules of the Michigan Board of Land Surveyors or by a Decree of a Court of Law; established, re-established, monumented, recovered, found as expressed below:

NOTE: Not more than 2 corners, all in the same town and range, may be recorded on this certificate.

**A. Description of original monument and accessories and/or subsequent restoration:**

- L-2 1830---GLO---Not Set
- 1954-75---Williams & Works---Set & Used Iron at intersection of 1/4 lines "X" on pvmnt. N 35.42' 14" Box Elder NW 6.46' Steel Fc. Post S 14.2' P. Pole E 39.7'
- 1959---Kent Co. Wits.---Same information as Williams & Works
- 1972---LCRC #237---Spicer---3/4" Iron C/L pvmnt. N 36.52' Face steel post S10°W 14.20' CP Pole E 35.42'
- 1976---LCRC #901---Fluharty---3/4" Pipe P.P. S84°E 40.15' Capped "T" Iron (Spicer) S04°E 13.87' C/L steel post S33°W 5.91' C/L M-21 North 36.4'

**B. Description of corner evidence found and/or method applied in restoring or reestablishing corner:**

L-2 Found 3/4" x 36" Solid Iron over top of 3/4" Iron Pipe (48" deep) per the following witnesses:

- Capped "T" Iron (Spicer) S04°E 13.87'
- C/L gas line sign S30°W 5.8'
- C/L Fulton St. (M-21) pvmnt. North 36.6'±

3/4" Solid Iron over a 3/4" Iron Pipe is 4.5' E. & 0.4' N. of intersection of 1/4 lines and fits measurements of others.

The 3/4" Solid Iron over a 3/4" Iron Pipe is accepted by me and is generally accepted by professional surveyors as the best available evidence of the position of the corner.

**C. Description of monument for corner and accessories established to perpetuate locating the position of the corner:**

L-2 Set Standard Kent Co. Monument (Harrison) in place of the 3/4" Solid Iron over the 3/4" Iron Pipe.

- Nail & KC Remon. tag N. side P. Pole N80°E 44.70'
- Nail & KC Remon. tag W. side Lt. Pole N05°E 146.32'
- Nail & KC Remon. tag N. side P. Pole N90°W 129.38'
- Nail & KC Remon. tag SE side 18" Box Elder S40°W 26.22'
- Capped "T" Iron S04°E 13.87'

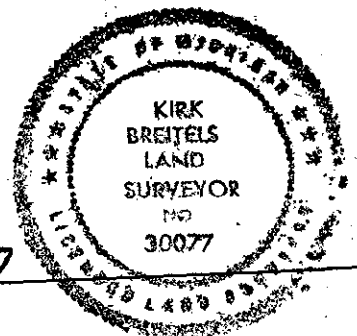

Signed by

*Kirk Breitels*

30077

Surveyor's Michigan License No.

P.A. 345 1990 KENT COUNTY

PEER APPROVED 7/29/97

CHAIRMAN *[Signature]*

Date

8/28/97