

SURVEY & REMONUMENTATION

FEB 14 1997

COMMISSION

KENT COUNTY REMONUMENTATION

LAND CORNER RECORDATION CERTIFICATE
Filing Requirement of Act 74, Mich. P.A. 1970

For corners in

KENT COUNTY

(County)

Located In:

Corner Code #

- | | | |
|------------------------------------|------------|-----|
| 1. Public Land Survey | T 6N R 10W | A-4 |
| | T R | |
| | T R | |
| | T R | |
| | T R | |
| 2. Property Controlling in Section | S T R | |
| | S T R | |
| 3. Miscellaneous Property in Sec. | S T R | |
| | S T R | |

STATE OF MICHIGAN
COUNTY OF KENT
RECEIVED FOR RECORD
96 SEP 13 PM 12:07
REG. OF DEEDS
Lucy Stord

9383

Register of Deeds Stamp & File Number

4. Lot No. _____, Recorded Plat _____
5. Private Claims _____

I, Kirk Breitels, in a field survey on July 29, 1996 do hereby state that under requirements of P.A. 74, Michigan P.A. of 1970, the corner points mentioned in lines 1 and 2 above were in conformance with regulations and rules therefore as required in the current manual of survey instructions of the United States Department of the Interior, Bureau of Land Management or by a decree of a Court of Law and/or that the corner points mentioned in lines 3, 4 and 5 above were in conformance with the rules of the Michigan Board of Land Surveyors or by a Decree of a Court of Law, established, re-established, monumented, recovered, found as expressed below:

NOTE: Not more than 2 corners, all in the same town and range, may be recorded on this certificate.

1	A	B	C	D	E	F	G	H	I	J	K	L	M
2		6		5		4		3		2		1	
3													
4	●	7		8		9		10		11		12	
5													
6		18		17		16		15		14		13	
7													
8		19		20		21		22		23		24	
9													
10		30		29		28		27		26		25	
11													
12		31		32		33		34		35		36	
13													

A. Description of original monument and accessories and/or subsequent restoration:

- | | | | | |
|-----|------|---------------|-------------|--------------------------|
| A-4 | 1831 | GLO | Mullett | Not Set |
| | 1963 | Kent Co. Wit. | | 1/2" Iron |
| | 1972 | LCRC #146 | N. C. Jones | 1/2" Iron |
| | 1972 | LCRC #322 | Spicer | 1/2" Iron |
| | 1980 | LCRC #1429 | Merdzinski | Set Kent County Monument |
| | 1989 | LCRC #4994 | Bueche | Kent County Monument |

P.A. 345 1990 KENT COUNTY
PEER APPROVED 8/22/96
CHAIRMAN *Harry Huber*

The position of this corner was previously approved by the Kent County Remonumentation Peer Group, monumented by John A. Merdzinski on 10/20/80 and was recorded per LCRC #1429

B. Description of corner evidence found and/or method applied in restoring or reestablishing corner:

A-4 Found NOTHING AT CORNER. Set Standard Kent Co. Mon. on Twp. line and per witnesses from above LCRC as set by John A. Merdzinski in place of the 1/2" Iron and 1 1/4" Iron he found. Both Irons check with Kent Co. Wit. and LCRC's #146 & #322.

- | | |
|----------------------------------|----------------------------------|
| <u>LCRC #1429</u> | <u>LCRC #4994</u> |
| 36" Oak N55°W 66.95' | 38" Oak N55°W 66.95' |
| 32" Oak S75°W 83.08' | 36" Oak S75°W 83.08' |
| 12" Elm S70°E 65.10' | C/L MH West 17.45' |
| SE cor. Hse. #4787 N25°W 96.13' | P.Pole S70°E 55.85' |
| SW cor. Hse. #4813 N30°E 135.91' | C/L MH West 17.45' |
| | SE cor. Hse. #4787 N25°W 96.13' |
| | SW cor. Hse. #4813 N30°E 135.91' |

The selected location is accepted by me and is generally accepted by professional surveyors as the best available evidence of the position of the corner

C. Description of monument for corner and accessories established to perpetuate locating the position of the corner:

- | | | | |
|-----|---------------------------------|-------|---------|
| A-4 | Standard Kent County Monument | | |
| | NE cor. CB header | S45°E | 47.44' |
| | NW cor. CB header | S40°W | 46.22' |
| | NW cor. brick house | S60°W | 149.95' |
| | NW cor. CB header | N60°E | 58.32' |
| | Nail & MDSH tag NW side P. Pole | N35°E | 85.06' |
| | C/L Manhole | N90°W | 17.39' |
| | KC Mon. (M-4 T6N, R11W) | North | 7.16' |

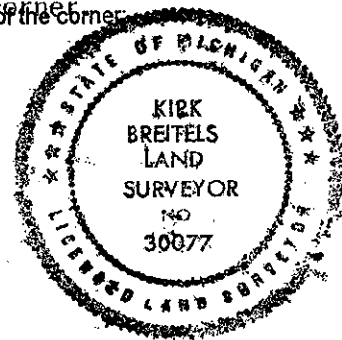

Signed by *Kirk Breitels*
Surveyor's Michigan License No. 30077

Date 8/25/96