

SURVEY & REMONUMENTATION

KENT COUNTY REMONUMENTATION

FEB 14 1997

LAND CORNER RECORDATION CERTIFICATE
Filing Requirement of Act 74, Mich. P.A. 1970

COMMISSION

corners in
KENT COUNTY

Located In: Corner Code #

Public Land Survey

T 6N R 10W	A-6
T R	
T R	
T R	
T R	
S T R	
S T R	
S T R	
S T R	

Property Controlling in Section
Miscellaneous
Property in Sec.

Lot No. _____, Recorded Plat _____
Private Claims _____

STATE OF MICHIGAN
COUNTY OF KENT
RECEIVED FOR RECORD

96 MAR 20 AM 8:44

REG. OF DEEDS
8930

Register of Deeds Stamp & File Number

Kirk Breitels, in a field survey on Feb. 26, 1996 do hereby state that under requirements of P.A. 74, Michigan P.A. of 1970, the corner points mentioned in lines 1 and 2 above were in conformance with regulations and rules therefore as required in the current manual of survey instructions of the United States Department of the Interior, Bureau of Land Management or by a decree of a Court of Law and/or that the corner points mentioned in lines 3, 4 and 5 above were in conformance with the rules of the Michigan Board of Land Surveyors or by a Decree of a Court of Law, established, re-established, monumented, discovered, found as expressed below:

NOTE: Not more than 2 corners, all in the same town and range, may be recorded on this certificate.

	A	B	C	D	E	F	G	H	I	J	K	L	M
1													
2	6	5	4	3	2	1							
3													
4	7	8	9	10	11	12							
5													
6	18	17	16	15	14	13							
7													
8	19	20	21	22	23	24							
9													
10	30	29	28	27	26	25							
11													
12	31	32	33	34	35	36							
13													

Description of original monument and accessories and/or subsequent restoration:

A-6	1831	GLO	Mullett	Not Set
	1962	Kent Co. Wit.		Iron
	1973	LCRC #496	Spicer	1/2" Iron in Mon. Box
	1984	LCRC #3864	Rosema	Set Kent County Monument in Mon. Box
	1988	LCRC #4895	Bueche	Set Kent Co. Mon. after const.
	1989	LCRC #4996	Bueche	Kent County Monument

P.A. 345 1990 KENT COUNTY
PEER APPROVED 3/7/96
CHAIRMAN Gary Huber

The position of this corner was previously approved by the Kent County Remonumentation Peer Group, monumented by Maurice J. Rosema on 7/10/84 and was recorded per LCRC #3864

Description of corner evidence found and/or method applied in restoring or reestablishing corner:
A-6 Found standard Kent Co. Mon. (Harrison) per witnesses from above LCRC as set by Maurice J. Rosema on Twp. Line in place of the 1/2" Iron he found inside a Mon. Box. Said Iron checks with Kent Co. Wit. and LCRC #496.

LCRC #3864
Nail/tag 18" Aspen N12°E 173.04'
Nail/tag 15" Basswood S90°E 104.96'
C/L top of hydrant N10°W 191.28'
E. edge MH casting S76°W 15.89'
KC Mon. North 5.41' PP S25°E 94.05'

LCRC #4895
Nail/tag 18" Basswood S90°E 104.96'
C/L top hydr. N10°W 193.33'
Nail/tag PP S25°E 94.05' KC Mon. M-6, 6-11 North 5.41'
"X" on curb N53°W 52.26'
"X" on curb S49°W 53.67'

The selected location is accepted by me and is generally accepted by professional surveyors as the best available evidence of the position of the corner.
Description of monument for corner and accessories established to perpetuate locating the position of the corner:

A-6 Standard Kent County Monument

Nail & KC Remon. tag N. side	20" Basswood	S90°E	104.96'
C/L top of fire hydrant		N10°W	193.29'
PK Nail & KC Remon. tag NE side	P. Pole	S25°E	94.01'
NW corner catch basin header		S25°W	90.00'
SE corner catch basin header		N10°E	154.90'
Kent Co. Mon. (M-6, T6N, R11W)		North	5.44'
On E. edge turn lane			

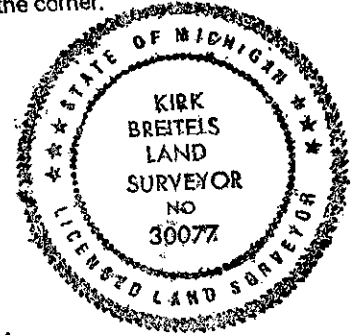

Witnessed by Kirk Breitels
Surveyor's Michigan License No. 30077

Date 3/1/96