

**SURVEY & REMONUMENTATION**

FEB 14 1997

KENT COUNTY REMONUMENTATION

**COMMISSION LAND CORNER RECORDATION CERTIFICATE**  
Filing Requirement of Act 74, Mich. P.A. 1970

For corners in  
KENT COUNTY

Located In:	Corner Code #
1. Public Land Survey T 6N R 10W	B-3
T R	
T R	
T R	
2. Property Controlling in Section S T R	
S T R	
3. Miscellaneous Property in Sec. S T R	
S T R	

STATE OF MICHIGAN  
COUNTY OF KENT  
RECEIVED FOR RECORD  
96 MAR 20 AM 8:44  
REG. OF DEEDS  
*Eric J. Bond*

8933

Register of Deeds Stamp & File Number

4. Lot No. \_\_\_\_\_, Recorded Plat \_\_\_\_\_  
5. Private Claims \_\_\_\_\_

I, Kirk Breitels, in a field survey on Feb. 9, 1996 do hereby state that under requirements of P.A. 74, Michigan P.A. of 1970, the corner points mentioned in lines 1 and 2 above were in conformance with regulations and rules therefore as required in the current manual of survey instructions of the United States Department of the Interior, Bureau of Land Management or by a decree of a Court of Law and /or that the corner points mentioned in lines 3, 4 and 5 above were in conformance with the rules of the Michigan Board of Land Surveyors or by a Decree of a Court of Law; established, re-established, monumented, recovered, found as expressed below:

NOTE: Not more than 2 corners, all in the same town and range, may be recorded on this certificate.

	A	B	C	D	E	F	G	H	I	J	K	L	M
1													
2	6	5	4	3	2	1							
3	●												
4	7	8	9	10	11	12							
5													
6	18	17	16	15	14	13							
7													
8	19	20	21	22	23	24							
9													
10	30	29	28	27	26	25							
11													
12	31	32	33	34	35	36							
13													

A. Description of original monument and accessories and/or subsequent restoration:

B-3	1831	GLO	Mullett	Set Post
		Kent Co. Wit.		"T" Iron
	1975	LCRC #852	Nederveld	"T" Iron
	1982	LCRC #2726		Set Kent County Monument
	1992	LCRC #6570	Bonnema	Set Kent Co. Mon. after const.
	1994	LCRC #7086	Bueche	Kent County Monument

P.A. 345 1990 KENT COUNTY  
PEER APPROVED 3/7/96  
CHAIRMAN *Ray Stuber*

The position of this corner was previously approved by the Kent County Remonumentation Peer Group, monumented by John A. Merdzinski on 2/17/82 and was recorded per LCRC #2726

B. Description of corner evidence found and/or method applied in restoring or reestablishing corner:

B-3 Found standard Kent Co. Mon. (Harrison) per witnesses from above LCRC as set by Douglas Bonnema at the same location as set in 1982 by John A. Merdzinski in place of the "T" Iron he found. Said "T" Iron checks with Kent Co. Wit. and LCRC #652.

LCRC #6570	LCRC #7086
Nail/tag 11" Hickory S21°E 87.96'	SW cor. CB N10°E 167.31'
C/L MH S. 12.59'	SE cor. CB N10°W 169.35'
C/L MH N. 158.23'	NE cor. gutterpan S15°W 185.97'
C/L top hydr. S12°W 217.99'	NW cor. gutterpan South 198.56'
C/L top hydr. N12°W 212.75'	Nail/tag 12" Hickory S21°E 87.96'
"X" top sewer N30°W 136.52'	C/L MH - South 12.59'

The selected location is accepted by me and is generally accepted by professional surveyors as the best available evidence of the position of the original corner.

C. Description of monument for corner and accessories established to perpetuate locating the position of the corner:

B-3 Standard Kent County Monument	
SW corner catch basin casting	N10°E 167.31'
SE corner catch basin casting	N10°W 169.30'
NE corner gutterpan N. end curb return	S15°W 185.97'
NW corner gutterpan N. end curb return	South 198.50'
Nail & KC Remon. tag NE side 12" Hickory	S21°E 87.96'
C/L Manhole	South 12.59'
Exxel capped iron at C/L Abbeydale	North 699.38'
On C/L bit. road N-S ±	

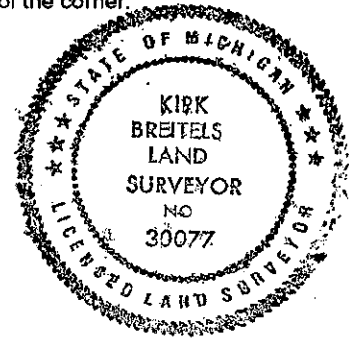

Signed by *Kirk Breitels*  
Surveyor's Michigan License No. 30077

Date 3/1/96