

SURVEY & REMONUMENTATION

FEB 14 1997

KENT COUNTY REMONUMENTATION

COMMISSION

LAND CORNER RECORDATION CERTIFICATE
Filing Requirement of Act 74, Mich. P.A. 1970

For corners in
KENT COUNTY

(County).

Located In:

Corner Code #

- | | | | |
|------------------------------------|--------------|---------------|--------------|
| 1. Public Land Survey | T <u>6</u> N | R <u>10</u> W | <u>B-11</u> |
| | T <u> </u> | R <u> </u> | <u> </u> |
| | T <u> </u> | R <u> </u> | <u> </u> |
| | T <u> </u> | R <u> </u> | <u> </u> |
| 2. Property Controlling in Section | S <u> </u> | T <u> </u> | R <u> </u> |
| | S <u> </u> | T <u> </u> | R <u> </u> |
| 3. Miscellaneous Property in Sec. | S <u> </u> | T <u> </u> | R <u> </u> |
| | S <u> </u> | T <u> </u> | R <u> </u> |

4. Lot No. _____, Recorded Plat _____
5. Private Claims _____

I, Kirk Breitels, in a field survey on Apr. 5, 1996 do hereby state that under requirements of P.A. 74, Michigan P.A. of 1970, the corner points mentioned in lines 1 and 2 above were in conformance with regulations and rules therefore as required in the current manual of survey instructions of the United States Department of the Interior, Bureau of Land Management or by a decree of a Court of Law and/or that the corner points mentioned in lines 3, 4 and 5 above were in conformance with the rules of the Michigan Board of Land Surveyors or by a Decree of a Court of Law; established, re-established, monumented, recovered, found as expressed below:

NOTE: Not more than 2 corners, all in the same town and range, may be recorded on this certificate.

A. Description of original monument and accessories and/or subsequent restoration:

- | | | | | |
|------|------|---------------|------------|--------------------------------------|
| B-11 | 1831 | GLO | Mullett | Set Post |
| | 1962 | Kent Co. Wit. | | Mon. Box |
| | 1972 | LCRC #161 | Bonnema | Iron in Mon. Box |
| | 1982 | LCRC #2728 | Merdzinski | Set Kent County Monument in Mon. Box |
| | 1993 | LCRC #6758 | Roon | Kent County Monument |
| | 1994 | LCRC #7090 | Bueche | Kent County Monument |

The position of this corner was previously approved by the Kent County Remonumentation Peer Group, monumented by John A. Merdzinski on 2/15/82 and was recorded per LCRC #2728

B. Description of corner evidence found and/or method applied in restoring or reestablishing corner:

B-11 Found standard Kent Co. Mon. (Harrison) per witnesses from above LCRC as set by John A. Merdzinski in place of the 1" Iron he found inside a Mon. Box. Said Iron checks with Kent Co. Wit. and LCRC #161.

- | | | | | | |
|-------------------|---------------------|---------------|-------------------|-----------------------|---------------|
| <u>LCRC #2728</u> | NE cor. brick hse. | S45°E 143.09' | <u>LCRC #7090</u> | NE corner brick house | S45°E 143.09' |
| | Top C/L hydrant | N65°E 91.60' | | Top C/L hydrant | N65°E 91.60' |
| | Top C/L conc. culv. | N65°W 79.0' | | Top C/L conc. culvert | N65°W 79.0' |
| | Nail/tag P. Pole | S05°W 57.87' | | Nail/tag P. Pole | S05°W 57.87' |
| | Nail/tag 3" Elm | N05°W 55.97' | | Nail/tag P. Pole | S50°W 71.12' |

The selected location is accepted by me and is generally accepted by professional surveyors as the best available evidence of the position of the original corner.

C. Description of monument for corner and accessories established to perpetuate locating the position of the corner:

- | | |
|--|---------------|
| B-11 Standard Kent County Monument | |
| NE corner brick house | S45°E 173.09' |
| Top C/L hydrant | N65°E 91.60' |
| Cut "X" top C/L conc. culvert | N65°W 79.07' |
| New Nail & KC Remon. tag E. side P. Pole (4' high) | S05°W 57.87' |
| Nail & KC Remon. tag W. side P. Pole | S50°W 71.27' |
| Nail & KC Remon. tag W. side P. Pole | N00°E 50.93' |
| C/L E-W blacktop road is North 1'± | |

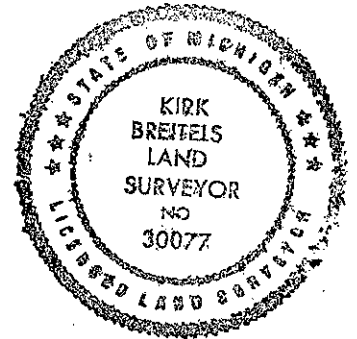

Signed by Kirk Breitels
Surveyor's Michigan License No. 30077

Date 4/19/96

STATE OF MICHIGAN
COUNTY OF KENT
RECEIVED FOR RECORD
96 JUN -7 AM 8:25
REG. OF DEEDS
W. J. Bond
9145
Register of Deeds Stamp & File Number

A	B	C	D	E	F	G	H	I	J	K	L	M
1												
2	6		5		4		3		2		1	
3												
4	7		8		9		10		11		12	
5												
6	18		17		16		15		14		13	
7												
8	19		20		21		22		23		24	
9												
10	30		29		28		27		26		25	
11												
12	31		32		33		34		35		36	
13												

P.A. 345 1970 KENT COUNTY
PEER APPROVED 5/30/96
CHAIRMAN *Harry Spiker*