

SURVEY & REMONUMENTATION

FEB 14 1997

COMMISSION

KENT COUNTY REMONUMENTATION

LAND CORNER RECORDATION CERTIFICATE
Filing Requirement of Act 74, Mich. P.A. 1970

For corners in
KENT COUNTY
(County)

Located In:

Corner Code #

1. Public Land Survey	T6N R10W	D-12
	T R	
	T R	
	T R	
	T R	
2. Property Controlling in Section	S T R	
	S T R	
3. Miscellaneous Property in Sec.	S T R	
	S T R	

REG. OF DEEDS

Lucy Stand

96 SEP 13 PM 12:06

STATE OF MICHIGAN
COUNTY OF KENT
RECEIVED FOR RECORD

9368

Register of Deeds Stamp & File Number

4. Lot No. _____, Recorded Plat _____
5. Private Claims _____

I, Kirk Breitels, in a field survey on Aug. 26, 19 96 do hereby state that under requirements of P.A. 74, Michigan P.A. of 1970, the corner points mentioned in lines 1 and 2 above were in conformance with regulations and rules therefore as required in the current manual of survey instructions of the United States Department of the Interior, Bureau of Land Management or by a decree of a Court of Law and/or that the corner points mentioned in lines 3, 4 and 5 above were in conformance with the rules of the Michigan Board of Land Surveyors or by a Decree of a Court of Law; established, re-established, monumented, recovered, found as expressed below:

NOTE: Not more than 2 corners, all in the same town and range, may be recorded on this certificate.

1	A	B	C	D	E	F	G	H	I	J	K	L	M
2		6		5		4		3		2		1	
3													
4		7		8		9		10		11		12	
5													
6		18		17		16		15		14		13	
7													
8		19		20		21		22		23		24	
9													
10		30		29		28		27		26		25	
11													
12		31		32		33		34		35		36	
13													

A. Description of original monument and accessories and/or subsequent restoration:

- D-12 1831---GLD---Not Set
- 1953-72---Williams & Works---Set/Used Iron at Int. 1/4 lines
6" Beech S 16.6' Tw. 10" Ash W 20.1'
- 1972---LCRC #341---Spicer---3/4" Iron & Stones
C/L 10" Beech S05°W 16.70' C/L Tw. 24" Hickory N85°W 20.52'
C/L Fence Post N10°W 3.75' C/L 12" Oak N55°E 15.85'
- 1989---Survey---Prien & Newhof---3/4" Iron
9" Maple N 6.78' 15" Oak NE 15.87'
16" Beech S 16.47' Tw. 16" Ash W 20.52'

B. Description of corner evidence found and/or method applied in restoring or reestablishing corner:

- D-12 Found 3/4" Iron Pipe per the following witnesses:
10" Maple N 6.7' Tw. 18" Ash WNW 20.8'
20" Oak NE 15.7' 18" Beech SSW 16.5'

P.A. 345 1990 KENT COUNTY
PEER APPROVED 8/22/96
CHAIRMAN Harry Hubert

Said 3/4" Iron Pipe is 0.2' S. and 0.3' W. from intersection of 1/4 lines and agrees with agrees with survey measurements of others.

The 3/4" Iron Pipe is accepted by me and is generally accepted by professional surveyors as the best available evidence of the position of the corner.

C. Description of monument for corner and accessories established to perpetuate locating the position of the corner:

- D-12 Set Standard Kent County Monument in place of the 3/4" Iron Pipe
- Set Nail & KC Remon. tag E. side 10" Maple N00°E 6.74'
- Set Nail & KC Remon. tag N. side 18" Maple N85°E 29.40'
- Set Nail & KC Remon. tag N. side Tw. 18" Ash N80°W 20.85'
- Set Nail & KC Remon. tag E. side 18" Beech S10°W 16.53'
- New N-S fence is East 10'±

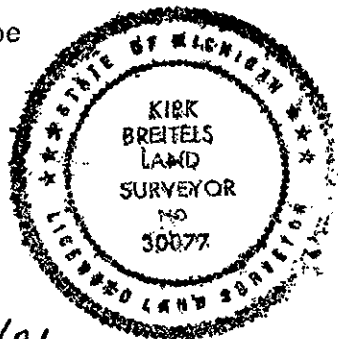

Signed by Kirk Breitels
Surveyor's Michigan License No. 30077

Date 9/4/96