

**SURVEY & REMONUMENTATION**

**KENT COUNTY REMONUMENTATION**

FEB 14 1997

**LAND CORNER RECORDATION CERTIFICATE**  
Filing Requirement of Act 74, Mich. P.A. 1970

For corners in **COMMISSION**  
**KENT COUNTY**

Located In:	Corner Code #
1. Public Land Survey	T 6N R 10W E-12
	T R
	T R
	T R
2. Property Controlling in Section	S T R
	S T R
3. Miscellaneous Property in Sec.	S T R
	S T R

STATE OF MICHIGAN  
COUNTY OF KENT  
RECEIVED FOR RECORD

96 JUN -7 AM 8:26

REG. OF DEEDS

*Lucy [Signature]*

**9149**

Register of Deeds Stamp & File Number

4. Lot No. \_\_\_\_\_, Recorded Plat \_\_\_\_\_  
5. Private Claims \_\_\_\_\_

I, Kirk Breitels, in a field survey on Apr. 8, 1996 do hereby state that under requirements of P.A. 74, Michigan P.A. of 1970, the corner points mentioned in lines 1 and 2 above were in conformance with regulations and rules therefore as required in the current manual of survey instructions of the United States Department of the Interior, Bureau of Land Management or by a decree of a Court of Law and/or that the corner points mentioned in lines 3, 4 and 5 above were in conformance with the rules of the Michigan Board of Land Surveyors or by a Decree of a Court of Law; established, re-established, monumented, recovered, found as expressed below:

A	B	C	D	E	F	G	H	I	J	K	L	M
1												
2	6	5	4	3	2	1						
3												
4	7	8	9	10	11	12						
5												
6	18	17	16	15	14	13						
7												
8	19	20	21	22	23	24						
9												
10	30	29	28	27	26	25						
11												
12	31	32	33	34	35	36						
13												

NOTE: Not more than 2 corners, all in the same town and range, may be recorded on this certificate.

A. Description of original monument and accessories and/or subsequent restoration:

E-12	1831	GLO	Mullett	Set Post
	1965	Kent Co. Wit.		Iron W. side of fence cor.
	1976	LCRC #950	Bonnema	Set 1/2" Iron holding prev. wits.
	1982	LCRC #2735	Merdzinski	Set Kent County Monument
	1994	LCRC #7117	Bueche	Kent County Monument

The position of this corner was previously approved by the Kent County Remonumentation Peer Group, monumented by John A. Merdzinski on 2/22/82 and was recorded per LCRC #2735

B. Description of corner evidence found and/or method applied in restoring or reestablishing corner:

E-12 Found standard Kent Co. Mon. (Harrison) per witnesses from above LCRC as set by John A. Merdzinski in place of the 1/2" Rebar he found. Said 1/2" Rebar checks with Kent Co. Wit. and LCRC #650.

LCRC #2735	LCRC #7117
Nail/tag 12" Maple South 11.85'	Nail/tag 14" Maple S00°E 11.60'
Nail/tag 12" Ash S45°E 12.00'	Nail/tag 14" Ash S45°E 11.96'
Nail/tag 12" Oak N60°E 13.70'	Nail/tag 14" Oak N60°E 13.44'
Nail/tag 12" Maple N45°E 29.65'	Nail/tag 14" Maple N45°E 29.75'
Nail/tag 10" Beech N15°E 17.38'	Nail/tag 12" Beech N15°E 17.38'

The selected location is accepted by me and is generally accepted by professional surveyors as the best available evidence of the position of the original corner.

C. Description of monument for corner and accessories established to perpetuate locating the position of the corner:

E-12 Standard Kent County Monument

Nail & KC Remon. tag E. side 16" Maple	S00°E	11.60'
Nail & KC Remon. tag SW side 14" Ash	S45°E	11.98'
Nail & KC Remon. tag S. side 16" Oak	N60°E	13.48'
Nail & KC Remon. tag W. side 16" Maple	N45°E	29.75'
New Nail & KC Remon. tag E. side 12" Beech	N15°E	17.35'

C/L creek - North 30'± & West 55'±

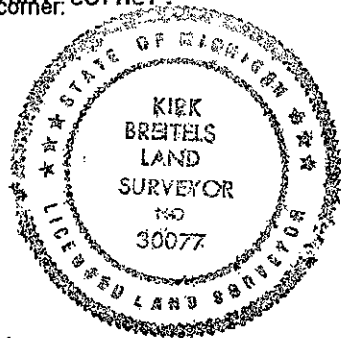

Signed by *Kirk Breitels* Date 4/19/96  
Surveyor's Michigan License No. 30077