

SURVEY & REMONUMENTATION

KENT COUNTY REMONUMENTATION

FEB 14 1997

LAND CORNER RECORDATION CERTIFICATE
Filing Requirement of Act 74, Mich. P.A. 1970

For corners in **COMMISSION**
KENT COUNTY

Located in: Corner Code #

1. Public Land Survey	T 6N R 10W	G-1
	T R	
	T R	
	T R	
2. Property Controlling in Section	S T R	
	S T R	
3. Miscellaneous Property in Sec.	S T R	
	S T R	

STATE OF MICHIGAN
COUNTY OF KENT
RECEIVED FOR RECORD
96 SEP 13 PM 12:07
REG. OF DEEDS
Eric Bond

9380

Register of Deeds Stamp & File Number

4. Lot No. _____, Recorded Plat _____
5. Private Claims _____

I, Kirk Breitels, in a field survey on June 13, 1996 do hereby state that under requirements of P.A. 74, Michigan P.A. of 1970, the corner points mentioned in lines 1 and 2 above were in conformance with regulations and rules therefore as required in the current manual of survey instructions of the United States Department of the Interior, Bureau of Land Management or by a decree of a Court of Law and /or that the corner points mentioned in lines 3, 4 and 5 above were in conformance with the rules of the Michigan Board of Land Surveyors or by a Decree of a Court of Law; established, re-established, monumented, recovered, found as expressed below:

NOTE: Not more than 2 corners, all in the same town and range, may be recorded on this certificate.

	A	B	C	D	E	F	G	H	I	J	K	L	M
1													
2	6		5		4		3		2		1		
3													
4	7		8		9		10		11		12		
5													
6	18		17		16		15		14		13		
7													
8	19		20		21		22		23		24		
9													
10	30		29		28		27		26		25		
11													
12	31		32		33		34		35		36		
13													

P.A. 345 1990 KENT COUNTY
PEER APPROVED 8/22/96
CHAIRMAN Jerry Huber

A. Description of original monument and accessories and/or subsequent restoration:

G-1	1831	GLO	Mullett	Set Post
	1939	Kent Co. Wit.		Concrete Monument
	1987	LCRC #4519	Bonnema	Concrete Monument
	1990	LCRC #5493	Bueche	Set Kent County Monument

The position of this corner was previously approved by the Kent County Remonumentation Peer Group, monumented by John C. Bueche on 5/24/90 and was recorded per LCRC #a5493.

B. Description of corner evidence found and/or method applied in restoring or reestablishing corner:

G-1 Found standard Kent Co. Mon. (Harrison) per witnesses from above LCRC as set by John C. Bueche on Twp. Line in place of the Concrete Monument he found. Said Concrete Monument checks with Kent Co. Wit. and LCRC #4519.

LCRC #5493

Nail & KC Remon. tag N. side 14" Pine	N80°E	6.03'	N. edge bit. drive
Nail & KC Remon. tag N. side 12" Pine	N90°W	1.93'	South 6.1'
Nail & KC Remon. tag N. side 12" Pine	S65°E	39.13'	C/L Thornapple River Dr.
NE corner house foundation	S60°W	82.78'	is East 128'±
KC Mon. at SE cor. Sec 33-7-10	East	59.29'	

The selected location is accepted by me and is generally accepted by professional surveyors as the best available evidence of the position of the original corner.

C. Description of monument for corner and accessories established to perpetuate locating the position of the corner:

G-1 Standard Kent County Monument

New Nail & KC Remon. tag N. side 18" Pine	N80°E	6.02'
Nail & KC Remon. tag N. side 15" Pine	N90°W	1.93'
Nail & KC Remon. tag N. side 12" Pine	S65°E	39.11'
NE corner house foundation	S60°W	82.78'
KC Mon. at SE cor. Sec 33-7-10	East	59.31'
N. edge bit. dr. - South 6.1'		
C/L Thornapple River Dr. - East 130'±		

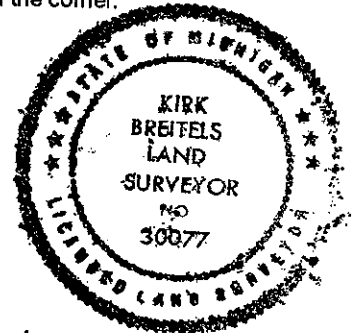

Signed by *Kirk Breitels*
Surveyor's Michigan License No. 30077

Date 8/25/96