

FEB 14 1997

COMMISSION

**KENT COUNTY REMONUMENTATION**

**LAND CORNER RECORDATION CERTIFICATE**  
Filing Requirement of Act 74, Mich. P.A. 1970

For corners in  
**KENT COUNTY**

(County)

Located In:

Corner Code #

1. Public Land Survey	T <u>6N</u> R <u>10W</u>	G-5
	T <u>    </u> R <u>    </u>	_____
	T <u>    </u> R <u>    </u>	_____
	T <u>    </u> R <u>    </u>	_____
2. Property Controlling in Section	S <u>    </u> T <u>    </u> R <u>    </u>	_____
	S <u>    </u> T <u>    </u> R <u>    </u>	_____
3. Miscellaneous Property in Sec.	S <u>    </u> T <u>    </u> R <u>    </u>	_____
	S <u>    </u> T <u>    </u> R <u>    </u>	_____

REG. OF DEEDS

*Handwritten signature*

96 JUN -7 AM 8:27

STATE OF MICHIGAN  
COUNTY OF KENT  
RECEIVED FOR RECORD

**9152**

Register of Deeds Stamp & File Number

4. Lot No. \_\_\_\_\_, Recorded Plat \_\_\_\_\_  
5. Private Claims \_\_\_\_\_

I, Kirk Breitels, in a field survey on Apr. 19, 1996 do hereby state that under requirements of P.A. 74, Michigan P.A. of 1970, the corner points mentioned in lines 1 and 2 above were in conformance with regulations and rules therefore as required in the current manual of survey instructions of the United States Department of the Interior, Bureau of Land Management or by a decree of a Court of Law and/or that the corner points mentioned in lines 3, 4 and 5 above were in conformance with the rules of the Michigan Board of Land Surveyors or by a Decree of a Court of Law; established, re-established, monumented, recovered, found as expressed below:

NOTE: Not more than 2 corners, all in the same town and range, may be recorded on this certificate.

A	B	C	D	E	F	G	H	I	J	K	L	M
1												
2	6		5		4		3		2		1	
3												
4	7		8		9		10		11		12	
5												
6	18		17		16		15		14		13	
7												
8	19		20		21		22		23		24	
9												
10	30		29		28		27		26		25	
11												
12	31		32		33		34		35		36	
13												

A. Description of original monument and accessories and/or subsequent restoration:

G-5	1831	GLO	Mullett	Set Post
		Kent Co. Wit.		Gas Pipe & Stone
	1929	"Cascade Terrace" plat		Concrete Monument
	1970	"Cascade Woods" plat		Concrete Monument
	1983	LCRC #3700	Jonker	Set Kent County Monument
	1994	LCRC #7128	Bueche	Kent County Monument

P.A. 345 1990 KENT COUNTY

PEER APPROVED 5/30/96  
CHAIRMAN *Handwritten signature*

The position of this corner was previously approved by the Kent County Remonumentation Peer Group, monumented by Robert J. Jonker on 4/8/83 and was recorded per LCRC #3700

B. Description of corner evidence found and/or method applied in restoring or reestablishing corner:

G-5 Found standard Kent Co. Mon. (Harrison) per witnesses from above LCRC as set by Robert J. Jonker in place of the Concrete Monument he found. Said Concrete Monument checks with remaining Kent Co. Wit. and adjoining plats.

LCRC #3700

LCRC #7128

Nail/tag 24" Oak	S85°W 21.50'	SW cor. brk. gar.	N45°W 58.70'
Nail/tag 24" W. Cherry	N45°W 16.28'	SW cor. brk. hse.	N65°W 95.40'
Nail/tag 6" Elm	S35°E 5.08'	Nail/tag P. Pole	S35°E 73.30'
Nail/tag P. Pole	S35°E 73.3'	SW cor. brk. chim.	N70°E 69.15'
SW cor. brk. chimney	N70°E 69.15'	Nail in P. Pole	North 1.91'

The selected location is accepted by me and is generally accepted by professional surveyors as the best available evidence of the position of the original corner.

C. Description of monument for corner and accessories established to perpetuate locating the position of the corner:

G-5 Standard Kent County Monument

SW cor. brick garage #2780 Hayward	N45°W	58.70'
SW cor. brick house #2780 Hayward	N65°W	95.40'
Nail & KC Remon. tag W. side P. Pole	S35°E	73.30'
SW cor. brick chimney #2793 Hickorywood	N70°E	69.15'
Nail in P. Pole	North	1.91'
N-S fence is East 0.9'±		
C/L Hayward Dr. is South 47'±		
C/L Hickorywood Lane is East 192'±		

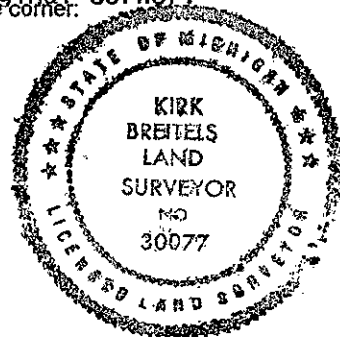

Signed by *Kirk Breitels*

Date 4/22/96

Surveyor's Michigan License No. 30077