

FEB 14 1997

COMMISSION

KENT COUNTY REMONUMENTATION

LAND CORNER RECORDATION CERTIFICATE
Filing Requirement of Act 74, Mich. P.A. 1970

For corners in
KENT COUNTY
(County)

Located In:	Corner Code #
T <u>6N</u> R <u>10W</u>	<u>H-4</u>
T _____ R _____	_____
T _____ R _____	_____
T _____ R _____	_____
2. Property Controlling in Section	S _____ T _____ R _____
	S _____ T _____ R _____
3. Miscellaneous Property in Sec.	S _____ T _____ R _____
	S _____ T _____ R _____

REG. OF DEEDS

Lucy Bond

96 SEP 13 PM 12:06

STATE OF MICHIGAN
COUNTY OF KENT
RECEIVED FOR RECORD

9371

Register of Deeds Stamp & File Number

4. Lot No. _____, Recorded Plat _____
5. Private Claims _____

I, Kirk Breitels, in a field survey on July 29, 1996 do hereby state that under requirements of P.A. 74, Michigan P.A. of 1970, the corner points mentioned in lines 1 and 2 above were in conformance with regulations and rules therefore as required in the current manual of survey instructions of the United States Department of the Interior, Bureau of Land Management or by a decree of a Court of Law and /or that the corner points mentioned in lines 3, 4 and 5 above were in conformance with the rules of the Michigan Board of Land Surveyors or by a Decree of a Court of Law; established, re-established, monumented, recovered, found as expressed below:

NOTE: Not more than 2 corners, all in the same town and range, may be recorded on this certificate.

A	B	C	D	E	F	G	H	I	J	K	L	M
1												
2	6	5	4	3	2	1						
3												
4	7	8	9	10	11	12						
5												
6	18	17	16	15	14	13						
7												
8	19	20	21	22	23	24						
9												
10	30	29	28	27	26	25						
11												
12	31	32	33	34	35	36						
13												

P.A. 345 1990 KENT COUNTY

PEER APPROVED 7/25/96

CHAIRMAN Garry Huber

A. Description of original monument and accessories and/or subsequent restoration:

- H-4 1831---GLO---Not Set
- 1928-65---Williams & Works---Stone
14" Cherry NE 30.7' 12" Oak NW 11.42' 16" Oak SW 15.93'
- Kent Co. Wit.---3' Lined Stone (wit. similar to Williams & Works)
- 1978---LCRC #1153---Merdzinski---"L" Iron (stone laying on side)
18" Oak S50°W 16.59' 16" Oak N60°W 12.22'
16" Oak N15°E 31.03' 20" Cherry N60°E 31.18'
- 1982---LCRC #3703---C.Hay---"L" Iron
16" Oak N 30.53' 18" Oak SW 16.59' 16" Cher. NE 30.56' 16" Oak NE 39.15'

B. Description of corner evidence found and/or method applied in restoring or reestablishing corner:

- H-4 Found "L" Iron per the following witnesses:
24" Oak N 31' 18" Stump NE 30.5' 27" Oak NW 12.3'
27" Oak SW 16.6' 18" Oak NE 39.8'

Said "L" Iron is 2.2' N. and 2.4' W. from intersection of 1/4 lines and agrees with adjoining plats and survey measurements of Williams & Works, Exxel Eng. and E. Glaza.

The "L" Iron is accepted by me and is generally accepted by professional surveyors as the best available evidence of the position of the corner.

C. Description of monument for corner and accessories established to perpetuate locating the position of the corner:

- H-4 Set Standard Kent County Monument in place of "L" Iron
- Set Nail & KC Remon. tag W. side 27" Oak N05°W 56.86'
- Set Nail & KC Remon. tag N. side 27" Oak N50°W 12.27'
- Set Nail & KC Remon. tag NW side 24" Oak S50°W 16.77'
- Set Nail & KC Remon. tag SE side 18" Oak N55°E 39.81'
- Set Nail & KC Remon. tag N. side 12" Oak S50°E 50.54'
- On N'ly edge of path NW-SE

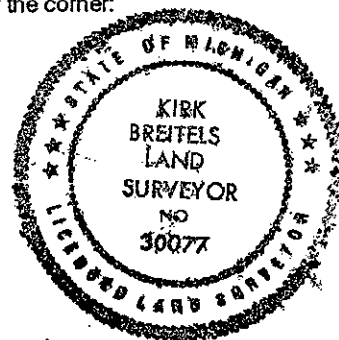

Signed by *Kirk Breitels*
Surveyor's Michigan License No. 30077

Date 8/25/96