

SURVEY & REMONUMENTATION

KENT COUNTY REMONUMENTATION

SEP 03 1999

LAND CORNER RECORDATION CERTIFICATE
Filing Requirement of Act 74, Mich. P.A. 1970

For corners in **SECTION**
KENT COUNTY

Located In: Corner Code #
T 6N R 10W H-7
T ___ R ___
T ___ R ___
T ___ R ___
S ___ T ___ R ___
S ___ T ___ R ___
S ___ T ___ R ___
S ___ T ___ R ___

1. Public Land Survey

2. Property Controlling in Section

3. Miscellaneous Property in Sec.

4. Lot No. _____, Recorded Plat _____

5. Private Claims _____

I, Kirk Breitels in a field survey on Feb. 12, 1996 do hereby state that under requirements of P.A. 74, Michigan P.A. of 1970, the corner points mentioned in lines 1 and 2 above were in conformance with regulations and rules therefore as required in the current manual of survey instructions of the United States Department of the Interior, Bureau of Land Management or by a decree of a Court of Law and /or that the corner points mentioned in lines 3, 4 and 5 above were in conformance with the rules of the Michigan Board of Land Surveyors or by a Decree of a Court of Law; established, re-established, monumented, recovered, found as expressed below:

NOTE: Not more than 2 corners, all in the same town and range, may be recorded on this certificate.

REC'D OFF DEEDS
96 MAR 20 AM 8:45
8976
Register of Deeds Stamp & File Number

	A	B	C	D	E	F	G	H	I	J	K	L	M
1													
2	6		5		4		3		2		1		
3													
4	7		8		9		10		11		12		
5													
6	18		17		16		15		14		13		
7													
8	19		20		21		22		23		24		
9													
10	30		29		28		27		26		25		
11													
12	31		32		33		34		35		36		
13													

A. Description of original monument and accessories and/or subsequent restoration:

H-7	1831	GLO	Mullett	Set Post
		Kent Co. Wit.		Iron - Mon. Box
	1972	LCRC #120	Chambers	3/4" Iron in Mon. Box
	1981	LCRC #1593	Merdzinski	Set Kent County Monument in Mon. Box
	1991	LCRC #6090	Unema	Kent County Monument in Mon. Box

P.A. 345 1990 KENT COUNTY

PEER APPROVED 3/17/96
CHAIRMAN Nancy Huber

The position of this corner was previously approved by the Kent County Remonumentation Peer Group, monumented by John A. Merdzinski on 2/18/81 and was recorded per LCRC #1593

B. Description of corner evidence found and/or method applied in restoring or reestablishing corner:

H-7 Found standard Kent Co. Mon. (Harrison) per witnesses from above LCRC as set by John A. Merdzinski in place of the 3/4" Iron Pipe and 1/2" Iron Pipe he found inside a Mon. Box. Both Irons check with Kent Co. Wit. and LCRC #120.

LCRC #1593 (Nail/tag in trees).

LCRC #6090 (Nail/tag in trees)

22" Oak N40°E 33.49'	20" Oak S60°E 59.79'	12" Cottonwood N08°W 32.59'
8" Cottonwood N10°W 32.61'		22" Oak N38°E 33.35'
18" Oak S20°E 22.89'		18" Oak S22°E 22.78'
22" Oak S50°W 34.65'		Tw. 20" Oak S60°E 59.38'
NW cor. gar. fnd. S05°E 74.05'		NW cor. gar. fnd. S05°E 70.04'
		24" Oak S47°W 34.60'

The selected location is accepted by me and is generally accepted by professional surveyors as the best available evidence of the position of the original corner.

C. Description of monument for corner and accessories established to perpetuate locating the position of the corner:

H-7 Standard Kent County Monument in Mon. Box

Nail & KC Remon. tag W. side 14" Cottonwood	N08°W	32.59'
Nail & KC Remon. tag W. side 24" Oak	N38°E	33.35'
Nail & KC Remon. tag NE side Twin 22" Oak	S60°E	59.44'
Nail & KC Remon. tag W. side 20" Oak	S22°E	22.82'
NW corner garage foundation	S05°E	74.07'
Nail & KC Remon. tag W. side 26" Oak	S47°W	34.62'

C/L 36th St. is North 2'±
On tree row N-S

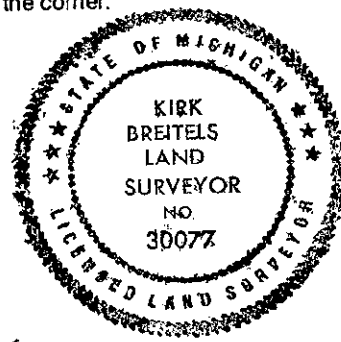

Signed by Kirk Breitels
Surveyor's Michigan License No. 30077

Date 3/1/96