

SURVEY & REMONUMENTATION

FEB 14 1997

KENT COUNTY REMONUMENTATION

COMMISSION LAND CORNER RECORDATION CERTIFICATE
Filing Requirement of Act 74, Mich. P.A. 1970

STATE OF MICHIGAN
COUNTY OF KENT
RECEIVED FOR RECORD
96 MAR 20 AM 8:46
REG. OF DEEDS
Lucy Spauld

For corners in
KENT COUNTY
(County)

Located In:	Corner Code #
1. Public Land Survey	T 6N R 10W H-11
	T R
	T R
	T R
2. Property Controlling in Section	S T R
	S T R
3. Miscellaneous Property in Sec.	S T R
	S T R

8977
Register of Deeds Stamp & File Number

4. Lot No. _____, Recorded Plat _____
5. Private Claims _____

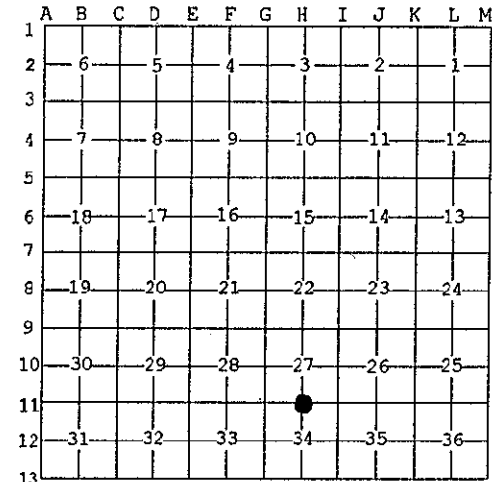

I, Kirk Breitels, in a field survey on Feb. 19, 1996 do hereby state that under requirements of P.A. 74, Michigan P.A. of 1970, the corner points mentioned in lines 1 and 2 above were in conformance with regulations and rules therefore as required in the current manual of survey instructions of the United States Department of the Interior, Bureau of Land Management or by a decree of a Court of Law and /or that the corner points mentioned in lines 3, 4 and 5 above were in conformance with the rules of the Michigan Board of Land Surveyors or by a Decree of a Court of Law; established, re-established, monumented, recovered, found as expressed below:

NOTE: Not more than 2 corners, all in the same town and range, may be recorded on this certificate.

A. Description of original monument and accessories and/or subsequent restoration:

H-11	1831	GLO	Mullett	Set Post
		Kent Co. Wit.		Iron
	1973	LCRC #429	VanKooten	1 1/2" Iron
	1982	LCRC #2739	Merdzinski	Set Kent County Monument
	1991	LCRC #6092	Unema	Kent County Monument

P.A. 345 1990 KENT COUNTY
PEER APPROVED 3/7/96
CHAIRMAN *Harry Huber*

The position of this corner was previously approved by the Kent County Remonumentation Peer Group, monumented by John A. Merdzinski on 2/16/82 and was recorded per LCRC #2739

B. Description of corner evidence found and/or method applied in restoring or reestablishing corner:
H-11 Found standard Kent Co. Mon. (Harrison) per witnesses from above LCRC as set by John A. Merdzinski in place of the 1 1/2" Iron he found in a ring of stones. Said Iron checks with Kent Co. Wit. and LCRC #429.

LCRC #2739	LCRC #6092
Nail/tag 12" Oak N45°E 55.95'	Same witnesses ± as LCRC #2739
Nail/tag 28" Oak S75°E 9.83'	
Nail/tag 14" Oak S35°E 24.57'	
Nail/tag 6" Oak S10°E 39.54'	
Nail/tag 12" Oak West 18.68'	

The selected location is accepted by me and is generally accepted by professional surveyors as the best available evidence of the position of the original corner.

C. Description of monument for corner and accessories established to perpetuate locating the position of the corner:

H-11 Standard Kent County Monument

Nail & KC Remon. tag E. side 8" Oak	S02°W	39.51'
Nail & KC Remon. tag S. side 15" Oak	N86°W	18.64'
Nail & KC Remon. tag SW side 36" Oak	S65°E	9.83'
Nail & KC Remon. tag SW side 20" Oak	S24°E	24.61'
Nail & KC Remon. tag SE side 14" Oak	N45°E	55.94'
At approx. fence corner South & East		

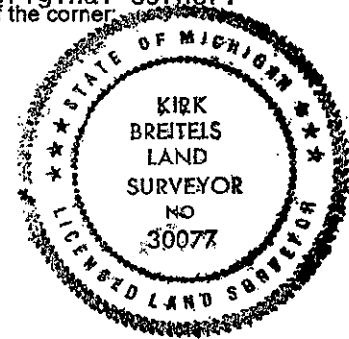

Signed by *Kirk Breitels*
Surveyor's Michigan License No. 30077

Date 3/1/96