

SURVEY & REMONUMENTATION

KENT COUNTY REMONUMENTATION

FEB 14 1997

LAND CORNER RECORDATION CERTIFICATE
Filing Requirement of Act 74, Mich. P.A. 1970

For corners in **COMMISSION**
KENT COUNTY

(County)	Located In:	Corner Code #
1. Public Land Survey	T6N R10W	I-1
	T R	
	T R	
	T R	
	T R	
2. Property Controlling in Section	S T R	
	S T R	
3. Miscellaneous Property in Sec.	S T R	
	S T R	

STATE OF MICHIGAN
COUNTY OF KENT
RECEIVED FOR RECORD

95 SEP 13 PM 12:07

REG. OF DEEDS

Lucy St. Louis

9382

Register of Deeds Stamp & File Number

4. Lot No. _____, Recorded Plat _____
5. Private Claims _____

I, Kirk Breitels, in a field survey on July 26, 1996 do hereby state that under requirements of P.A. 74, Michigan P.A. of 1970, the corner points mentioned in lines 1 and 2 above were in conformance with regulations and rules therefore as required in the current manual of survey instructions of the United States Department of the Interior, Bureau of Land Management or by a decree of a Court of Law and/or that the corner points mentioned in lines 3, 4 and 5 above were in conformance with the rules of the Michigan Board of Land Surveyors or by a Decree of a Court of Law; established, re-established, monumented, recovered, found as expressed below:

NOTE: Not more than 2 corners, all in the same town and range, may be recorded on this certificate.

	A	B	C	D	E	F	G	H	I	J	K	L	M
1													
2	6		5		4		3		2		1		
3													
4	7		8		9		10		11		12		
5													
6	13		17		16		15		14		13		
7													
8	19		20		21		22		23		24		
9													
10	30		29		28		27		26		25		
11													
12	31		32		33		34		35		36		
13													

A. Description of original monument and accessories and/or subsequent restoration:

I-1	1831	GLO	Mullett	Set Post
	1971	Kent Co. Wit.	Chambers	1" Iron
	1978	LCRC #47	Bonnema	1" Iron
	1989	LCRC #1165	Bueche	1" Pinched Iron
	1994	LCRC #5069	J. Glaza	Set Kent County Monument
		LCRC #8066		Kent County Monument

P.A. 345 1990 KENT COUNTY
PEER APPROVED 8/22/96
CHAIRMAN *Henry Huber*

The position of this corner was previously approved by the Kent County Remonumentation Peer Group, monumented by John C. Bueche on 4/7/89 and was recorded per LCRC #5069

B. Description of corner evidence found and/or method applied in restoring or reestablishing corner:

I-1 Found standard Kent Co. Mon. (Harrison) per witnesses from above LCRC as set by John C. Bueche on Twp. Line in place of the 1" x 18" Iron he found. Said Iron checks with Kent Co. Wit. LCRC #47 and #1165

LCRC #5069	LCRC #8066 (Nail/tag in tree-pole)
Nail/tag P. Pole S20°E 96.10'	24" Maple West 32.77' P. Pole S18°E 189.30'
Nail/tag 12" Oak S60°W 19.42'	C/L RR track N45°E 26.00'
Nail/tag 24" Oak West 32.80'	KC Mon. (I-13, 7-10) East 67.82'
C/L RR track N45°E 26.00'	SW cor. brick to porch of bldg. N70°E 142.39'
KC Mon. (I-13, 7-10) East 67.82'	SW'ly cor. brick wall N16°E 105.83'

The selected location is accepted by me and is generally accepted by professional surveyors as the best available evidence of the position of the original corner.

C. Description of monument for corner and accessories established to perpetuate locating the position of the corner:

I-1 Standard Kent County Monument	
Nail & KC Remon. tag S. side 24" Maple	West 32.79'
C/L RR track	N45°E 26.00'
Kent Co. Mon. (I-13, T7N, R10W)	East 67.82'
SW cor. brick porch to bldg. (at grade)	N70°E 142.49'
Nail & KC Remon. tag E. side P. Pole	S18°E 189.30'
SW'ly cor. brick wall (4' high)	N16°E 105.97'

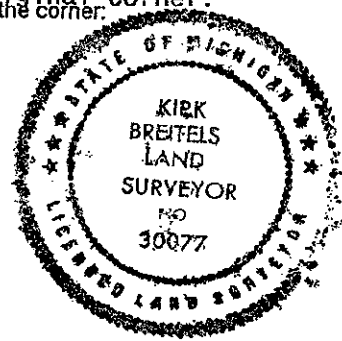

Signed by *Kirk Breitels*
Surveyor's Michigan License No. 30077

Date 8/25/96