

FEB 14 1997

COMMISSION

KENT COUNTY REMONUMENTATION

LAND CORNER RECORDATION CERTIFICATE  
Filing Requirement of Act 74, Mich. P.A. 1970

For corners in

KENT COUNTY

(County)

Located In:

Corner Code #

1. Public Land Survey

T 6N R 10W

I-9

T R

T R

T R

2. Property Controlling in Section

S T R

S T R

3. Miscellaneous

S T R

Property in Sec.

S T R

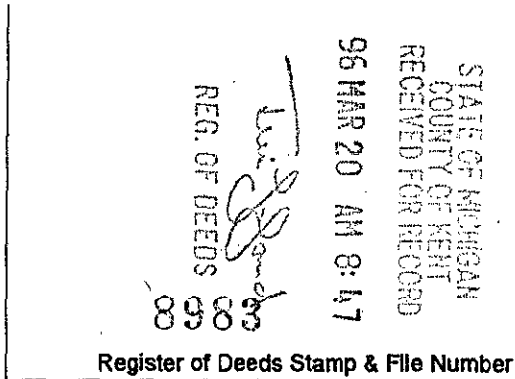

4. Lot No. \_\_\_\_\_, Recorded Plat \_\_\_\_\_  
5. Private Claims \_\_\_\_\_

I, Kirk Breitels, in a field survey on Feb. 19, 1996 do hereby state that under requirements of P.A. 74, Michigan P.A. of 1970, the corner points mentioned in lines 1 and 2 above were in conformance with regulations and rules therefore as required in the current manual of survey instructions of the United States Department of the Interior, Bureau of Land Management or by a decree of a Court of Law and/or that the corner points mentioned in lines 3, 4 and 5 above were in conformance with the rules of the Michigan Board of Land Surveyors or by a Decree of a Court of Law; established, re-established, monumented, recovered, found as expressed below:

NOTE: Not more than 2 corners, all in the same town and range, may be recorded on this certificate.

Grid with columns A-M and rows 1-13. A dot is marked at the intersection of column I and row 9.

A. Description of original monument and accessories and/or subsequent restoration:

Table with columns: I-9, Year, Description, Name, Monument Type. Includes entries for 1831 GLO Mullett Set Post, 1939 Kent Co. Wit. Iron, 1972 LCRC #153 Bonnema 1" Iron, 1981 LCRC #1628 Byl 3/4" Iron, 1982 LCRC #2741 Merdzinski Set Kent County Monument, 1991 LCRC #6077 Unema Kent County Monument.

P.A. 345 1990 KENT COUNTY  
PEER APPROVED 3/7/96  
CHAIRMAN *[Signature]*

The position of this corner was previously approved by the Kent County Remonumentation Peer Group, monumented by John A. Merdzinski on 2/9/82 and was recorded per LCRC #2741

B. Description of corner evidence found and/or method applied in restoring or reestablishing corner:

I-9 Found standard Kent Co. Mon. (Harrison) per witnesses from above LCRC as set by John A. Merdzinski in place of the Iron he found in a stone pile. Said Iron checks with Kent Co. Wit. and LCRC's #153, #1628.

LCRC #2741 Same witnesses ± as LCRC #2741  
LCRC #6077

- Nail/tag 22" Oak North 8.40'
- Nail/tag 24" Oak East 34.7'
- Nail/tag 26" Oak S35°E 6.10'
- Nail/tag 12" Oak S30°W 7.67'

On remains of E-W fence & tree row N.

The selected location is accepted by me and is generally accepted by professional surveyors as the best available evidence of the position of the original corner.

C. Description of monument for corner and accessories established to perpetuate locating the position of the corner:

- I-9 Standard Kent County Monument
- Nail & KC Remon. tag E. side 26" Oak North 8.41'
- Nail & KC Remon. tag S. side 30" Oak East 34.71'
- Nail & KC Remon. tag NE side 34" Oak S35°E 6.16'
- Nail & KC Remon. tag NW side 14" Oak S30°W 7.61'
- Corner is in remains of fence E-W and in tree row N.

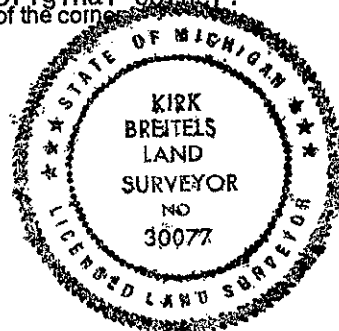

Signed by *[Signature]*  
Surveyor's Michigan License No. 30077

Date 3/1/96