

SURVEY & REMONUMENTATION

FEB 14 1997

KENT COUNTY REMONUMENTATION

COMMISSION

LAND CORNER RECORDATION CERTIFICATE
Filing Requirement of Act 74, Mich. P.A. 1970

For corners in
KENT COUNTY

(County)

Located In:

Corner Code #

1. Public Land Survey	T 6N R 10W	K-12
	T R	
	T R	
	T R	
2. Property Controlling in Section	S T R	
	S T R	
3. Miscellaneous Property in Sec.	S T R	
	S T R	

REG. OF DEEDS

Handwritten signature

96 MAR 20 AM 8:47

STATE OF MICHIGAN
COUNTY OF KENT
RECEIVED FOR RECORD

8995

Register of Deeds Stamp & File Number

4. Lot No. _____, Recorded Plat _____
5. Private Claims _____

I, Kirk Breitels, in a field survey on Feb. 19, 1996 do hereby state that under requirements of P.A. 74, Michigan P.A. of 1970, the corner points mentioned in lines 1 and 2 above were in conformance with regulations and rules therefore as required in the current manual of survey instructions of the United States Department of the Interior, Bureau of Land Management or by a decree of a Court of Law and/or that the corner points mentioned in lines 3, 4 and 5 above were in conformance with the rules of the Michigan Board of Land Surveyors or by a Decree of a Court of Law; established, re-established, monumented, recovered, found as expressed below:

NOTE: Not more than 2 corners, all in the same town and range, may be recorded on this certificate.

A	B	C	D	E	F	G	H	I	J	K	L	M
1												
2	6	5	4	3	2	1						
3												
4	7	8	9	10	11	12						
5												
6	18	17	16	15	14	13						
7												
8	19	20	21	22	23	24						
9												
10	30	29	28	27	26	25						
11												
12	31	32	33	34	35	36						
13												

P.A. 345 1990 KENT COUNTY

PEER APPROVED 3/7/96
CHAIRMAN *Handwritten signature*

A. Description of original monument and accessories and/or subsequent restoration:

K-12 1831 GLO	Mullett	Set Post
1963 Kent Co. Wit.		Stake at fence cor.
1978 LCRC #1206	Jonker	"T" Iron at fence cor.
1982 LCRC #2752	Merdzinski	Set Kent County Monument
1991 LCRC #6103	Unema	Kent County Monument

The position of this corner was previously approved by the Kent County Remonumentation Peer Group, monumented by John A. Merdzinski on 2/22/82 and was recorded per LCRC #2752

B. Description of corner evidence found and/or method applied in restoring or reestablishing corner:

K-12 Found standard Kent Co. Mon. (Harrison) per witnesses from above LCRC as set by John A. Merdzinski in place of the "T" Iron he found at remains of fence corner. Said "T" Iron checks with Kent Co. Wit. and LCRC #1206

LCRC #2752	LCRC #6103
Nail/tag 16" Maple N15°W 40.55'	Nail/tag 24" Maple S70°E 21.00'
Nail/tag 20" Maple S85°E 21.00'	Nail/tag 22" Beech S55°W 20.63'
Nail/tag 14" Maple S55°E 24.00'	Nail/tag 14" Maple S45°E 24.10'
Nail/tag 20" Beech S45°W 20.69'	Nail/tag 22" Oak N84°W 50.72'
Nail/tag 18" Oak West 50.73'	Nail/tag 16" Tri. Oak N15°W 69.69'

The selected location is accepted by me and is generally accepted by professional surveyors as the best available evidence of the position of the original corner.

C. Description of monument for corner and accessories established to perpetuate locating the position of the corner:

K-12 Standard Kent County Monument	
Nail & KC Remon. tag S. side 26" Maple	S70°E 21.00'
Nail & KC Remon. tag SE side 24" Beech	S55°W 20.65'
Nail & KC Remon. tag S. side 16" Maple	S45°E 24.07'
Nail & KC Remon. tag S. side 24" Oak	N84°W 50.72'
Nail & KC Remon. tag E. side Tri. 16" Oak	N15°W 69.69'
S. edge Asph Dr. E-W is N. 13.7'±	
On remains of fence E-W and on tree row E-W	

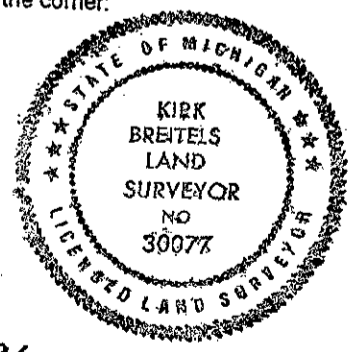

Signed by *Kirk Breitels*
Surveyor's Michigan License No. 30077

Date 3/1/96