

**SURVEY & REMONUMENTATION**

FEB 14 1997

**COMMISSION**

**KENT COUNTY REMONUMENTATION**

**LAND CORNER RECORDATION CERTIFICATE**  
Filing Requirement of Act 74, Mich. P.A. 1970

For corners in  
**KENT COUNTY**  
(County)

Located In:	Corner Code #
T 6N R 10W	M-7
T R	
T R	
T R	
T R	
S T R	
S T R	
S T R	
S T R	

- 1. Public Land Survey
- 2. Property Controlling in Section
- 3. Miscellaneous Property in Sec.

STATE OF MICHIGAN  
COUNTY OF KENT  
RECEIVED FOR RECORD

96 MAR 20 AM 8:48

REG. OF DEEDS

*Lucy Bond*

**9006**

Register of Deeds Stamp & File Number

4. Lot No. \_\_\_\_\_, Recorded Plat \_\_\_\_\_  
5. Private Claims \_\_\_\_\_

I, Kirk Breitels, in a field survey on Feb. 1, 1996 do hereby state that under requirements of P.A. 74, Michigan P.A. of 1970, the corner points mentioned in lines 1 and 2 above were in conformance with regulations and rules therefore as required in the current manual of survey instructions of the United States Department of the Interior, Bureau of Land Management or by a decree of a Court of Law and/or that the corner points mentioned in lines 3, 4 and 5 above were in conformance with the rules of the Michigan Board of Land Surveyors or by a Decree of a Court of Law, established, re-established, monumented, recovered, found as expressed below:

NOTE: Not more than 2 corners, all in the same town and range, may be recorded on this certificate.

	A	B	C	D	E	F	G	H	I	J	K	L	M
1													
2	6		5		4		3		2		1		
3													
4	7		8		9		10		11		12		
5													
6	18		17		16		15		14		13		
7													
8	19		20		21		22		23		24		
9													
10	30		29		28		27		26		25		
11													
12	31		32		33		34		35		36		
13													

A. Description of original monument and accessories and/or subsequent restoration:

M-7	1831	GLO	Mullett	Set Post
	1964	Kent Co. Wit.		Mon. Box
	1978	LCRC #1141	VanKooten	1/2" Round Iron in Mon. Box
	1981	LCRC #1991	Jonker	Set Kent County Monument in Mon. Box
	1991	LCRC #6064	Unema	Kent County Monument in Mon. Box

P.A. 345 1900 KENT COUNTY

PEER APPROVED 3/7/96  
CHAIRMAN *Harry Huber*

The position of this corner was previously approved by the Kent County Remonumentation Peer Group, monumented by Robert J. Jonker on 8/14/81 and was recorded per LCRC #1991

B. Description of corner evidence found and/or method applied in restoring or reestablishing corner:

M-7 Found standard Kent Co. Mon. (Harrison) per witnesses from above LCRC as set by Robert J. Jonker in place of the 1/2" Iron he found inside a Mon. Box. Said Iron checks with Kent Co. Wit. and LCRC #1141.

LCRC #1991	LCRC #6064
Nail/tag 36" Maple S75°E 67.70'	Nail/tag P. Pole S37°E 59.07' Kent Co. Mon.
Nail/tag P&T Pole S39°E 59.30'	Nail/tag 40" Maple S74°E 67.71' (A-7, 6-9)
Nail/tag Tri. 8" Will. N43°W 57.79'	Nail/tag 12" Maple N70°E 99.02' North 23.69'
Iron in Mon. Box N05°E 23.72'	Nail/tag 38" Willow N43°W 57.86'
	Nail/tag 18" Walnut N17°W 97.33'

The selected location is accepted by me and is generally accepted by professional surveyors as the best available evidence of the position of the original corner.

C. Description of monument for corner and accessories established to perpetuate locating the position of the corner:

M-7 Standard Kent County Monument in Mon. Box	
Nail & KC Remon. tag SW side P. Pole	S37°E 59.04'
Nail & KC Remon. tag N. side 44" Maple	S74°E 67.73'
Nail & KC Remon. tag S. side 15" Maple	N70°E 99.02'
New Nail & KC Remon. tag SW side 40" Willow	N43°W 57.05'
Nail & KC Remon. tag E. side 20" Walnut	N17°W 97.33'
Nail & KC Remon. tag N. side 36" Maple	S85°E 110.95'
Kent Co. Mon. (A-7, T6N, R9W)	North 23.69'
On C/L "X" pavement ±	

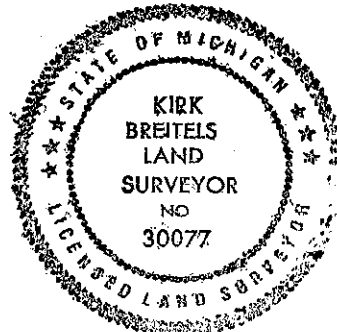

Signed by *Kirk Breitels*  
Surveyor's Michigan License No. 30077

Date 3/1/96