

**SURVEY & REMONUMENTATION**

FEB 14 1997

**KENT COUNTY REMONUMENTATION**

**COMMISSION**

**LAND CORNER RECORDATION CERTIFICATE**  
Filing Requirement of Act 74, Mich. P.A. 1970

For corners in  
**KENT COUNTY**

Located In:	Corner Code #
1. Public Land Survey	M-8
T 6N R 10W	
T R	
T R	
T R	
2. Property Controlling in Section	
S T R	
S T R	
3. Miscellaneous Property in Sec.	
S T R	
S T R	

REG. OF DEEDS

*Lucy Bond*

96 MAR 20 AM 8:48

STATE OF MICHIGAN  
COUNTY OF KENT  
RECEIVED FOR RECORD

**9007**

Register of Deeds Stamp & File Number

4. Lot No. \_\_\_\_\_, Recorded Plat \_\_\_\_\_  
5. Private Claims \_\_\_\_\_

I, Kirk Breitels, in a field survey on Feb. 8, 1996 do hereby state that under requirements of P.A. 74, Michigan P.A. of 1970, the corner points mentioned in lines 1 and 2 above were in conformance with regulations and rules therefore as required in the current manual of survey instructions of the United States Department of the Interior, Bureau of Land Management or by a decree of a Court of Law and for that the corner points mentioned in lines 3, 4 and 5 above were in conformance with the rules of the Michigan Board of Land Surveyors or by a Decree of a Court of Law, established, re-established, monumented, recovered, found as expressed below:

NOTE: Not more than 2 corners, all in the same town and range, may be recorded on this certificate.

	A	B	C	D	E	F	G	H	I	J	K	L	M
1													
2	6	5	4	3	2	1							
3													
4	7	8	9	10	11	12							
5													
6	18	17	16	15	14	13							
7													
8	19	20	21	22	23	24							
9													
10	30	29	28	27	26	25							
11													
12	31	32	33	34	35	36							
13													

A. Description of original monument and accessories and/or subsequent restoration:

M-8	1831	GLO	Mullett	Set Post
		Kent Co. Wit.		RR Spike
1974	LCRC #669		VanKooten	RR Spike
1978	LCRC #1141		VanKooten	1/2" Round Iron
1981	LCRC #1992		Jonker	Set Kent County Monument
1988	LCRC #4902		Chettleburgh	Kent County Monument
1991	LCRC #6065		Unema	Kent County Monument

P.A. 345 1990 KENT COUNTY  
PEER APPROVED 3/7/96  
CHAIRMAN *Harry Stuber*

The position of this corner was previously approved by the Kent County Remonumentation Peer Group, monumented by Robert J. Jonker on 8/14/81 and was recorded per LCRC #1992

B. Description of corner evidence found and/or method applied in restoring or reestablishing corner:

M-8 Found standard Kent Co. Mon. (Harrison) per witnesses from above LCRC as set by Robert J. Jonker in place of the 1/2" Round Iron over a 3/4" Round Iron he found. Both Irons check with LCRC #1141. Witnesses from Kent Co. Wit. and LCRC #669 were gone.  
LCRC #1992

	LCRC #4902 & #6065 (Nail/tag)
Nail/tag 9" Elm N66°W 25.71'	10" Elm N54°E 48.68'
Nail/tag Fc. Post N38°W 51.46'	9" Elm S75°E 30.16'
Nail/tag Fc. Post S88°E 33.43'	Fc. Post S88°E 33.56'
Nail/tag 9" Elm S23°E 73.51'	KC Mon. North 16.01'
Iron - North 15.94'	12" Tw. Elm S10°E 127.08'
	Multi-Elm N05°W 186.32'
	Fc. Post N38°W 51.50'

The selected location is accepted by me and is generally accepted by professional surveyors as the best available evidence of the position of the original corner.

C. Description of monument for corner and accessories established to perpetuate locating the position of the corner:

M-8 Standard Kent County Monument	
Nail & KC Remon. tag NE side fence post	N38°W 51.50'
Nail & KC Remon. tag NW side 14" Elm	N55°E 48.74'
Nail & KC Remon. tag E. side Multi Elm	N05°W 186.32'
Nail & KC Remon. tag W. side Twin 14" Elm	S10°E 127.14'
Set Nail & KC Remon. tag SW side fence post	S70°E 35.03'
Kent Co. Mon. (A-8, T6N, R9W)	North 16.04'
On old fence to East ± and tree row to West ±	

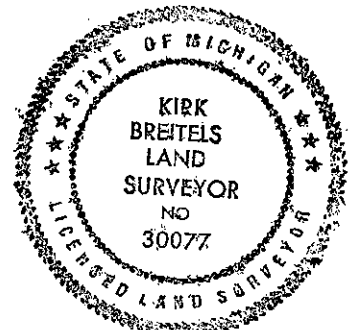

igned by *Kirk Breitels*

Date 3/1/96

urveyor's Michigan License No. 30077