

**SURVEY & REMONUMENTATION**

**KENT COUNTY REMONUMENTATION**

FEB 14 1997

**LAND CORNER RECORDATION CERTIFICATE**  
Filing Requirement of Act 74, Mich. P.A. 1970

For corners in  
**KENT COUNTY**

**COMMISSION**

STATE OF MICHIGAN  
 COUNTY OF KENT  
 RECEIVED FOR RECORD  
 96 MAR 20 AM 8:48  
 REG. OF DEEDS  
*Lucy Stand*

Located In:	Corner Code #
1. Public Land Survey	T 6N R 10W M-9
	T R
	T R
	T R
	T R
2. Property Controlling in Section	S T R
	S T R
3. Miscellaneous Property in Sec.	S T R
	S T R

**9008**

Register of Deeds Stamp & File Number

4. Lot No. \_\_\_\_\_, Recorded Plat \_\_\_\_\_  
 5. Private Claims \_\_\_\_\_

I, Kirk Breitels, in a field survey on Feb. 8, 1996 do hereby state that under requirements of P.A. 74, Michigan P.A. of 1970, the corner points mentioned in lines 1 and 2 above were in conformance with regulations and rules therefore as required in the current manual of survey instructions of the United States Department of the Interior, Bureau of Land Management or by a decree of a Court of Law and for that the corner points mentioned in lines 3, 4 and 5 above were in conformance with the rules of the Michigan Board of Land Surveyors or by a Decree of a Court of Law; established, re-established, monumented, recovered, found as expressed below:

NOTE: Not more than 2 corners, all in the same town and range, may be recorded on this certificate.

1	A	B	C	D	E	F	G	H	I	J	K	L	M
2		6	5		4		3		2		1		
3													
4		7	8		9		10		11		12		
5													
6		18	17		16		15		14		13		
7													
8		19	20		21		22		23		24		
9													
10		30	29		28		27		26		25		
11													
12		31	32		33		34		35		36		
13													

**A. Description of original monument and accessories and/or subsequent restoration:**

M-9	1831	GLO	Mullett	Set Post
	1939	Kent Co. Wit.		"X" in pvmnt. - PK Nail
	1972	LCRC #321	Spicer	PK Nail
	1982	LCRC #2755	Merdzinski	Set Kent County Monument
	1991	LCRC #6066	Unema	Kent County Monument

P.A. 345 1990 KENT COUNTY

PEER APPROVED 3/7/96  
 CHAIRMAN *Harry Huber*

The position of this corner was previously approved by the Kent County Remonumentation Peer Group, monumented by John A. Merdzinski on 3/26/82 and was recorded per LCRC #2755

**B. Description of corner evidence found and/or method applied in restoring or reestablishing corner:**

M-9 Found standard Kent Co. Mon. (Harrison) per witnesses from above LCRC as set by John A. Merdzinski in place of the PK Nail he found. Said PK Nail checks with Kent Co. Wit. and LCRC #321.

<u>LCRC #2755</u>	<u>LCRC #6066</u>
C/L pavement - South 2.6'	PK Nail top curb head N39°W 35.14'
NE cor. hse. S50°W 101.35'	C/L pavement South 2.6'
NE cor. hse. S50°E 113.80'	NE cor. house S48°W 101.33'
Nail/tag Fc. Post N40°E 58.87'	NE cor. house S45°E 113.82'
Nail/tag sign post N35°W 52.65'	Nail/tag Serv. Pole S10°E 87.67'

The selected location is accepted by me and is generally accepted by professional surveyors as the best available evidence of the position of the original corner.

**C. Description of monument for corner and accessories established to perpetuate locating the position of the corner:**

M-9 Standard Kent County Monument	
Set Nail & KC Remon. tag SW side RR tie fence post	N45°W 45.55'
NE corner of house	S48°W 101.33'
NE corner of house	S45°E 113.82'
Nail & KC Remon. tag W. side Serv. Pole	S10°E 87.72'
C/L pavement (Cascade Rd.) is South 2.6'	
On C/L road N-S ± (Snow Ave.)	

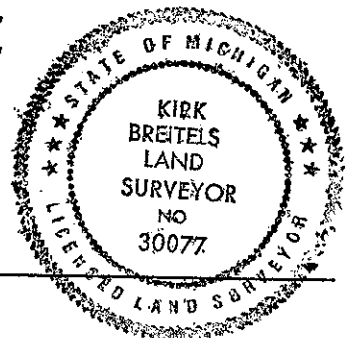

Signed by *Kirk Breitels*  
 Surveyor's Michigan License No. 30077

Date 3/1/96