

REMONUMENTATION

FEB 14 1997

KENT COUNTY REMONUMENTATION

COMMISSION

LAND CORNER RECORDATION CERTIFICATE
Filing Requirement of Act 74, Mich. P.A. 1970

For corners in

KENT COUNTY

(County)

Located in:

Corner Code #

1. Public Land Survey

T 6N R 10W

M-11 ✓

T 6N R 9W

A-11

T R

T R

2. Property Controlling in Section

S T R

S T R

3. Miscellaneous

S T R

Property in Sec.

S T R

REG. OF DEEDS

Lucy Bond

96 JUN -7 AM 8:28

STATE OF MICHIGAN
COUNTY OF KENT
RECEIVED FOR RECORD

9173

Register of Deeds Stamp & File Number

4. Lot No. _____, Recorded Plat _____
5. Private Claims _____

I, Kirk Breitels, in a field survey on Apr. 3, 19 96 do hereby state that under requirements of P.A. 74, Michigan P.A. of 1970, the corner points mentioned in lines 1 and 2 above were in conformance with regulations and rules therefore as required in the current manual of survey instructions of the United States Department of the Interior, Bureau of Land Management or by a decree of a Court of Law and/or that the corner points mentioned in lines 3, 4 and 5 above were in conformance with the rules of the Michigan Board of Land Surveyors or by a Decree of a Court of Law, established, re-established, monumented, recovered, found as expressed below:

NOTE: Not more than 2 corners, all in the same town and range, may be recorded on this certificate.

1	A	B	C	D	E	F	G	H	I	J	K	L	M
2		6		5		4		3		2		1	
3													
4		7		8		9		10		11		12	
5													
6		18		17		16		15		14		13	
7													
8		19		20		21		22		23		24	
9													
10		30		29		28		27		26		25	
11													
12		31		32		33		34		35		36	
13													

A. Description of original monument and accessories and/or subsequent restoration:

M-11	1831	GLO	Mullett	Set Post
	1959	Kent Co. Wit.		Conc. Mon.
	1983	LCRC #3323	Stadt	Conc. Mon.
	1983	LCRC #3608	Kolehouse	Set Kent County Monument
	1991	LCRC #6052	Unema	Kent County Monument

P.A. 345 1990 KENT COUNTY

PEER APPROVED 5/30/96
CHAIRMAN *[Signature]*

The position of this corner was previously approved by the Kent County Remonumentation Peer Group, monumented by Randy J. Kolehouse on 10/29/83 and was recorded per LCRC #3608

B. Description of corner evidence found and/or method applied in restoring or reestablishing corner:

M-11 Found standard Kent Co. Mon. (Harrison) per witnesses from above LCRC as set by Randy J. Kolehouse in place of the Conc. Mon. he found. Said Conc. Mon. checks with Kent Co. Wit. and LCRC #3323

LCRC #3608	Nail/tag 16" Hickory	S40°W	32.45'	LCRC #6052	Nail/tag 18" Hickory	S40°W	32.65'
	Nail/tag P. Pole	S25°E	58.20'		Nail/tag 6" Elm clump	N12°W	91.12'
	Nail/tag P. Pole	N10°E	141.60'		Nail/tag P. Pole	S20°E	58.21'
	C/L stop sign post	N20°W	42.65'		Nail/tag P. Pole	N11°E	141.55'

The selected location is accepted by me and is generally accepted by professional surveyors as the best available evidence of the position of the original corner.

C. Description of monument for corner and accessories established to perpetuate locating the position of the corner.

M-11 Standard Kent County Monument

Nail & KC Remon. tag NW side	20" Hickory	S40°W	32.65'
Nail & KC Remon. tag E. side	6" Elm clump	N12°W	91.20'
Nail & KC Remon. tag W. side	P. Pole	S20°E	58.21'
Nail & KC Remon. tag W. side	P. Pole	N11°E	141.60'
C/L 52nd is 2.8' N.			
C/L gravel (Snow Ave.) is 4' E.			

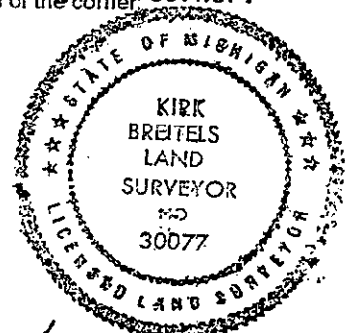

Signed by *[Signature]*
Surveyor's Michigan License No. 30077

Date 4/19/96