

SURVEY & REMONUMENTATION

FEB 14 1997

KENT COUNTY REMONUMENTATION

COMMISSION

LAND CORNER RECORDATION CERTIFICATE
Filing Requirement of Act 74, Mich. P.A. 1970

For corners in
KENT COUNTY

Located In:	Corner Code #
T 6N R 10W	M-13
T 5N R 10W	M-1
T 6N R 9W	A-13
T 5N R 9W	A-1
S _____ T _____ R _____	_____
S _____ T _____ R _____	_____
S _____ T _____ R _____	_____
S _____ T _____ R _____	_____

1. Public Land Survey

2. Property Controlling in Section

3. Miscellaneous Property in Sec.

4. Lot No. _____, Recorded Plat _____
5. Private Claims _____

STATE OF MICHIGAN
COUNTY OF KENT
RECEIVED FOR RECORD

96 MAR 20 AM 8:48

REG. OF DEEDS

Lucy Standa

9010

Register of Deeds Stamp & File Number

I, Kirk Breitels, in a field survey on Feb. 1, 1996 do hereby state that under requirements of P.A. 74, Michigan P.A. of 1970, the corner points mentioned in lines 1 and 2 above were in conformance with regulations and rules therefore as required in the current manual of survey instructions of the United States Department of the Interior, Bureau of Land Management or by a decree of a Court of Law and /or that the corner points mentioned in lines 3, 4 and 5 above were in conformance with the rules of the Michigan Board of Land Surveyors or by a Decree of a Court of Law; established, re-established, monumented, recovered, found as expressed below:

NOTE: Not more than 2 corners, all in the same town and range, may be recorded on this certificate.

	A	B	C	D	E	F	G	H	I	J	K	L	M
1													
2	6		5		4		3		2		1		
3													
4	7		8		9		10		11		12		
5													
6	18		17		16		15		14		13		
7													
8	19		20		21		22		23		24		
9													
10	30		29		28		27		26		25		
11													
12	31		32		33		34		35		36		
13													

A. Description of original monument and accessories and/or subsequent restoration:

M-13	1831	GLO	Mullett	Set Post	P.A. 345 1990 KENT COUNTY
	1941	Kent Co. Wit.		3/4" Iron	PEER APPROVED 3/7/96
	1974	LCRC #722	VanKooten	3/4" Iron	CHAIRMAN <i>Harry Huber</i>
	1978	LCRC #1137	VanKooten	3/4" Iron	
	1981	LCRC #1695	Merdzinski	Set Kent County Monument	
	1991	LCRC #6069	Unema	Kent County Monument	

The position of this corner was previously approved by the Kent County Remonumentation Peer Group, monumented by John A. Merdzinski on 2/20/81 and was recorded per LCRC #1695

B. Description of corner evidence found and/or method applied in restoring or reestablishing corner:

M-13 Found standard Kent Co. Mon. (Harrison) per witnesses from above LCRC as set by John A. Merdzinski in place of the 3/4" Iron over another 3/4" Iron he found. Both Irons check with Kent Co. Wit. and LCRC's #722, 1137.

LCRC #1695 (Nail/tag in trees-poles)	LCRC #6069
48" Oak N80°E 160.29'	PP N50°W 114.54'
40" Oak S70°E 104.23'	PP S60°W 98.36'
40" Oak S60°E 65.81'	PP N60°E 142.91'
Fc. Post S50°W 45.21'	same witnesses ±
40" Oak N75°W 136.11'	

The selected location is accepted by me and is generally accepted by professional surveyors as the best available evidence of the position of the original corner.

C. Description of monument for corner and accessories established to perpetuate locating the position of the corner:

M-13 Standard Kent County Monument

Nail & KC Remon. tag NW side	50" Oak	N83°E	160.11'
Nail & KC Remon. tag N. side	40" Oak	S71°E	104.16'
Nail & KC Remon. tag NE side	42" Oak	S62°E	65.76'
Nail & KC Remon. tag S. side	41" Oak	N70°W	136.00'
Nail & KC Remon. tag SE side	Fc. Post	S50°W	45.35'
Nail & KC Remon. tag S. side	P. Pole	N53°W	114.54'
Nail & KC Remon. tag S. side	P. Pole	S74°W	98.30'
Nail & KC Remon. tag NW side	P. Pole	N65°E	142.75'

C/L "X" Snow Ave. and 60th St. is South 1'±

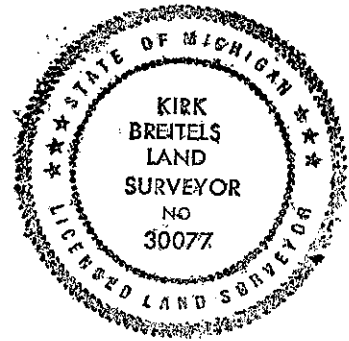

Signed by *Kirk Breitels*

Date 3/1/96

Surveyor's Michigan License No. 30077