

SURVEY & REMONUMENTATION
FEB 14 1997
COMMISSION

KENT COUNTY REMONUMENTATION
LAND CORNER RECORDATION CERTIFICATE
Filing Requirement of Act 74, Mich. P.A. 1970

For corners in
KENT COUNTY
 (County)

Located In:	Corner Code #
T 6N R 10W	M-11
T 6N R 9W	A-11
T R	
T R	
T R	
S T R	
S T R	
S T R	
S T R	

- Public Land Survey
- Property Controlling in Section
- Miscellaneous Property in Sec.
- Lot No. _____, Recorded Plat _____
- Private Claims _____

STATE OF MICHIGAN
 COUNTY OF KENT
 RECEIVED FOR RECORD

96 JUN -7 AM 8:28

REG. OF DEEDS

[Signature]

9173

Register of Deeds Stamp & File Number

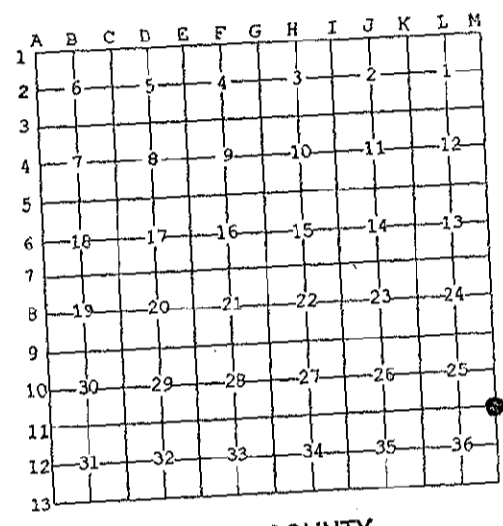

I, Kirk Breitels, in a field survey on Apr. 3, 19 96 do hereby state that under requirements of P.A. 74, Michigan P.A. of 1970, the corner points mentioned in lines 1 and 2 above were in conformance with regulations and rules therefore as required in the current manual of survey instructions of the United States Department of the Interior, Bureau of Land Management or by a decree of a Court of Law and/or that the corner points mentioned in lines 3, 4 and 5 above were in conformance with the rules of the Michigan Board of Land Surveyors or by a Decree of a Court of Law; established, re-established, monumented, recovered, found as expressed below:

NOTE: Not more than 2 corners, all in the same town and range, may be recorded on this certificate.

A. Description of original monument and accessories and/or subsequent restoration:

Date	Monument	Accessories	Restoration
M-11 1831	GLO	Mullett	Set Post
1959	Kent Co. Wit.		Conc. Mon.
1983	LCRC #3323	Stadt	Conc. Mon.
1983	LCRC #3608	Kolehouse	Set Kent County Monument
1991	LCRC #6052	Unema	Kent County Monument

P.A. 345 1990 KENT COUNTY
 PEER APPROVED 5/30/96
 CHAIRMAN [Signature]

The position of this corner was previously approved by the Kent County Remonumentation Peer Group, monumented by Randy J. Kolehouse on 10/29/83 and was recorded per LCRC #3608

B. Description of corner evidence found and/or method applied in restoring or reestablishing corner:
 M-11 Found standard Kent Co. Mon. (Harrison) per witnesses from above LCRC as set by Randy J. Kolehouse in place of the Conc. Mon. he found. Said Conc. Mon. checks with Kent Co. Wit. and LCRC #3323.
 LCRC #3608
 Nail/tag 16" Hickory S40°W 32.45'
 Nail/tag P. Pole S25°E 58.20'
 Nail/tag P. Pole N10°E 141.60'
 C/L stop sign post N20°W 42.65'
 LCRC #6052
 Nail/tag 18" Hickory S40°W 32.65'
 Nail/tag 6" Elm clump N12°W 91.12'
 Nail/tag P. Pole S20°E 58.21'
 Nail/tag P. Pole N11°E 141.55'

The selected location is accepted by me and is generally accepted by professional surveyors as the best available evidence of the position of the original corner.

C. Description of monument for corner and accessories established to perpetuate locating the position of the corner:
 M-11 Standard Kent County Monument
 Nail & KC Remon. tag NW side 20" Hickory S40°W 32.65'
 Nail & KC Remon. tag E. side 6" Elm clump N12°W 91.20'
 Nail & KC Remon. tag W. side P. Pole S20°E 58.21'
 Nail & KC Remon. tag W. side P. Pole N11°E 141.60'
 C/L 52nd is 2.8' N.
 C/L gravel (Snow Ave.) is 4' E.

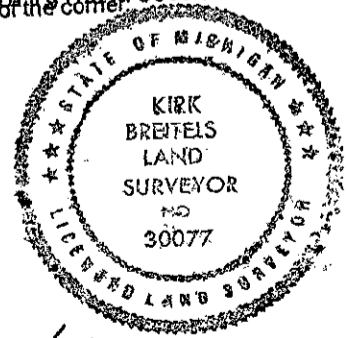

Signed by *[Signature]*
 Surveyor's Michigan License No. 30077

Date 4/19/96