

\$7.00
\$2.00

KENT COUNTY REMONUMENTATION

STATE OF MICHIGAN
COUNTY OF KENT
RECEIVED FOR RECORD

LAND CORNER RECORDATION CERTIFICATE
Filing Requirement of Act 74, Mich. P.A. 1970

95 MAY 12 AM 10:43

For corners in
KENT COUNTY
(County)

Located In: Corner Code #

- 1. Public Land Survey T 6N R 11W M-11
- T R
- T R
- T R
- 2. Property Controlling S T R
- in Section S T R
- 3. Miscellaneous S T R
- Property in Sec. S T R

W. J. Bond
REG. OF DEEDS

8349

SURVEY & REMONUMENTATION Register of Deeds Stamp & File Number

- 4. Lot No. _____, Recorded Plat MAY 09 1996
- 5. Private Claims _____

COMMISSION

I, Kirk Breitels, in a field survey on March 23, 19 95, do hereby certify that under requirements of P.A. 74, Michigan P.A. of 1970, the corner points mentioned in lines 1 and 2 above were in conformance with regulations and rules therefore as required in the current manual of survey instructions of the United States Department of the Interior, Bureau of Land Management or by a decree of a Court of Law and/or that the corner points mentioned in lines 3, 4 and 5 above were in conformance with the rules of the Michigan Board of Land Surveyors or by a Decree of a Court of Law; established, re-established, monumented, re-monumented, recovered, found as expressed below:

A	B	C	D	E	F	G	H	I	J	K	L	M
2	6	5	4	3	2	1						
3												
4	7	8	9	10	11	12						
5												
6	18	17	16	15	14	13						
7												
8	19	20	21	22	23	24						
9												
10	30	29	28	27	26	25						
11												
12	31	32	33	34	35	36						
13												

NOTE: Not more than 4 corners, all in the same town and range, may be recorded on this certificate.

A. Description of original monument and accessories and/or subsequent restoration:

M-11	1831	GLO	Mullett	Set Post
	1962	Kent Co. Wit.		"T" Iron
	1972	LCRC #107	Bonnema	Iron in mon. box
	1974	Kent Co. Wit.		Iron in mon. box.
	1982	LCRC #3180	Jonker	Set Kent Co. Mon.

The position of this corner was previously approved by the Kent County Remonumentation Peer Group, monumented by Robert J. Jonker on 11/23/82 and was recorded per LCRC # 3180

B. Description of corner evidence found and/or method applied in restoring or reestablishing corner:

M-11 Found PK Nail (road const. 1994) that is in the same position as set in 1982 by Robert J. Jonker in place of a 3/4" Round Iron he found inside a mon. box. Said Iron in mon. box fit Kent Co. Wit. and LCRC #107. Said PK Nail fits previous survey data prior to const., LCRC #3180 and "MEADOWBROOK BUSINESS PARK," Liber 91, Pg. 21-31.
LCRC #3180

Remon. tag NE side P. Pole	S45°E	73.46'
Remon. tag NW side L. Pole	S40°W	54.95'
Remon. tag NW side P. Pole	N20°E	137.65'
C/L manhole	N50°E	64.28'
C/L manhole	N65°W	70.45'

P.A. 345 1990 KENT COUNTY

PEER APPROVED 3/30/95

CHAIRMAN *Harry Hubers*

The selected position is accepted by me and is generally accepted by professional surveyors as the best available evidence of the original corner.

C. Description of monument for corner and accessories established to perpetuate locating the position of the corner:

M-11 Set Standard Kent County Monument (Harrison) in place of the PK Nail		
Nail & KC Remon. tag NE side P. Pole	S45°E	72.77' (pole moved)
Set Nail & KC Remon. tag NW side L. Pole	S40°W	75.10' (new pole)
Nail & KC Remon. tag NW side P. Pole	N20°E	137.75'
Set Nail & KC Remon. tag side Guy Pole	N40°E	74.65'
C/L manhole	N50°E	64.38'
C/L manhole	N65°W	70.65'

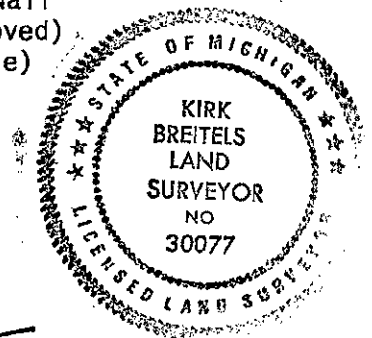

Signed by *Kirk Breitels*

Date 3/30/95

Surveyor's Michigan License No. 30077