

SEP 18 1995

COMMISSION

LAND CORNER RECORDATION CERTIFICATE
Filing Requirement of Act 74, Mich. P.A. 1970
KENT COUNTY REMONUMENTATION

STATE OF MICHIGAN
COUNTY OF KENT
RECEIVED FOR RECORD

95 MAR 24 AM 11:15

For corners in

Kent (County)	Located in:	Corner Code #
1. Public Land Survey	T <u>6N</u> R <u>12W</u>	<u>C-3</u>
	T _____ R _____	_____
	T _____ R _____	_____
	T _____ R _____	_____
2. Property Controlling in Section	S _____ T _____ R _____	_____
	S _____ T _____ R _____	_____
3. Miscellaneous Property in Sec.	S _____ T _____ R _____	_____
	S _____ T _____ R _____	_____

Tim J. Bond
REG. OF DEEDS

8342

Register of Deeds Stamp & File Number

4. Lot No. _____, Recorded Plat _____
5. Private Claims _____

I, Fandy Kolehouse, in a field survey on March 24 19 94, do hereby certify that under requirements of P.A. 74 Michigan P.A. of 1970, the corner points mentioned in lines 1 and 2 above were in conformance with regulations and rules therefore as required in the current manual of survey instructions of the United States Department of the Interior, Bureau of Land Management or by a decree of a Court of Law and/or that the corner points mentioned in lines 3, 4 and 5 above were in conformance with the rules of the Michigan Board of Land Surveyors or by a Decree of a Court of Law; established, re-established, monumented, re-monumented, recovered, found as expressed below:

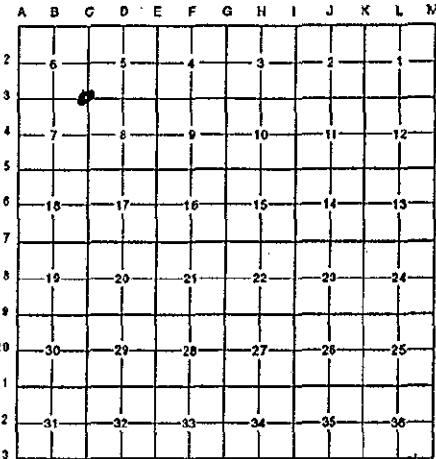

NOTE: Not more than 4 corners, all in the same town and range, may be recorded on this certificate.

A. Description of original monument and accessories and/or subsequent restoration:

C-3	1831	G.L.O. Notes	L. Lyon	Set Post
	1914-56	Survey Notes	Williams & Works	Iron in Ditch
	1930	Wit. Map	K.C. Surveyor	Iron
	1984	L.C.R.C. 3928	M. Rosema	Fnd. Iron in Ditch/Set K.C. Mon.
	1990	L.C.R.C. 5699	Milliron	Reset K.C. Monument

The position of this corner was previously approved by the Kent County Remonumentation Peer Group and monumented by Rex Milliron 11/26/90 and was recorded per L.C.R.C. #5699.

B. Description of corner evidence found and/or method applied in restoring or reestablishing corner:

C-3 Found standard Kent County Monument as reset after construction in L.C.R.C. #5699 at location of K.C. Monument. Set by M. Rosema in L.C.R.C. #3928 in place of an iron in north ditch of roadway which checks Williams & Works survey records from 1914-1956 and also Kent County Surveyor's records from 1930.

L.C.R.C. #5699

- Nail W side 16" Oak N 10° E 51.35'
- Nail W side 24" Oak N 30° E 29.64'
- Nail & remon. tag S side 32" Oak N 60° E 23.22'
- Nail SE side 20" Oak N 70° E 55.76'
- Nail & remon. tag W side 5" Cedar S 10° W 57.05'
- Nail & remon. tag W side 6" Cedar S 30° W 66.53'

P.A. 346 1990 KENT COUNTY
PEER APPROVED 7/20/94
CHAIRMAN *Harry Hubbell*

The selected location is accepted by me and is generally accepted by professional surveyors as the best available evidence of the position of the original corner.

C. Description of monument for corner and accessories established to perpetuate locating the position of the corner:

- C-3 Standard Kent County Monument
- Nail & K.C. remon tag in W side 16" Oak N 10° E 51.35'
 - Nail & K.C. remon tag in W side 24" Oak N 30° E 29.64'
 - Nail & K.C. remon tag in S side 32" Oak N 60° E 23.22'
 - Nail & K.C. remon tag in SE side 20" Oak N 70° E 55.76'
 - Nail & K.C. remon tag in W side 5" Cedar S 10° W 57.05'
 - Nail & K.C. remon tag in W side 6" Cedar S 30° W 66.53'

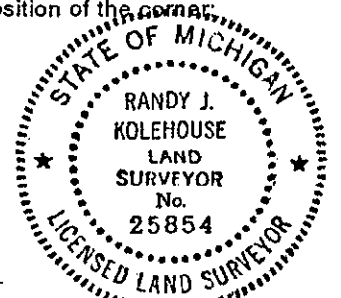

Signed by Randy J. Kolehouse Date 3/20/95
Surveyor's Michigan License No. 25854