

SURVEY & REMONUMENTATION

\$7.00
\$2.00

SEP 18 1995

COMMISSION

LAND CORNER RECORDATION CERTIFICATE
Filing Requirement of Act 74, Mich. P.A. 1970
KENT COUNTY REMONUMENTATION

For corners in

Kent
(County)

Located in:

Corner Code #

- | | | |
|------------------------------------|--------------------------|--------------|
| 1. Public Land Survey | T <u>5N</u> R <u>12W</u> | <u>A-1</u> |
| | T <u>6N</u> R <u>12W</u> | <u>A-13</u> |
| | T _____ R _____ | _____ |
| | T _____ R _____ | _____ |
| 2. Property Controlling in Section | S _____ T _____ R _____ | <u>Sec 2</u> |
| | S _____ T _____ R _____ | _____ |
| 3. Miscellaneous Property in Sec. | S _____ T _____ R _____ | _____ |
| | S _____ T _____ R _____ | _____ |

STATE OF MICHIGAN
COUNTY OF KENT
RECEIVED FOR RECORD
95 AUG 29 AM 10:46
REG. OF DEEDS
Carly Stover

8544

Register of Deeds Stamp & File Number

4. Lot No. _____, Recorded Plat _____
5. Private Claims _____

I, Randy Kolehouse, in a field survey on March 13 19 95, do hereby certify that under requirements of P.A. 74 Michigan P.A. of 1970, the corner points mentioned in lines 1 and 2 above were in conformance with regulations and rules therefore as required in the current manual of survey instructions of the United States Department of the interior, Bureau of Land Management or by a decree of a Court of Law and/or that the corner points mentioned in lines 3, 4 and 5 above were in conformance with the rules of the Michigan Board of Land Surveyors or by a Decree of a Court of Law; established, re-established, monumented, re-monumented, recovered, found as expressed below:

| A | B | C | D | E | F | G | H | I | J | K | L | M |
|----|----|----|----|----|----|----|---|---|---|---|---|---|
| 2 | 6 | 5 | 4 | 3 | 2 | 1 | | | | | | |
| 3 | | | | | | | | | | | | |
| 4 | 7 | 8 | 9 | 10 | 11 | 12 | | | | | | |
| 5 | | | | | | | | | | | | |
| 6 | 18 | 17 | 16 | 15 | 14 | 13 | | | | | | |
| 7 | | | | | | | | | | | | |
| 8 | 19 | 20 | 21 | 22 | 23 | 24 | | | | | | |
| 9 | | | | | | | | | | | | |
| 10 | 30 | 29 | 28 | 27 | 26 | 25 | | | | | | |
| 11 | | | | | | | | | | | | |
| 12 | 31 | 32 | 33 | 34 | 35 | 36 | | | | | | |

NOTE: Not more than 4 corners, all in the same town and range, may be recorded on this certificate.

- A. Description of original monument and accessories and/or subsequent restoration: P.A. 345 1990 KENT COUNTY
- | | | | | | |
|-----|------|----------------|-----------------------------|-------------------------------------|------------------------------|
| A-1 | 1817 | G.L.O. Notes | L. Lyon | Set Post | PEER APPROVED <u>5/25/95</u> |
| | 1930 | Wit. Map | K.C. Surveyor | Stone | CHAIRMAN <u>Harry Huber</u> |
| | 1954 | Survey Notes | Williams & Works | Set Iron in Place of Stone | |
| | 1972 | L.C.R.C. #152 | Medema, Van Kooten & Assoc. | 3/4" Iron | |
| | 1981 | L.C.R.C. #1548 | Nederveld & Jonker | Fnd. Iron & Stone/Set K.C. Monument | |
| | 1990 | L.C.R.C. #5700 | J. Bueche | K.C. Monument | |

This corner was originally approved by the Kent County Remonumentation Peer Group and monumented by Nederveld & Jonkeron 2/3/81 and was recorded per L.C.R.C. #1548.

- B. Description of corner evidence found and/or method applied in restoring or reestablishing corner:
- A-1 Found standard Kent County Monument (broken) in the C/L blacktop road running N-S (Kenowa) on C/L road West, 4.0' North of C/L blacktop road running East (60th Street) per L.C.R.C.'s #1548 and #5700 as set by Nederveld & Jonker in place of a 3/4" iron over a pointed stone they found which checked K.C. Surveyor and Williams & Works records.

L.C.R.C. #1548

L.C.R.C. #5700

- | | |
|---|--|
| Nail & Remon. tag on E side P. pole NNE 104.46' | Nail & remon. tag on E side P. pole N 15° E 104.46' |
| Nail & Remon. tag on N side P. pole SE 50.2' | Nail & remon. tag on N side P. pole S 50° E 50.20' |
| Nail & Remon. tag on SW side 8" Poplar NW 90.7' | Nail & remon. tag on SW side 12" Poplar N 55° W 90.80' |
| Nail & Remon. tag on S side 6" Poplar NNW 110.48' | Nail & remon. tag on S side 10" Poplar N 75° W 100.50' |
| | NE cor. frame garage S 55° W 110.45' |

The selected location is accepted by me and is generally accepted by professional surveyors as the best available evidence of the position of the original corner.

- C. Description of monument for corner and accessories established to perpetuate locating the position of the corner:
- A-1 Reset standard 4" x 30" Kent Conty Monument in place of broken Kent County Monument.

- Nail & K.C. remon. tag on E side P. pole N 15° E 104.46'
Nail & K.C. remon. tag on N side P. pole S 50° E 50.20'
Nail & K.C. remon. tag on SW side 12" Poplar N 55° W 90.80'
Nail & K.C. remon. tag on S side 10" Poplar N 75° W 100.50'
NE cor. frame garage S 55° W 110.45'

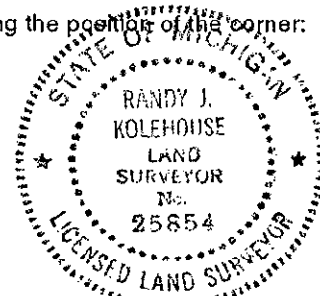

Signed by Randy J. Kolehouse
EARTH TECH

Date 8/21/95

Surveyor's Michigan License No. 25854