

SURVEY & REMONUMENTATION

MAR 08 1999

LAND CORNER RECORDATION CERTIFICATE
Filing Requirement of Act 74, Mich. P.A. 1970
KENT COUNTY REMONUMENTATION

SECTION _____

For corners in

Kent (County)	Located in: Vergennes Township	Corner Code #
1. Public Land Survey	T <u>7N</u> R <u>9W</u>	<u>C-6</u>
	T _____ R _____	_____
	T _____ R _____	_____
	T _____ R _____	_____
2. Property Controlling in Section	S _____ T _____ R _____	_____
	S _____ T _____ R _____	_____
3. Miscellaneous Property in Sec.	S _____ T _____ R _____	_____
	S _____ T _____ R _____	_____

REG. OF DEEDS

Lucy Jones

38 OCT 23 AM 9:55

STATE OF MICHIGAN
 COUNTY OF KENT
 RECEIVED FOR RECORD

10741

Register of Deeds Stamp & File Number

4. Lot No. _____, Recorded Plat _____
 5. Private Claims _____

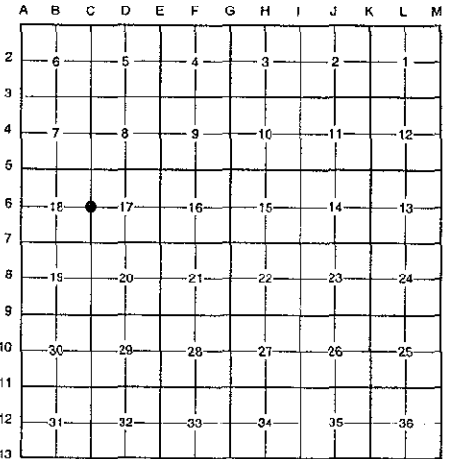

I, Randy Kolehouse, in a field survey on December 26 19 98, do hereby certify that under requirements of P.A. 74 Michigan P.A. of 1970, the corner points mentioned in lines 1 and 2 above were in conformance with regulations and rules therefore as required in the current manual of survey instructions of the United States Department of the interior, Bureau of Land Management or by a decree of a Court of Law and/or that the corner points mentioned in lines 3, 4 and 5 above were in conformance with the rules of the Michigan Board of Land Surveyors or by a Decree of a Court of Law; established, re-established, monumented, re-monumented, recovered, found as expressed below:

NOTE: Not more than 4 corners, all in the same town and range, may be recorded on this certificate.

A. Description of original monument and accessories and/or subsequent restoration:

C-6	1838	G.L.O. Notes	N. Brookfield	Set Post
	1965	Witness Map	K.C. Surveyor	1/2" Solid Rod
	1972	L.C.R.C. #280	Medema, Van Kooten & Assoc.	1/4" Solid Rod
	1981	L.C.R.C. #1908	Jonker Land Survey	Fnd. 3/4" Round Iron in Mon. Box / Set K.C. Mon. in Mon. Box
	1991	L.C.R.C. #5802	Exxel Engineering	K.C. Monument

This corner was originally approved by the Kent County Remonumentation Peer Group and monumented by Rob Jonker on 6/22/81 and was recorded per L.C.R.C. #1908.

B. Description of corner evidence found and/or method applied in restoring or reestablishing corner:

C-6 Found a Standard Kent County Monument in a monument box 2' West of the C/L intersection of Parnell Avenue (bit.) running North and South and Downes Street (bit.) running West per L.C.R.C.'s #1908 and #5802 as set by Rob Jonker in place of a 3/4" round iron he found in a monument box which checked L.C.R.C. #280 and the K.C. Surveyor's records.

L.C.R.C. #1908

L.C.R.C. #5802

"X" on curb N42°W 37.12'

"X" on curb N 42°W 37.13' (m. 37.11')

"X" on curb S51°W 35.48'

"X" on curb S 51°W 35.54'

Nail & remon tag in E side 44" Oak S 15°W 123.13' (m. 123.05')

P.A. 345 1990 KENT COUNTY

PEER APPROVED 2/19/98

CHAIRMAN *Harry Huber*

The selected location is accepted by me and is generally accepted by professional surveyors as the best available evidence of the position of the original corner.

C. Description of monument for corner and accessories established to perpetuate locating the position of the corner:

C-6 Standard Kent County Monument in a Monument Box

Nail & K.C. remon. tag on SW side fence post N'ly post to gate S 38° E 44.35'

Nail & K.C. remon. tag on E side 44" Oak S 15° W 123.05'

"X" cut on curb N 42° W 37.11'

"X" cut on curb S 51° W 35.54'

C/L "X" bit. roads running N, S, & W, East 2.0'

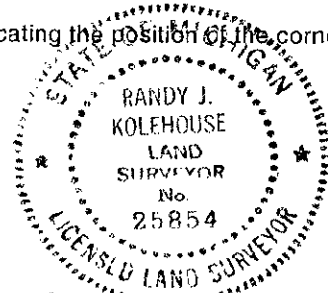

Signed by *Randy J. Kolehouse*

Date 9-1-98

EARTH TECH

Surveyor's Michigan License No. 25854