

MAR 08 1999

\$7.00
\$2.00

LAND CORNER RECORDATION CERTIFICATE
Filing Requirement of Act 74, Mich. P.A. 1970
KENT COUNTY REMONUMENTATION

SECTION

For corners in

Kent (County)	Located in: Vergennes Township	Corner Code #
1. Public Land Survey	T <u>7N</u> R <u>9W</u>	<u>C-7</u>
	T _____ R _____	_____
	T _____ R _____	_____
	T _____ R _____	_____
2. Property Controlling in Section	S _____ T _____ R _____	_____
	S _____ T _____ R _____	_____
3. Miscellaneous Property in Sec.	S _____ T _____ R _____	_____
	S _____ T _____ R _____	_____

STATE OF MICHIGAN
COUNTY OF KENT
RECEIVED FOR RECORDING
38 OCT 23 AM 9:55
REG. OF DEEDS
Lucy Bond

10742
Register of Deeds Stamp & File Number

- 4. Lot No. _____, Recorded Plat _____
- 5. Private Claims _____

I, Randy Kolehouse, in a field survey on December 26 19 97, do hereby certify that under requirements of P.A. 74 Michigan P.A. of 1970, the corner points mentioned in lines 1 and 2 above were in conformance with regulations and rules therefore as required in the current manual of survey instructions of the United States Department of the interior, Bureau of Land Management or by a decree of a Court of Law and/or that the corner points mentioned in lines 3, 4 and 5 above were in conformance with the rules of the Michigan Board of Land Surveyors or by a Decree of a Court of Law; established, re-established, monumented, re-monumented, recovered, found as expressed below:

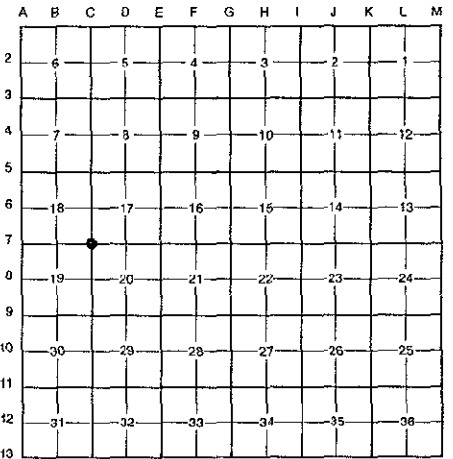

NOTE: Not more than 4 corners, all in the same town and range, may be recorded on this certificate.

A. Description of original monument and accessories and/or subsequent restoration:

C-7	1838	G.L.O. Notes	N. Brookfield	Set Post
	1962	Witness Map	K.C. Surveyor	1/2" Iron
	1972	L.C.R.C. #280	Medema, Van Kooten & Assoc.	"T" Iron
	1974	L.C.R.C. #737	J. Clapp	1/2" Iron
	1981	L.C.R.C. #1909	Jonker Land Survey	Fnd. "T" Iron / Set K.C. Monument
	1991	L.C.R.C. #5803	Exxel Engineering	K.C. Monument

P.A. 345 1990 KENT COUNTY
PEER APPROVED 12/19/98
CHAIRMAN *[Signature]*

This corner was originally approved by the Kent County Remonumentation Peer Group and monumented by Rob Jonker on 7/8/81 and was recorded per L.C.R.C. #1909.

B. Description of corner evidence found and/or method applied in restoring or reestablishing corner:

C-7 Found a Standard Kent County Monument 4' East of the C/L intersection of Parnell Avenue (bit.) running North and South and McPherson Street (gravel) running East, on line of a fence line running West per L.C.R.C.'s #1909 and #5803 as set by Rob Jonker in place of a "T" iron he found which checked L.C.R.C.'s #737, #280 and the K.C. Surveyor's records.

L.C.R.C. #1909

L.C.R.C. #5803

Remon. tag on NW side 48" Oak N38°E 46.26'
Remon. tag on NE side 26" Oak N28°W 59.62'
Remon. tag on N side p.pole S65°E 86.15'

Nail & remon tag in N side P.Pole S 65°E 86.13' (m. 86.12')
Nail & remon tag in NW side 48" Oak N 40°E 46.31' (m. 46.27')
Nail & remon tag in NE side 36" Oak N 28°W 59.66' (m. 59.68')
Nail & remon tag in N side 12" Elm S 50°W 71.15' (m. 71.04')
Nail & remon tag in S side 24" Oak S 90°W 81.23' (m. 81.11')
C/L "X" of BT is 4' W

The selected location is accepted by me and is generally accepted by professional surveyors as the best available evidence of the position of the original corner.

C. Description of monument for corner and accessories established to perpetuate the position of the corner:

C-7 Standard Kent County Monument

Nail & K.C. remon. tag on NW side 48" Oak N 40° E 46.27'
Nail & K.C. remon. tag on NE side 36" Oak N 28° W 59.68'
Nail & K.C. remon. tag on N side 12" Elm S 50° W 71.04'
Nail & K.C. remon. tag on S side 24" Oak S 90° W 81.11'
Nail & K.C. remon. tag on N side P. pole S 65° E 86.12'
C/L "X" of roads running N, S, & E, West 4.0'

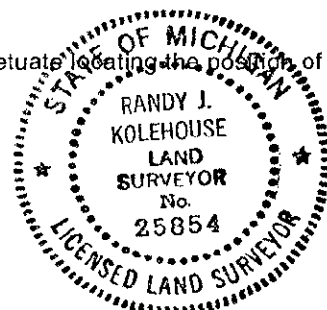

Signed by *Randy J. Kolehouse* Date 9-1-98

EARTH TECH

Surveyor's Michigan License No. 25854