

\$7.00 SURVEY & REMONUMENTATION
 \$2.00
 FEB 08 1999

LAND CORNER RECORDATION CERTIFICATE
Filing Requirement of Act 74, Mich. P.A. 1970
KENT COUNTY REMONUMENTATION

For corners in SECTION
Kent
 (County)

Located in:	Vergennes Township	Corner Code #
1. Public Land Survey	T <u>7N</u> R <u>9W</u>	<u>E-5</u>
	T _____ R _____	_____
	T _____ R _____	_____
	T _____ R _____	_____
2. Property Controlling in Section	S _____ T _____ R _____	_____
	S _____ T _____ R _____	_____
3. Miscellaneous Property in Sec.	S _____ T _____ R _____	_____
	S _____ T _____ R _____	_____

STATE OF MICHIGAN
 COUNTY OF KENT
 RECEIVED FOR RECORD
 38 OCT 23 AM 9:56
 REG. OF DEEDS
[Signature]
 10758
 Register of Deeds Stamp & File Number

4. Lot No. _____, Recorded Plat _____
 5. Private Claims _____

I, Randy Kolehouse, in a field survey on December 27 19 97, do hereby certify that under requirements of P.A. 74 Michigan P.A. of 1970, the corner points mentioned in lines 1 and 2 above were in conformance with regulations and rules therefore as required in the current manual of survey instructions of the United States Department of the interior, Bureau of Land Management or by a decree of a Court of Law and/or that the corner points mentioned in lines 3, 4 and 5 above were in conformance with the rules of the Michigan Board of Land Surveyors or by a Decree of a Court of Law; established, re-established, monumented, re-monumented, recovered, found as expressed below:

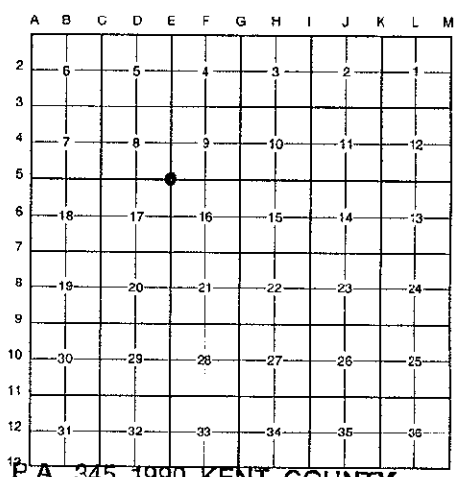

NOTE: Not more than 4 corners, all in the same town and range, may be recorded on this certificate.

A. Description of original monument and accessories and/or subsequent restoration:

E-5	1838	G.L.O. Notes	N. Brookfield	9" Beech
	1965	Witness Map	K.C. Surveyor	1/2" Iron
	1973	L.C.R.C. #399	Williams & Works	Set "T" Iron
	1981	L.C.R.C. #1932	Jonker Land Survey	Fnd. "T" Iron in Mon. Box / Set K.C. Mon. in Mon. Box
	1991	L.C.R.C. #5840	Exxel Engineering	K.C. Monument

P.A. 345 1990 KENT COUNTY
 PEER APPROVED 2/19/98
 CHAIRMAN *[Signature]*

This corner was originally approved by the Kent County Remonumentation Peer Group and monumented by Rob Jonker on 7/10/81 and was recorded per L.C.R.C. #1932.

B. Description of corner evidence found and/or method applied in restoring or reestablishing corner:

E-5 Found a Standard Kent County Monument in a monument box 1.5' South of the C/L intersection of 2 Mile Road (bit.) running East and West and Murray Lake Avenue (bit.) running North per L.C.R.C.'s #1932 and #5840 as set by Rob Jonker in place of a "T" iron he found in a monument box which checked L.C.R.C. #399.

L.C.R.C. #1932	L.C.R.C. #5840
Remon. tag on SW side p.pole N43°W 50.00'	Nail & remon tag in W side 24" Oak S 05°W 112.99'
Remon. tag on SE side 38" Maple N43°E 70.38'	Nail & remon tag in N side 22" Butternut S 73°E 102.70'
Remon. tag on W side 20" Oak S05°W 113.05'	C/L "X" of BT is N 1.5' "
Remon. tag on N side Triple 16" Butternut S73°E 102.70'	Nail & remon tag in SW side P.Pole N 43°W 50.01'
	Nail & remon tag in SE side 38" Maple N 36°E 70.37' (m. 70.44')

The selected location is accepted by me and is generally accepted by professional surveyors as the best available evidence of the position of the original corner.

C. Description of monument for corner and accessories established to perpetuate location of the position of the corner:

E-5 Standard Kent County Monument in a Monument Box

- Nail & K.C. remon. tag on W side 24" Oak S 05° W 112.99'
- Nail & K.C. remon. tag on N side 22" Butternut S 73° E 102.70'
- Nail & K.C. remon. tag on SW side P. pole N 43° W 50.01'
- Nail & K.C. remon. tag on SE side 38" Maple N 36° E 70.44'
- C/L "X" of bit. roads running N-E-W, North 1.5'

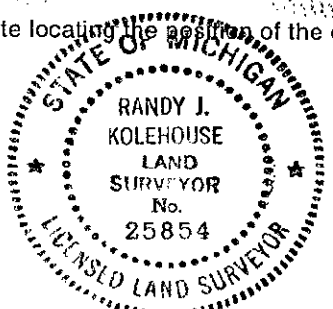

Signed by *[Signature]* Date 9-1-98
 EARTH TECH
 Surveyor's Michigan License No. 25854