

MAR 08 1999

SECTION LAND CORNER RECORDATION CERTIFICATE
Filing Requirement of Act 74, Mich. P.A. 1970
KENT COUNTY REMONUMENTATION

STATE OF MICHIGAN
COUNTY OF KENT
RECEIVED FOR RECORD
38 OCT 23 AM 9:57

REG. OF DEEDS
[Signature]

10768
Register of Deeds Stamp & File Number

For corners in

Table with columns: Kent (County), Located in: Vergennes Township, Corner Code #. Rows include Public Land Survey, Property Controlling in Section, and Miscellaneous Property in Sec.

4. Lot No. _____, Recorded Plat _____
5. Private Claims _____

I, Randy Kolehouse, in a field survey on December 30 19 97, do hereby certify that under requirements of P.A. 74 Michigan P.A. of 1970, the corner points mentioned in lines 1 and 2 above were in conformance with regulations and rules therefore as required in the current manual of survey instructions of the United States Department of the interior, Bureau of Land Management or by a decree of a Court of Law and/or that the corner points mentioned in lines 3, 4 and 5 above were in conformance with the rules of the Michigan Board of Land Surveyors or by a Decree of a Court of Law; established, re-established, monumented, re-monumented, recovered, found as expressed below:

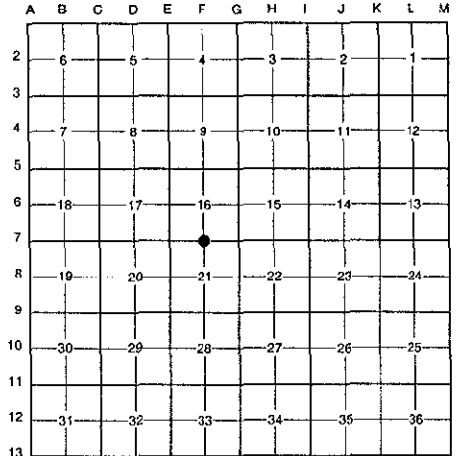

NOTE: Not more than 4 corners, all in the same town and range, may be recorded on this certificate.

A. Description of original monument and accessories and/or subsequent restoration:

Table with columns: F-7, 1838, G.L.O. Notes, N. Brookfield, Set Post. Rows list various monuments like Witness Map, L.C.R.C. #59, #400, #1937, #5832 and their descriptions.

P.A. 345 1990 KENT COUNTY
PEER APPROVED 2/19/98
CHAIRMAN [Signature]

This corner was originally approved by the Kent County Remonumentation Peer Group and monumented by Rob Jonker on 8/6/81 and was recorded per L.C.R.C. #1937.

B. Description of corner evidence found and/or method applied in restoring or reestablishing corner:

F-7 Found a Standard Kent County Monument 2' North of the C/L of Mc Pherson Street (gravel) running East and West, on line of a tree row and fence line running South, per L.C.R.C.'s #1937 and #5832 as set by Rob Jonker in place of a 1" iron he found at grade over a 12"x18"x36" stone 24" below grade which checked L.C.R.C.'s #400, #59 and the K.C. Surveyor's records.

L.C.R.C. #1937

L.C.R.C. #5832

Remon. tag on E side 18" Hickory S01°W 54.29' (m. 54.32')
Remon. tag on SW side 12" Walnut S64°E 57.20' (m. 57.21')
Remon. tag on SE side 15" tw. Oak N70°E 56.38' (m. 56.24')
Remon. tag on N side 10" Elm S68°W 73.49' (m. 73.55')
Remon. tag on S side 9" Hickory N54°W 58.13' (m. 58.12')

Nail & remon tag in SW side 12" Hickory N 55°W 58.13' (m. 58.12')
Nail & remon tag I S side 20" Twin Oak N 70°E 56.23' (m. 56.24')
Nail & remon tag in S side 14" Walnut S 64°E 57.20' (m. 57.21')
Nail & remon tag in N side 14" Elm S 68°W 73.44' (m. 73.55')

The selected location is accepted by me and is generally accepted by professional surveyors as the best available evidence of the position of the original corner.*

C. Description of monument for corner and accessories established to perpetuate locating the position of the corner:

F-7 Standard Kent County Monument
Nail & K.C. remon. tag on SW side 12" Maple N 55° W 58.12'
Nail & K.C. remon. tag on S side 20" Twin Oak N 70° E 56.24'
Nail & K.C. remon. tag on S side 14" Walnut S 64° E 57.21'
Nail & K.C. remon. tag on N side 14" Elm S 68° W 73.55'
Nail & K.C. remon. tag on E side 18" Hickory S 01° W 54.32'
C/L gravel road running E-W, South 2.0'
On tree row and fence line running S

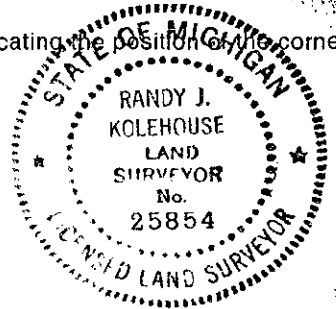

Signed by Randy J. Kolehouse

Date 9-1-98

EARTH TECH

Surveyor's Michigan License No. 25854