

LAND SURVEY & REMONUMENTATION

MAR 03 1999

LAND CORNER RECORDATION CERTIFICATE  
Filing Requirement of Act 74, Mich. P.A. 1970  
KENT COUNTY REMONUMENTATION

For corners in

SECTION

Kent (County)	Located in: Vergennes Township	Corner Code #
1. Public Land Survey	T <u>7N</u> R <u>9W</u>	<u>I-8</u>
	T _____ R _____	_____
	T _____ R _____	_____
	T _____ R _____	_____
2. Property Controlling in Section	S _____ T _____ R _____	_____
	S _____ T _____ R _____	_____
3. Miscellaneous Property in Sec.	S _____ T _____ R _____	_____
	S _____ T _____ R _____	_____

REG. OF DEEDS  
*Lucy Stand*

STATE OF MICHIGAN  
COUNTY OF KENT  
RECEIVED FOR RECORD  
98 OCT 23 AM 9:58

10794

Register of Deeds Stamp & File Number

4. Lot No. \_\_\_\_\_, Recorded Plat \_\_\_\_\_  
5. Private Claims \_\_\_\_\_

I, Randy Kolehouse, in a field survey on December 29 19 97, do hereby certify that under requirements of P.A. 74 Michigan P.A. of 1970, the corner points mentioned in lines 1 and 2 above were in conformance with regulations and rules therefore as required in the current manual of survey instructions of the United States Department of the interior, Bureau of Land Management or by a decree of a Court of Law and/or that the corner points mentioned in lines 3, 4 and 5 above were in conformance with the rules of the Michigan Board of Land Surveyors or by a Decree of a Court of Law; established, re-established, monumented, re-monumented, recovered, found as expressed below:

NOTE: Not more than 4 corners, all in the same town and range, may be recorded on this certificate.

A. Description of original monument and accessories and/or subsequent restoration:

I-8	1838	G.L.O. Notes	N. Brookfield	Set Post
	1944	Witness Map	K.C. Surveyor	3/4" Iron
	1977	L.C.R.C. #1065	Williams & Works	3/4" iron in Mon. Box
	1981	L.C.R.C. #1950	Jonker Land Survey	Fnd. 3/4" Iron in Mon. Box / Set K.C. Mon. in Mon. Box
	1995	L.C.R.C. #8236	William Byl	K.C. Monument

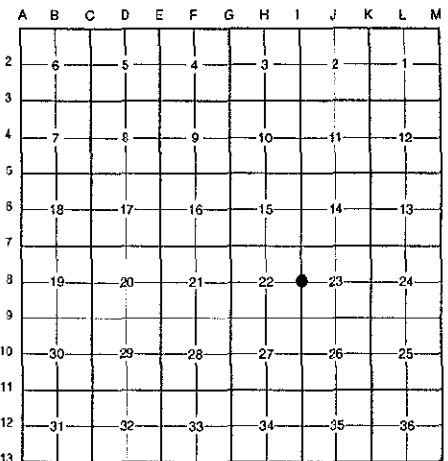

P.A. 345 1990 KENT COUNTY  
PEER APPROVED 2/19/99  
CHAIRMAN *Harry Huber*

This corner was originally approved by the Kent County Remonumentation Peer Group and monumented by Rob Jonker on 8/4/81 and was recorded per L.C.R.C. #1950.

B. Description of corner evidence found and/or method applied in restoring or reestablishing corner:

I-8 Found a Standard Kent County Monument at the C/L intersection of Lincoln Lake Avenue (bit.) running North and South and Heims Road (gravel) running East and West per L.C.R.C.'s #1950 and #8236 as set by Rob Jonker in place of a 3/4" round iron he found in a monument box over a 3/4" iron 20" below grade which checked L.C.R.C. #1065 and the K.C. Surveyor's records.

L.C.R.C. #1950

- Remon. tag on SE side p.pole S45°W 94.30'
- "X" cut on concrete curb N26°W 54.81'
- "X" cut on concrete curb N75°E 59.26'
- "X" cut on concrete curb S68°E 59.35'

L.C.R.C. #8236

- Nail & KC Remon. tag SE side Power Pole S45°W 94.26'
- "X" on concrete curb N26°W 55.32' (m. 55.35')
- "X" on concrete curb N75°E 59.30' (m. 59.25')
- "X" on concrete curb S68°E (S28°E) 50.22' (m. 59.32')
- Nail & KC Remon. tag SW side 12" Pine N45°W 78.02'
- On C/L "X" pavement

The selected location is accepted by me and is generally accepted by professional surveyors as the best available evidence of the position of the original corner.

C. Description of monument for corner and accessories established to perpetuate locating the position of the corner:

- I-8 Standard Kent County Monument
- Nail & K.C. remon. tag on SW side 12" Pine N 45° W 78.02'
  - Nail & K.C. remon. tag on SE side P. pole S 45° W 94.26'
  - "X" cut on conc. curb N 26° W 55.35'
  - "X" cut on conc. curb N 75° E 59.25'
  - "X" cut on conc. curb S 28° E 59.32'
  - On C/L "X" bit. road running N-S and gravel road running E-W

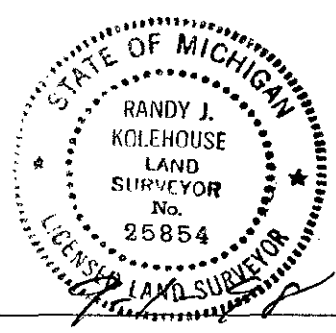

Signed by *Randy J. Kolehouse* Date \_\_\_\_\_  
EARTH TECH

Surveyor's Michigan License No. 25854