

MAR 08 1999

**LAND CORNER RECORDATION CERTIFICATE**  
Filing Requirement of Act 74, Mich. P.A. 1970  
KENT COUNTY REMONUMENTATION

STATE OF MICHIGAN  
COUNTY OF KENT  
RECEIVED FOR RECORD  
98 OCT 23 AM 9:58  
REG. OF DEEDS  
*David Standa*

For corners in	SECTION	Located in: Vergennes Township	Corner Code #
Kent (County)			
1. Public Land Survey	T <u>7N</u> R <u>9W</u>		<u>J-1</u>
	T _____ R _____		_____
	T _____ R _____		_____
	T _____ R _____		_____
2. Property Controlling in Section	S _____ T _____ R _____		_____
	S _____ T _____ R _____		_____
3. Miscellaneous Property in Sec.	S _____ T _____ R _____		_____
	S _____ T _____ R _____		_____

10798

Register of Deeds Stamp & File Number

4. Lot No. \_\_\_\_\_, Recorded Plat \_\_\_\_\_  
5. Private Claims \_\_\_\_\_

I, Randy Kolehouse, in a field survey on January 8 19 98, do hereby certify that under requirements of P.A. 74 Michigan P.A. of 1970, the corner points mentioned in lines 1 and 2 above were in conformance with regulations and rules therefore as required in the current manual of survey instructions of the United States Department of the interior, Bureau of Land Management or by a decree of a Court of Law and/or that the corner points mentioned in lines 3, 4 and 5 above were in conformance with the rules of the Michigan Board of Land Surveyors or by a Decree of a Court of Law; established, re-established, monumented, re-monumented, recovered, found as expressed below:

A	B	C	D	E	F	G	H	I	J	K	L	M
2	6	5	4	3	2							
3												
4	7	8	9	10	11	12						
5												
6	18	17	16	15	14	13						
7												
8	19	20	21	22	23	24						
9												
10	30	29	28	27	26	25						
11												
12	31	32	33	34	35	36						
13												

NOTE: Not more than 4 corners, all in the same town and range, may be recorded on this certificate.

A. Description of original monument and accessories and/or subsequent restoration:

J-1	This corner was not originally set by the G.L.O.			
1962	Witness Map	K.C. Surveyor	3/4" Iron	
1983	L.C.R.C. #3693	Glaza & Associates	3/4" Iron	
1986	L.C.R.C. #4358	R. Kolehouse	Fnd. 3/4" Iron / Set K.C. Monument	
1991	L.C.R.C. #5918	William Byl	K.C. Monument	

P.A. 345 1990 KENT COUNTY  
PEER APPROVED 2/18/98  
CHAIRMAN Randy Kolehouse

Note: This corner is not common with J-13, T8N, R9W.

This corner was originally approved by the Kent County Remonumentation Peer Group and monumented by Randy Kolehouse on 11/23/85 and was recorded per L.C.R.C. #4358.

B. Description of corner evidence found and/or method applied in restoring or reestablishing corner:

J-1 Found a Standard Kent County Monument on the C/L of 4 Mile Road (gravel) running East and West and 600' ± East of the railroad tracks running North and South per L.C.R.C.'s #4358 and #5918 as set by Randy Kolehouse in place of a 3/4" iron he found which checked L.C.R.C. #3693 and the K.C. Surveyor's records.

L.C.R.C. #4358	L.C.R.C. #5918
Nail & K.C. Remon. tag in N. side 14" Ash S 75° W 74.90'	Nail & KC Remon. tag N. side 16" Ash S75°W 74.80' (m. 74.81')
Nail & K.C. Remon. tag in N. side 14" Maple S 60° W 43.25'	Nail & KC Remon. tag N. side 18" Maple S60°W 43.27'
Nail & K.C. Remon. tag in W. side tw 6" Ash S 10° W 22.43'	Nail & KC Remon. tag W. side Tw. 6" Ash S10°W 22.53' (m. 22.47')
Nail in W. side P. Pole N 15° W 27.00'	PK Nail W. side P. Pole N15°W 26.86' (m. 26.91')
K.C. Monument at the S 1/4 cor. sec. 35 T8N R9W, west 18.85'	KC Monument at S 1/4 cor. Sec. 35, T8N, R9W S90°W 18.85' (m. 18.87')

The selected location is accepted by me and is generally accepted by professional surveyors as the best available evidence of the position of the original corner.

C. Description of monument for corner and accessories established to perpetuate locating the position of the corner:

J-1 Standard Kent County Monument  
Nail & K.C. remon. tag on N side 16" Ash S 75° W 74.81'  
Nail & K.C. remon. tag on N side 18" Maple S 60° W 43.27'  
Nail & K.C. remon. tag on W side 26" Ash S 10° W 22.47'  
Nail & K.C. remon. tag on W P. pole N 15° W 26.91'  
On C/L of gravel road running E-W  
K.C. Mon. J-13, T8N, R9W, S 90° W 18.87'

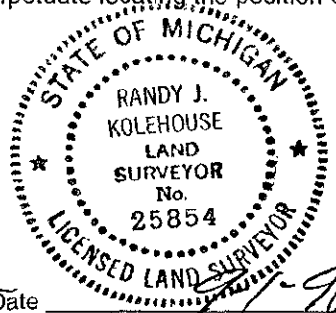

Signed by Randy J. Kolehouse Date 2/18/98  
EARTH TECH

Surveyor's Michigan License No. 25854