

**SURVEY & REMONUMENTATION**

\$7.00  
\$2.00

MAY 22 2000

*leg 2*

**LAND CORNER RECORDATION CERTIFICATE**  
Filing Requirement of Act 74, Mich. P.A. 1970  
KENT COUNTY REMONUMENTATION

For corners in

**SECTION**

Kent (County)	Located in: Vergennes Township	Corner Code #
1. Public Land Survey	T <u>7N</u> R <u>9W</u>	<u>J-3</u>
	T _____ R _____	_____
	T _____ R _____	_____
	T _____ R _____	_____
2. Property Controlling in Section	S _____ T _____ R _____	_____
	S _____ T _____ R _____	_____
3. Miscellaneous Property in Sec.	S _____ T _____ R _____	_____
	S _____ T _____ R _____	_____

REG. OF DEEDS

*[Handwritten Signature]*

STATE OF MICHIGAN  
SOCIETY OF SURVEYORS  
RECEIVED FOR RECORD  
1999 DEC 30 AM 9:54

**11895**

Register of Deeds Stamp & File Number

4. Lot No. \_\_\_\_\_, Recorded Plat \_\_\_\_\_  
5. Private Claims \_\_\_\_\_

I, Randy Kolehouse, in a field survey on December 29 19 99, do hereby certify that under requirements of P.A. 74 Michigan P.A. of 1970, the corner points mentioned in lines 1 and 2 above were in conformance with regulations and rules therefore as required in the current manual of survey instructions of the United States Department of the interior, Bureau of Land Management or by a decree of a Court of Law and/or that the corner points mentioned in lines 3, 4 and 5 above were in conformance with the rules of the Michigan Board of Land Surveyors or by a Decree of a Court of Law; established, re-established, monumented, re-monumented, recovered, found as expressed below:

**NOTE: Not more than 4 corners, all in the same town and range, may be recorded on this certificate.**

**A. Description of original monument and accessories and/or subsequent restoration:**

J-3	Description	Accessories	Restoration
1838	G.L.O. Notes	N. Brookfield	Set Post
1904-66	Notes	Williams & Works	Stake, Stones & Conc. Mon., & "T" Iron
1944	Witness Map	K.C. Surveyor	Concrete Monument
1984	L.C.R.C. #3888	Williams & Works	Fnd. "T" Iron / Set K.C. Monument
1995	L.C.R.C. #8242	William Byl	K.C. Monument
1998	L.C.R.C. #10799	Earth Tech	Reset K.C. Monument

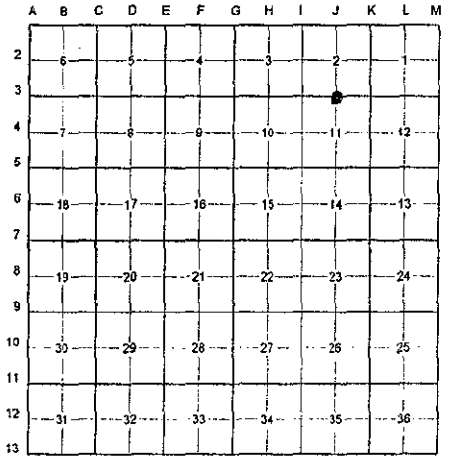

This corner was originally approved by the Kent County Remonumentation Peer Group and monumented by Williams & Works on 8/18/84 and was recorded per L.C.R.C. #3888. The corner was remonumented on 12/29/98 by Earth Tech and recorded in L.C.R.C. #10799.

**B. Description of corner evidence found and/or method applied in restoring or reestablishing corner:**

J-3 Found a Standard Kent County Monument per L.C.R.C. #10799 witnesses as set by Earth Tech.

L.C.R.C. #10799

- Nail & K.C. remon. tag on E side 18" Ash N 05° W 28.35'
- Nail & K.C. remon. tag on NE side 32" Walnut S 45° E 42.34'
- Nail & K.C. remon. tag on N side twin 18" Ash S 60° W 55.33'
- Nail & K.C. remon. tag on S side 24" Cherry N 50° W 58.82'
- Nail & K.C. remon. tag on S side twin 12" Oak N 70° E 54.57'
- C/L bit. road running E-W, South 2.0'±
- On fence line and tree row running N

P.A. 345 1990 KENT COUNTY  
PEER APPROVED 2-19-98  
CHAIRMAN *[Signature]*

The selected location is accepted by me and is generally accepted by professional surveyors as the best available evidence of the position of the original corner.

**C. Description of monument for corner and accessories established to perpetuate locating the position of the corner:**

J-3 Reset a Standard Kent County Monument - Also Set a Monument Box

- Nail & K.C. remon. tag on E side 18" Ash N 05° W 28.35'
- Nail & K.C. remon. tag on NE side 32" Walnut S 45° E 42.34'
- Nail & K.C. remon. tag on N side twin 18" Ash S 60° W 55.33'
- Nail & K.C. remon. tag on S side 24" Cherry N 50° W 58.82'
- Nail & K.C. remon. tag on S side twin 12" Oak N 70° E 54.57'
- C/L bit. road running E-W, South 2.0'±
- On fence line and tree row running N

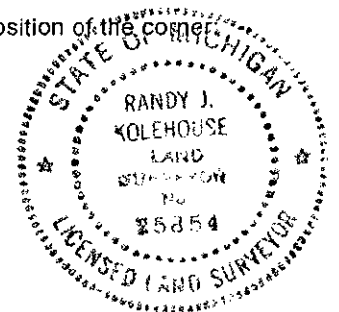

Signed by Randy J. Kolehouse Date 12-29-99  
WILLIAMS & WORKS

Surveyor's Michigan License No. 25854