

# SURVEY & REMONUMENTATION

MAR 03 1998

## LAND CORNER RECORDATION CERTIFICATE Filing Requirement of Act 74, Mich. P.A. 1970 KENT COUNTY REMONUMENTATION

SECTION  
For corners in  
Kent  
(County)

Located in: Ada Township  
Corner Code #  
1. Public Land Survey T 7N R 10W D-11  
T \_\_\_\_\_ R \_\_\_\_\_  
T \_\_\_\_\_ R \_\_\_\_\_  
T \_\_\_\_\_ R \_\_\_\_\_  
2. Property Controlling S \_\_\_\_\_ T \_\_\_\_\_ R \_\_\_\_\_  
in Section S \_\_\_\_\_ T \_\_\_\_\_ R \_\_\_\_\_  
3. Miscellaneous S \_\_\_\_\_ T \_\_\_\_\_ R \_\_\_\_\_  
Property in Sec. S \_\_\_\_\_ T \_\_\_\_\_ R \_\_\_\_\_

STATE OF MICHIGAN  
COUNTY OF KENT  
RECEIVED FOR RECORD  
97 OCT 15 AM 8:50  
REG. OF DEEDS  
*Lucy Bond*

10184

Register of Deeds Stamp & File Number

4. Lot No. \_\_\_\_\_, Recorded Plat \_\_\_\_\_  
5. Private Claims \_\_\_\_\_

I, Randy Kolehouse, in a field survey on January 22 19 97, do hereby certify that under requirements of P.A. 74 Michigan P.A. of 1970, the corner points mentioned in lines 1 and 2 above were in conformance with regulations and rules therefore as required in the current manual of survey instructions of the United States Department of the interior, Bureau of Land Management or by a decree of a Court of Law and/or that the corner points mentioned in lines 3, 4 and 5 above were in conformance with the rules of the Michigan Board of Land Surveyors or by a Decree of a Court of Law; established, re-established, monumented, re-monumented, recovered, found as expressed below:

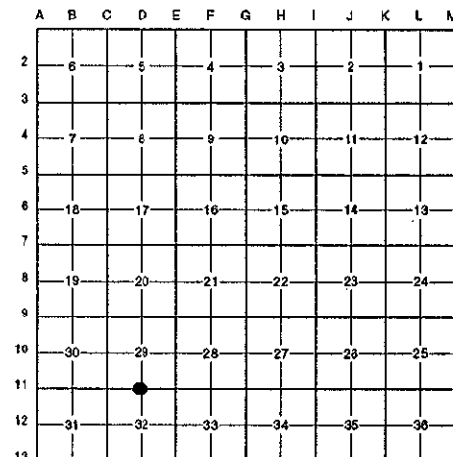

**NOTE:** Not more than 4 corners, all in the same town and range, may be recorded on this certificate.

A. Description of original monument and accessories and/or subsequent restoration:

D-11	1831	G.L.O. Notes	Mullett	Set Post
	N/A	Witness Map	K.C. Surveyor	Iron
	1971	L.C.R.C. #13	J. Spencer	1/2" Pipe in Ring of Stones
	1980	L.C.R.C. #1490	Williams & Works	Fnd. Conc. Monument with 1/2" Rebar / Set K.C. Monument
	1989	L.C.R.C. #5124	T. Chettleburgh	K.C. Monument

This corner was originally approved by the Kent County Remonumentation Peer Group and monumented by Williams & Works on 12/3/80 and was recorded per L.C.R.C. #1490.

B. Description of corner evidence found and/or method applied in restoring or reestablishing corner:

D-11 Found a Standard Kent County Monument on the remains of a fence line running East, on the West edge of a clump of trees, per L.C.R.C.'s #1490 and #5124 as set by Williams & Works in place of a 1/2" rebar in concrete monument they found which checked L.C.R.C. #13 and the K.C. Surveyor's records.

L.C.R.C. #1490

Nail & K.C. Remon. Tag SW'ly Side 10" Poplar S 70° E 71.56'  
Nail & K.C. Remon. Tag SW'ly Side 18" W. Cherry S 42° E 33.08'

L.C.R.C. #5124

K.C. Remon. Tag & Nail South side 12" Wild Cherry S 75° E 32.90'  
K.C. Remon. Tag & Nail Southwest side 14" Poplar S 68° E 71.56' (m. 71.75')  
K.C. Remon. Tag & Nail Southwest side 20" Wild Cherry S 44° E 33.08'  
K.C. Remon. Tag & Nail Southwest side 13" Wild Cherry S 01° W 18.27' (m. 18.35')  
K.C. Remon. Tag & Nail West side 5" Maple S 19° W 20.57' (m. 20.61')

The selected location is accepted by me and is generally accepted by professional surveyors as the best available evidence of the position of the original corner.

C. Description of monument for corner and accessories established to perpetuate locating the position of the corner:

D-11 Standard Kent County Monument

- Nail & K.C. remon. tag on S side 12" Wild Cherry S 75° E 32.90'
- Nail & K.C. remon. tag on SW side 14" Poplar S 68° E 71.75'
- Nail & K.C. remon. tag on SW side 20" Wild Cherry S 44° E 33.08'
- Nail & K.C. remon. tag on SW side 13" Wild Cherry S 01° W 18.35'
- Nail & K.C. remon. tag on W side 8" Maple S 19° W 20.61'

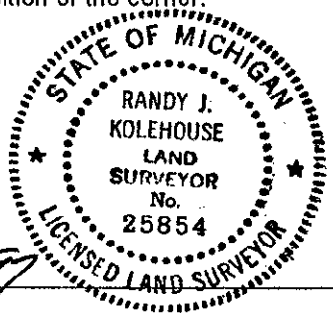

Signed by Randy J. Kolehouse Date 8-1-97  
EARTH TECH

Surveyor's Michigan License No. 25854

P.A. 345 1990 KENT COUNTY  
PEER APPROVED 5/22/97  
CHAIRMAN Harry Huber