

**SURVEY & REMONUMENTATION**

MAR 03 1998

\$7.00  
\$2.00

**SECTION**

**LAND CORNER RECORDATION CERTIFICATE**  
Filing Requirement of Act 74, Mich. P.A. 1970  
KENT COUNTY REMONUMENTATION

For corners in

Kent (County)	Located in:	Ada Township	Corner Code #
1. Public Land Survey	T <u>7N</u>	R <u>10W</u>	<u>F-7</u>
	T _____	R _____	_____
	T _____	R _____	_____
	T _____	R _____	_____
2. Property Controlling in Section	S _____	T _____	R _____
	S _____	T _____	R _____
3. Miscellaneous Property in Sec.	S _____	T _____	R _____
	S _____	T _____	R _____

4. Lot No. \_\_\_\_\_, Recorded Plat \_\_\_\_\_  
5. Private Claims \_\_\_\_\_

STATE OF MICHIGAN  
COUNTY OF KENT  
RECEIVED FOR RECORD  
97 NOV 14 AM 9:01  
REG. OF DEEDS  
*Lucy Bond*

10311

Register of Deeds Stamp & File Number

I, Randy Kolehouse, in a field survey on July 23 19 97, do hereby certify that under requirements of P.A. 74 Michigan P.A. of 1970, the corner points mentioned in lines 1 and 2 above were in conformance with regulations and rules therefore as required in the current manual of survey instructions of the United States Department of the Interior, Bureau of Land Management or by a decree of a Court of Law and/or that the corner points mentioned in lines 3, 4 and 5 above were in conformance with the rules of the Michigan Board of Land Surveyors or by a Decree of a Court of Law; established, re-established, monumented, re-monumented, recovered, found as expressed below:

**NOTE: Not more than 4 corners, all in the same town and range, may be recorded on this certificate.**

**A. Description of original monument and accessories and/or subsequent restoration:**

F-7	1831	G.L.O. Notes	Mullett	Set Post
	1967	Witness Map	K.C. Surveyor	Iron
	1974	L.C.R.C. #1087	Medema, Van Kooten & Assoc.	"T" Iron
	1981	L.C.R.C. #2582	Jonker Land Survey	Fnd. "T" Iron / Set K.C. Monument
	1989	L.C.R.C. #5139	T. Chettleburgh	K.C. Monument

This corner was originally approved by the Kent County Remonumentation Peer Group and monumented by Rob Jonker on 12/23/81 and was recorded per L.C.R.C. #2582.

**B. Description of corner evidence found and/or method applied in restoring or reestablishing corner:**

F-7 Found a Standard Kent County Monument in a tree row running East and West and 9' South of a barbed wire fence running East and West per L.C.R.C.'s #2582 and #5139 as set by Rob Jonker in place of a "T" iron he found which checked L.C.R.C. #1087 and the K.C. Surveyor's records.

L.C.R.C. #2582

- Remon. tag on NE side 16" W. Cherry N32°W 6.63'
- Remon. tag on S side 9" quad. W. Cherry S77°W 6.13'
- Remon. tag on S side tw. 10" W. Cherry N90°E 24.13'
- Remon. tag on SE side 8" Pine N30°E 38.95'
- 1 1/4" pipe 8" above ground WSW 1.75'

L.C.R.C. #5139

- K.C. Remon. Tag & Nail East side 7" Pine N 03° E 34.50'
- K.C. Remon. Tag & Nail Southeast side 9" Pine N 32° E 38.91'
- K.C. Remon. Tag & Nail South side 15" Tw. Wild Cherry N 89° E 24.14'
- 1 1/4" Pipe 8" above ground S 73° W 1.79'
- K.C. Remon. Tag & Nail South side 10" Quad Wild Cherry S75°W 6.13'
- K.C. Remon. Tag & Nail Northeast side 18" Wild Cherry N 31° W 6.63'
- K.C. Remon. Tag & Nail Northeast side 8" Pine N 27° W 31.46'

The selected location is accepted by me and is generally accepted by professional surveyors as the best available evidence of the position of the original corner.

**C. Description of monument for corner and accessories established to perpetuate locating the position of the corner:**

- F-7 Standard Kent County Monument
- Nail & K.C. remon. tag on E side 8" Pine N 03° E 34.50'
  - Nail & K.C. remon. tag on SE side 10" Pine N 32° E 38.91'
  - Nail & K.C. remon. tag on S side 17" Twin Cherry N 89° E 24.14'
  - Nail & K.C. remon. tag on S side 12" Quad Cherry S 75° W 6.13'
  - Nail & K.C. remon. tag on NE side 20" Cherry N 31° W 6.63'
  - Nail & K.C. remon. tag on NE side 10" Pine N 27° W 31.46'

P.A. 345 1990 KENT COUNTY

PEER APPROVED 7/25/97

CHAIRMAN *Randy Kolehouse*

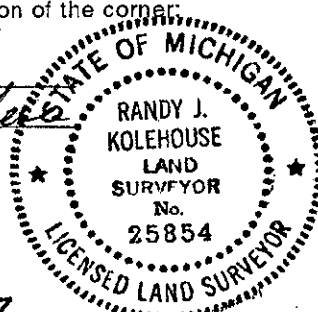

Signed by Randy J. Kolehouse  
EARTH TECH

Date 9/23/97

Surveyor's Michigan License No. 25854

