

FEB 14 1997

COMMISSION

KENT COUNTY REMONUMENTATION

LAND CORNER RECORDATION CERTIFICATE  
Filing Requirement of Act 74, Mich. P.A. 1970

For corners in  
KENT COUNTY  
(County)

Located In:	Corner Code #
T 7N R 10W	F-13
T R	
T R	
T R	
T R	
S T R	
S T R	
S T R	
S T R	

- 1. Public Land Survey
- 2. Property Controlling in Section
- 3. Miscellaneous Property in Sec.

- 4. Lot No. \_\_\_\_\_, Recorded Plat \_\_\_\_\_
- 5. Private Claims \_\_\_\_\_

I, Kirk Breitels, in a field survey on Apr. 9, 1996 do hereby state that under requirements of P.A. 74, Michigan P.A. of 1970, the corner points mentioned in lines 1 and 2 above were in conformance with regulations and rules therefore as required in the current manual of survey instructions of the United States Department of the Interior, Bureau of Land Management or by a decree of a Court of Law and/or that the corner points mentioned in lines 3, 4 and 5 above were in conformance with the rules of the Michigan Board of Land Surveyors or by a Decree of a Court of Law; established, re-established, monumented, recovered, found as expressed below:

NOTE: Not more than 2 corners, all in the same town and range, may be recorded on this certificate.

A. Description of original monument and accessories and/or subsequent restoration:

F-13	1831	GLO	Mullett	Set Post
	1963	Kent Co. Wit.		Iron
	1975	LCRC #820	Bonnema	3/4" Iron
	1981	LCRC #1768	Merdzinski	Set Kent County Monument
	1989	LCRC #5142	Chettleburgh	Kent County Monument

P.A. 345 1990 KENT COUNTY

PEER APPROVED 5/30/96  
CHAIRMAN Harry Thubert

The position of this corner was previously approved by the Kent County Remonumentation Peer Group, monumented by John A. Merdzinski on 1/30/81 and was recorded per LCRC #1768

B. Description of corner evidence found and/or method applied in restoring or reestablishing corner:

F-13 Found Kent Co. Mon. LEANING AND SEPARATED. REMOVED AND RESET per wit. from LCRC #5142 and above LCRC #1768, as set by John A. Merdzinski in place of the Conc. Monument he found. Said Conc. Monument checks with Kent Co. Wit. and LCRC #820  
LCRC #1768 (Nail/tag in trees) LCRC #5142 (Nail/tag in trees)

12" Oak S60°E 24.27'	36" Oak N75°E 44.47'	12" Oak S58°E 24.27'	32" Oak N77°E 44.43'
10" Poplar S05°E 40.67'		10" Poplar S07°E 40.55'	
P. Pole #32 N80°W 76.64'		PP #32 N76°W 76.55'	24" Oak N17°E 16.70'
6" Dogwood N35°E 31.91'		6" Ironwood N40°E 31.93'	
24" Oak N10°E 16.70'		Conc. Mon. (F-1,6-10) N89°W 75.71'	

The selected location is accepted by me and is generally accepted by professional surveyors as the best available evidence of the position of the original corner.

C. Description of monument for corner and accessories established to perpetuate locating the position of the corner:

F-13 Standard Kent County Monument

New Nail & KC Remon. tag NE side 14" Oak	S58°E	24.24'
New Nail & KC Remon. tag E. side 12" Poplar	S07°E	40.55'
Nail & KC Remon. tag S. side P. Pole #32	N76°W	76.73'
New Nail & KC Remon. tag S. side 34" Oak	N77°E	44.37'
Nail & KC Remon. tag SE side 6" Ironwood	N40°E	31.97'
Kent Co. Mon. (F-1, T6N, R10W)	West	75.72'

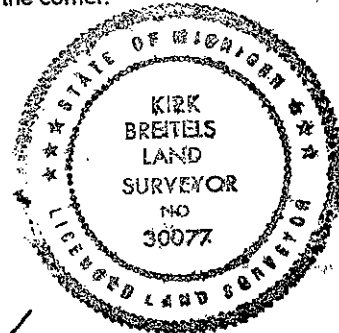

Signed by Kirk Breitels  
Surveyor's Michigan License No. \_\_\_\_\_

Date 4/19/96

STATE OF MICHIGAN  
COUNTY OF KENT  
RECEIVED FOR RECORD  
96 JUN -7 AM 8:29  
REG. OF DEEDS  
*Lucy Grand*

9179

Register of Deeds Stamp & File Number

	A	B	C	D	E	F	G	H	I	J	K	L	M
1													
2	6		5		4		3		2		1		
3													
4	7		8		9		10		11		12		
5													
6	18		17		16		15		14		13		
7													
8	19		20		21		22		23		24		
9													
10	30		29		28		27		26		25		
11													
12	31		32		33		34		35		36		
13													